

Min. of 2" to Bolt  
Center

FSA ANCHOR Fasteners

TO Stud/joist/plate  
8-10dx1 1/2

TO Foundation  
2--RFB#4X6 Anchor Bolt  
& Epoxy

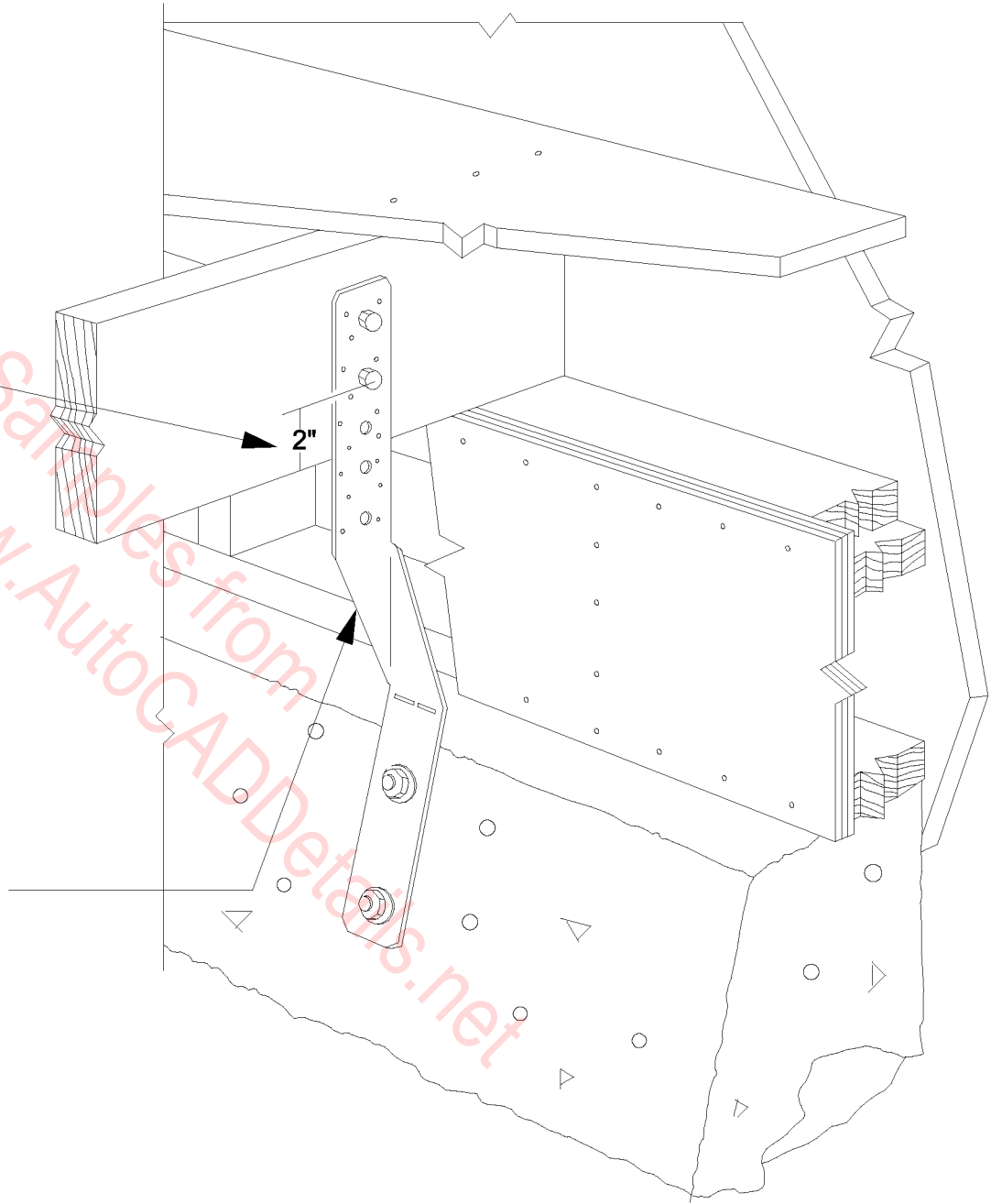

**FOUNDATION TO FLOOR JOIST  
(RETROFIT)**

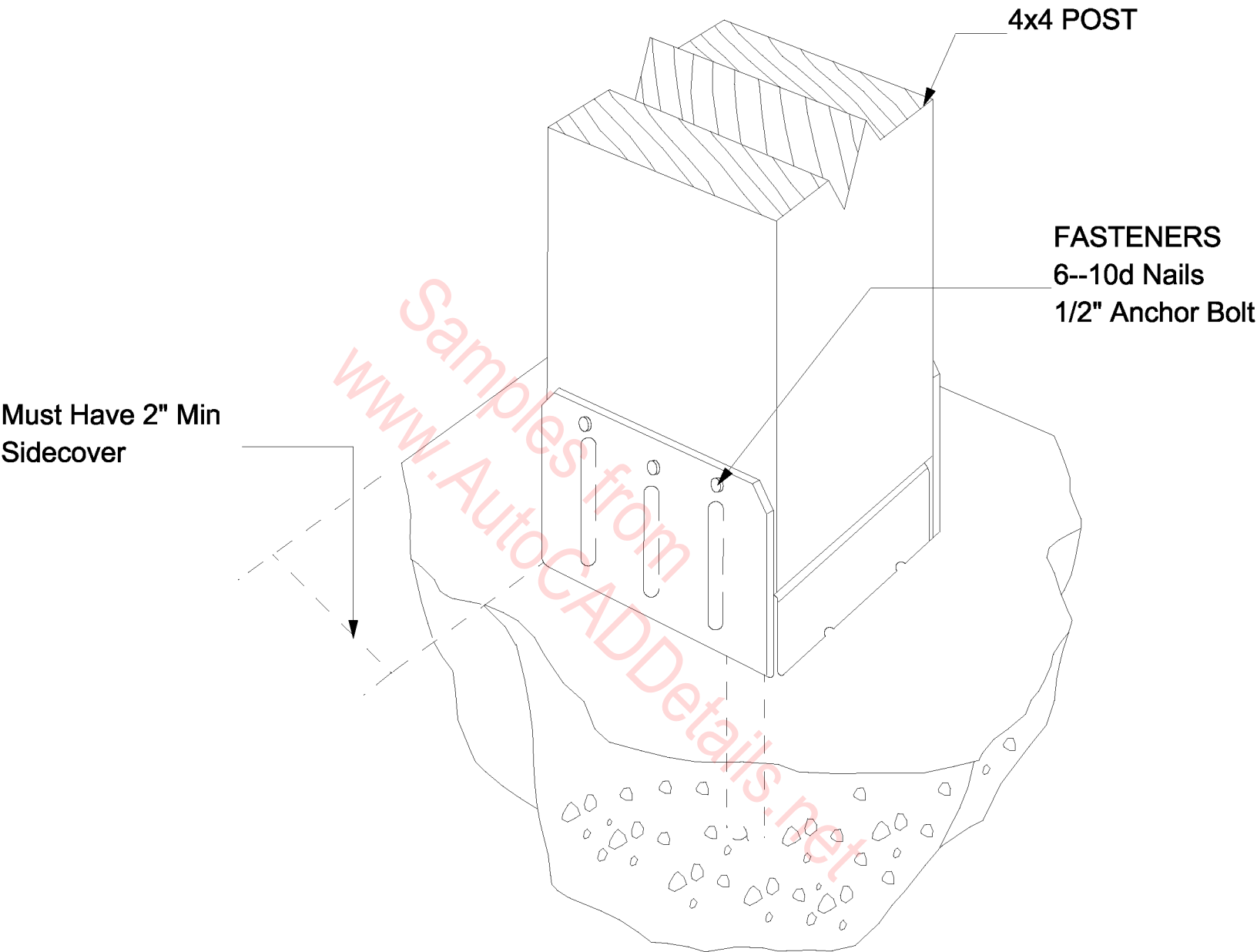

**STANDOFF POST BASE**  
Using Simpson ABE44  
Post Base

See MFG for proper  
fasteners to use in  
Post or Beam

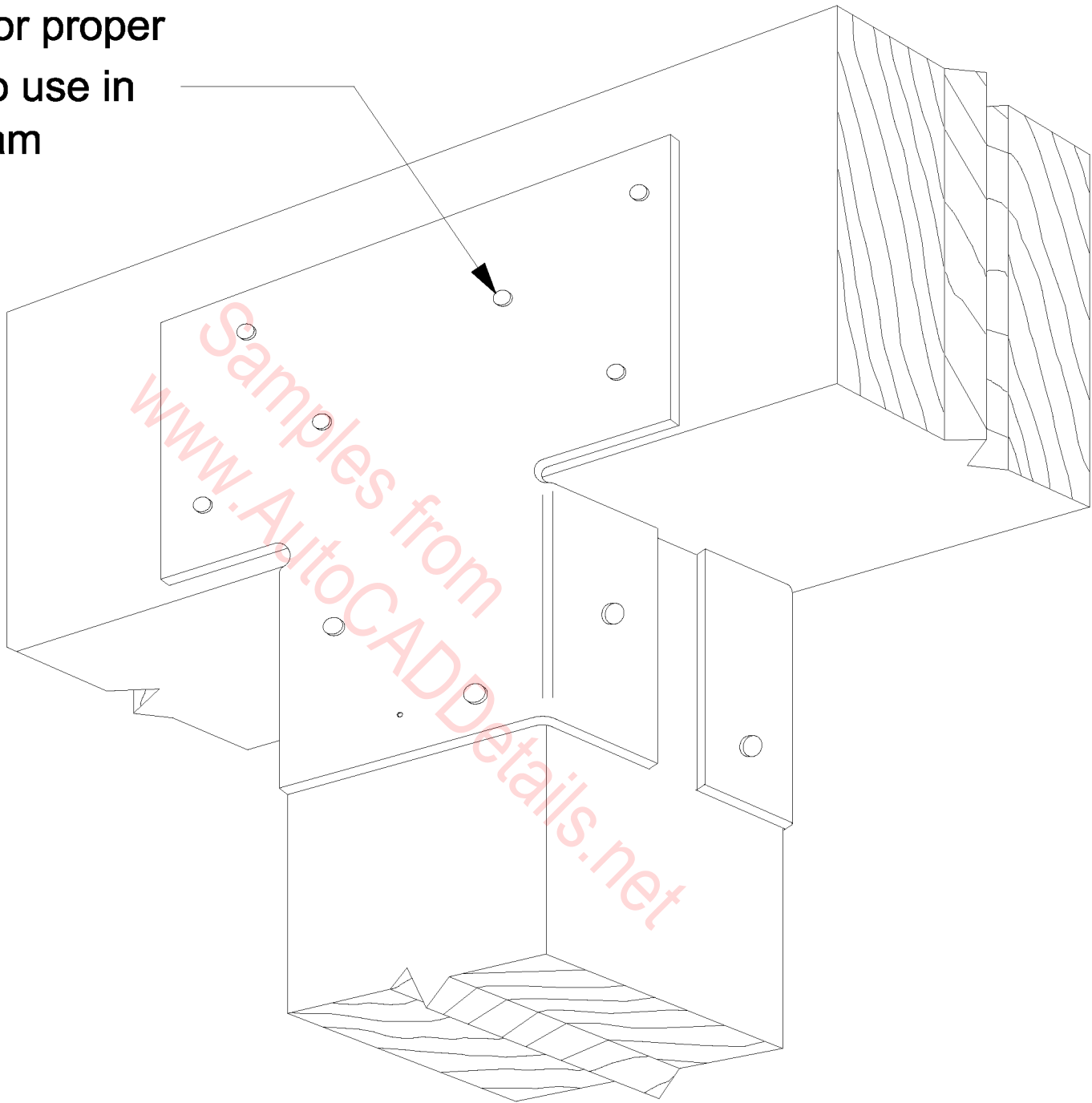

Typical AC Installation

**NOTE:**

See Simpson catalog for fasteners and allowable loads to meet local code requirements.

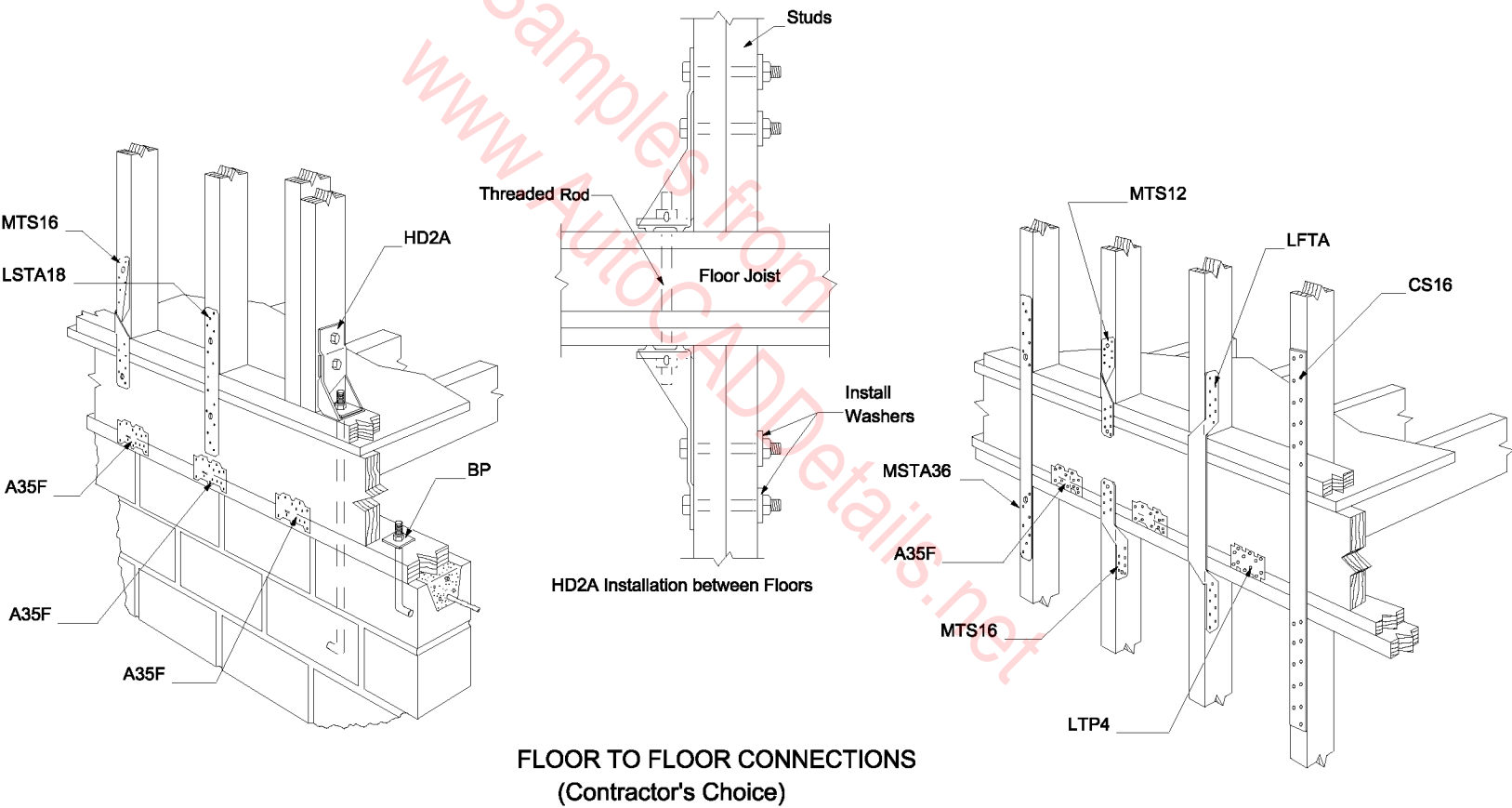

**FLOOR TO FLOOR CONNECTIONS**  
(Contractor's Choice)

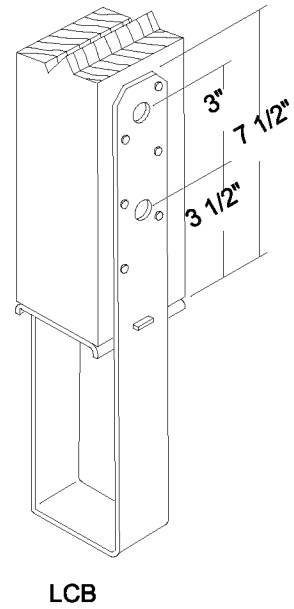
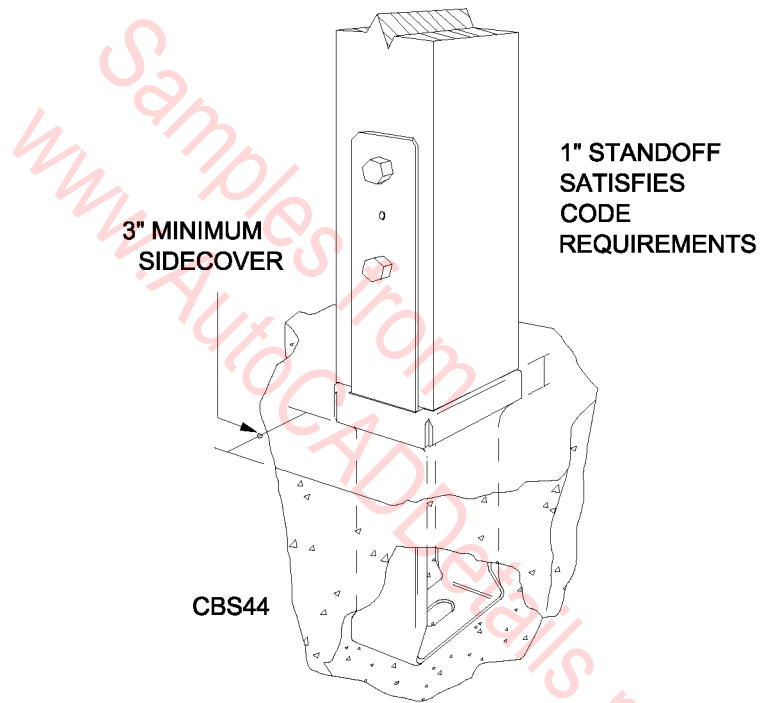
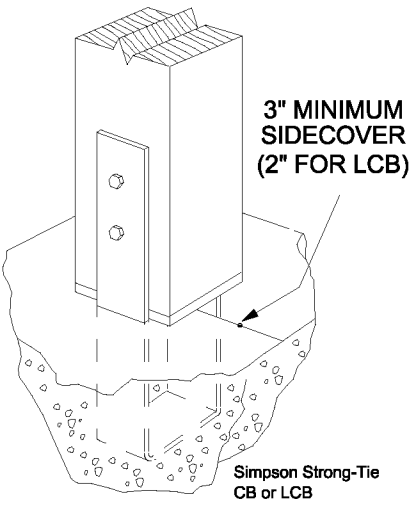

**COLUMN BASES  
(Contractor's Choice)**

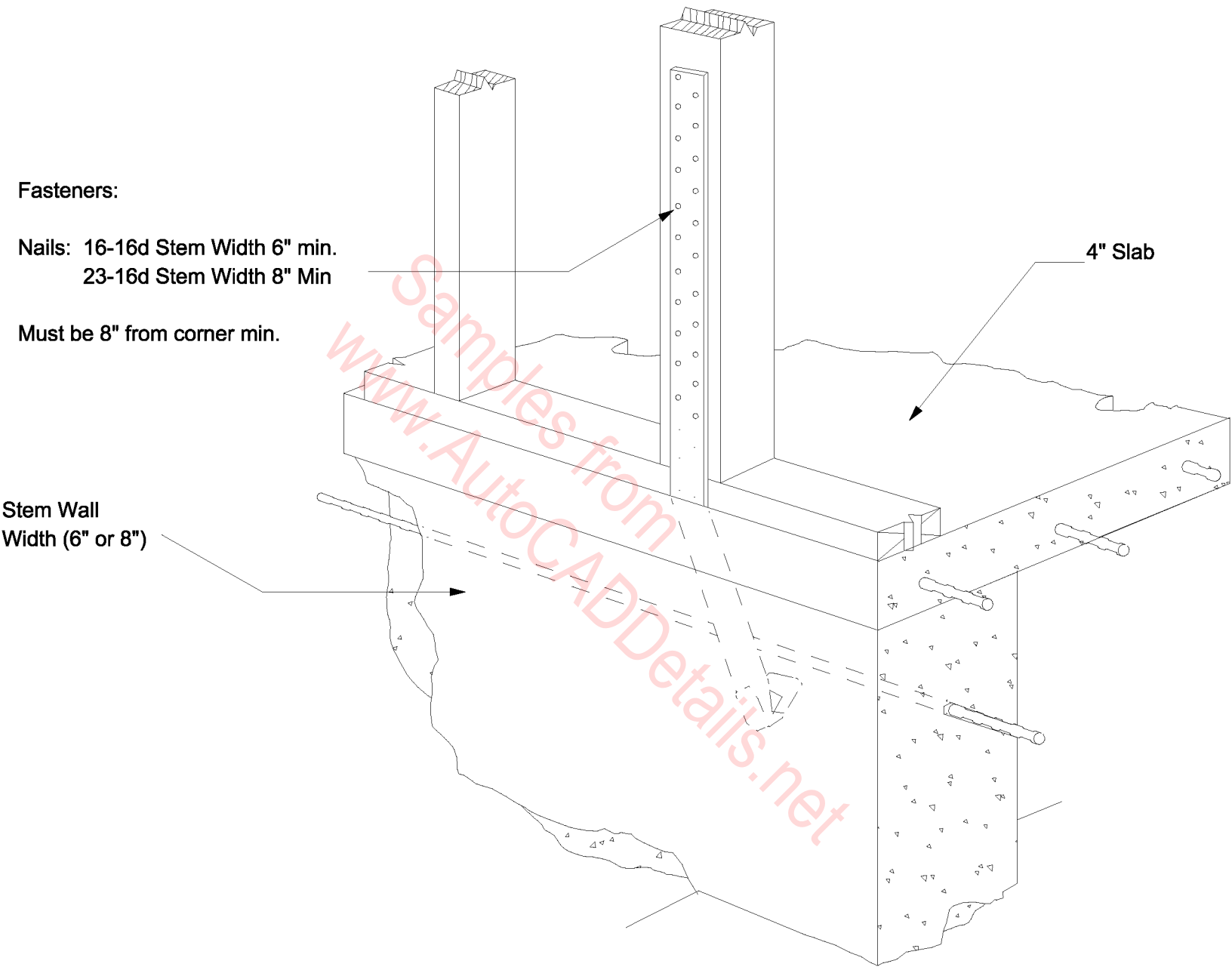

Typ. Double Pour Edge Holdown Installation  
HPAHD22-2P Series

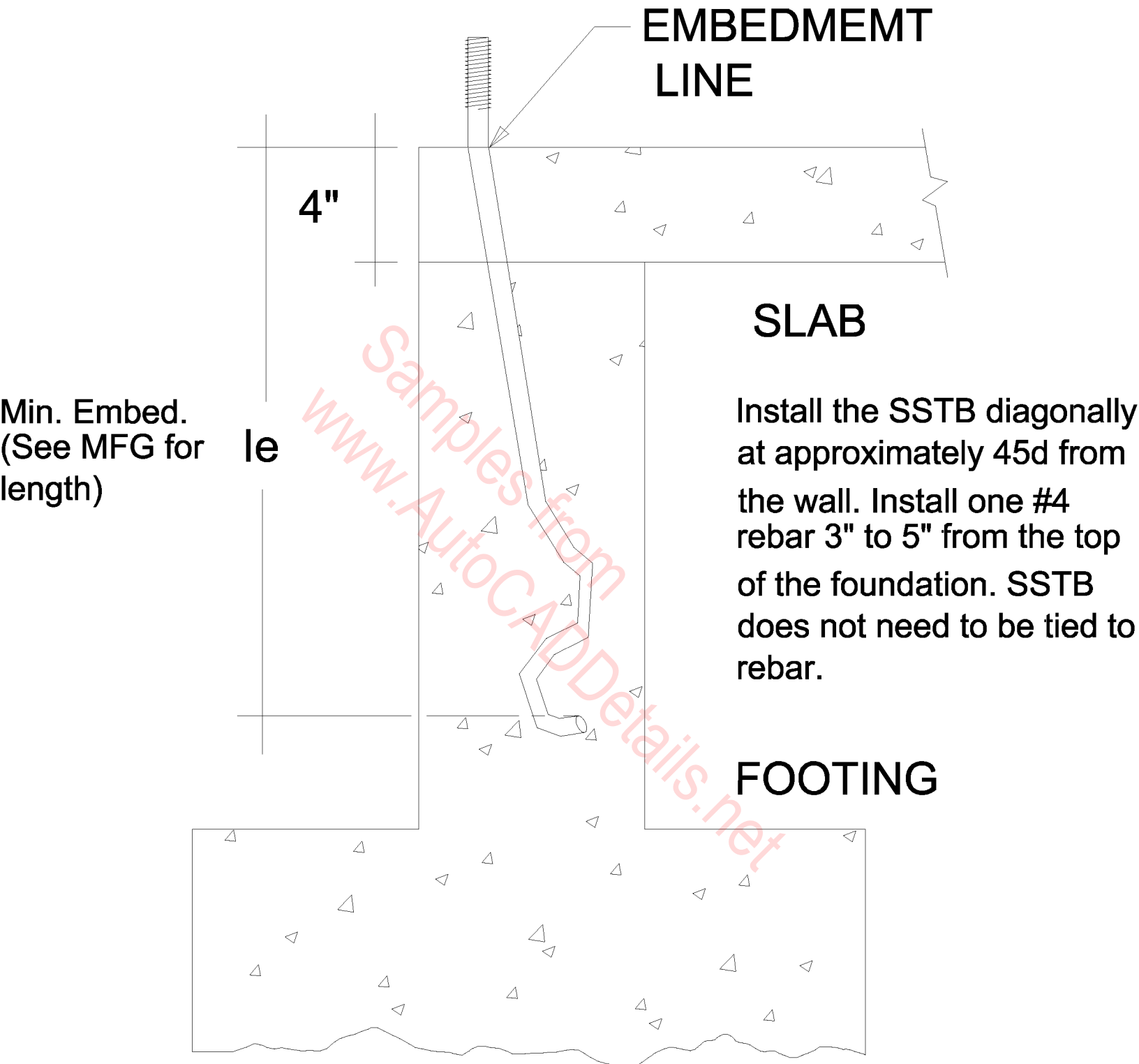

**Double Pour Installation  
(SSTB20, 24 and 34)**

**NOTE:**

See Simpson for correct attachments and loads for your local area to meet code requirements.

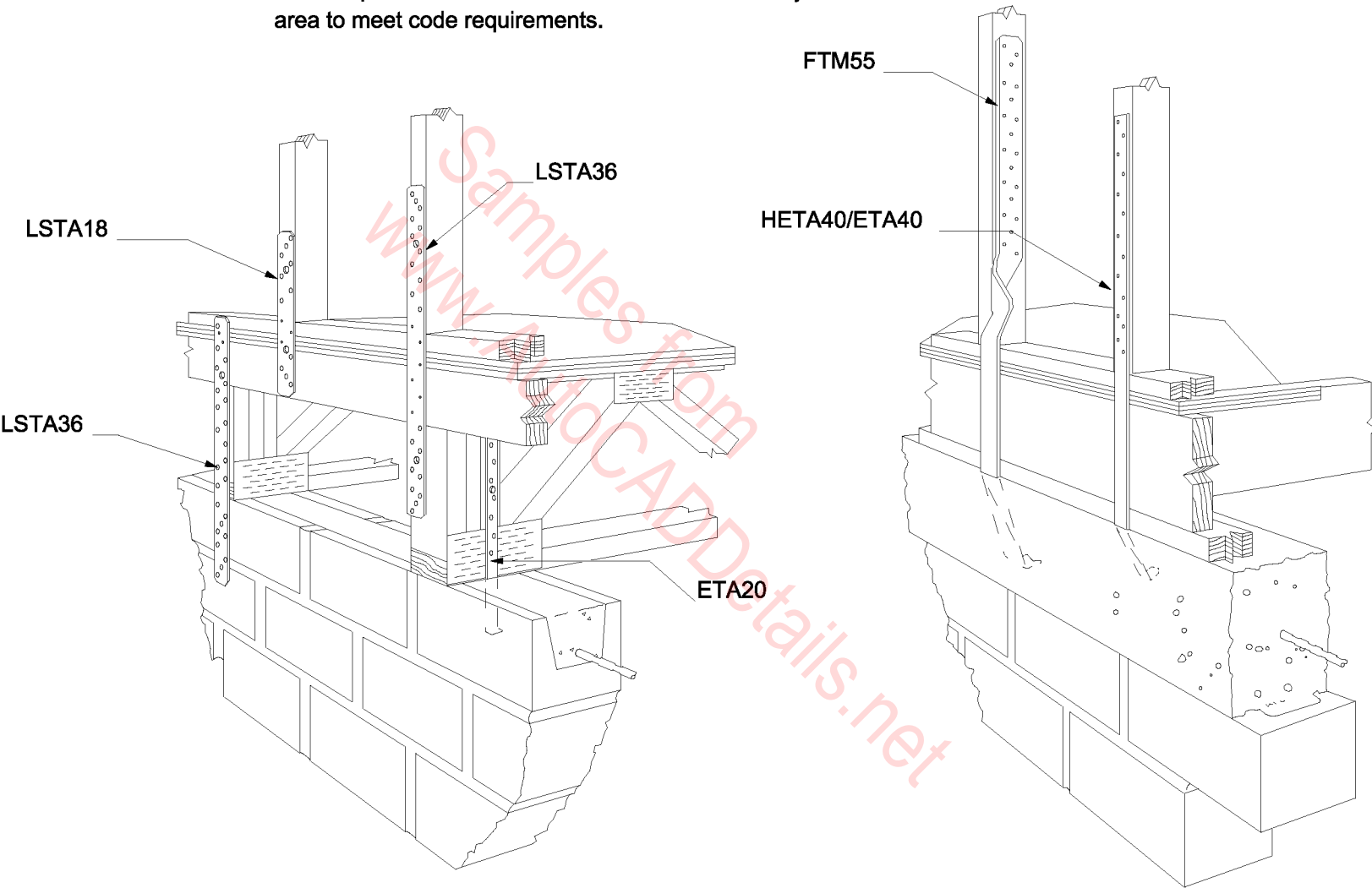

**FLOOR TO FLOOR CONNECTION  
(Contractor's Choice)**



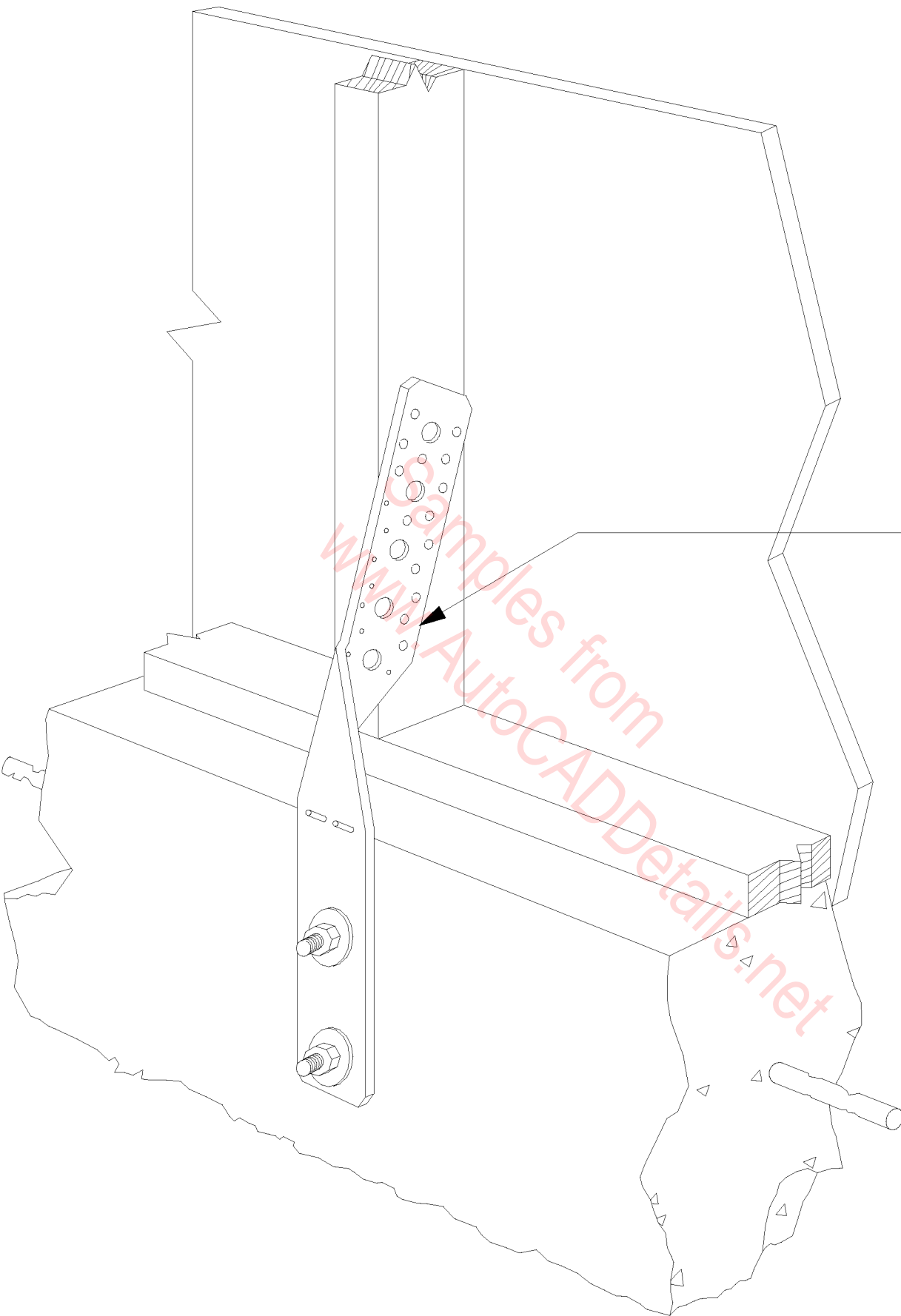

**Fasteners**

**2--1/2" Anchor Bolts**

**8--10d x 1 1/2" Nails**

**2--1/2" MB**

**Typ. FSA Installation  
Foundation to stud**

**NOTE:**

Use Simpson catalog for correct fasteners and allowable loads to meet your code requirements.

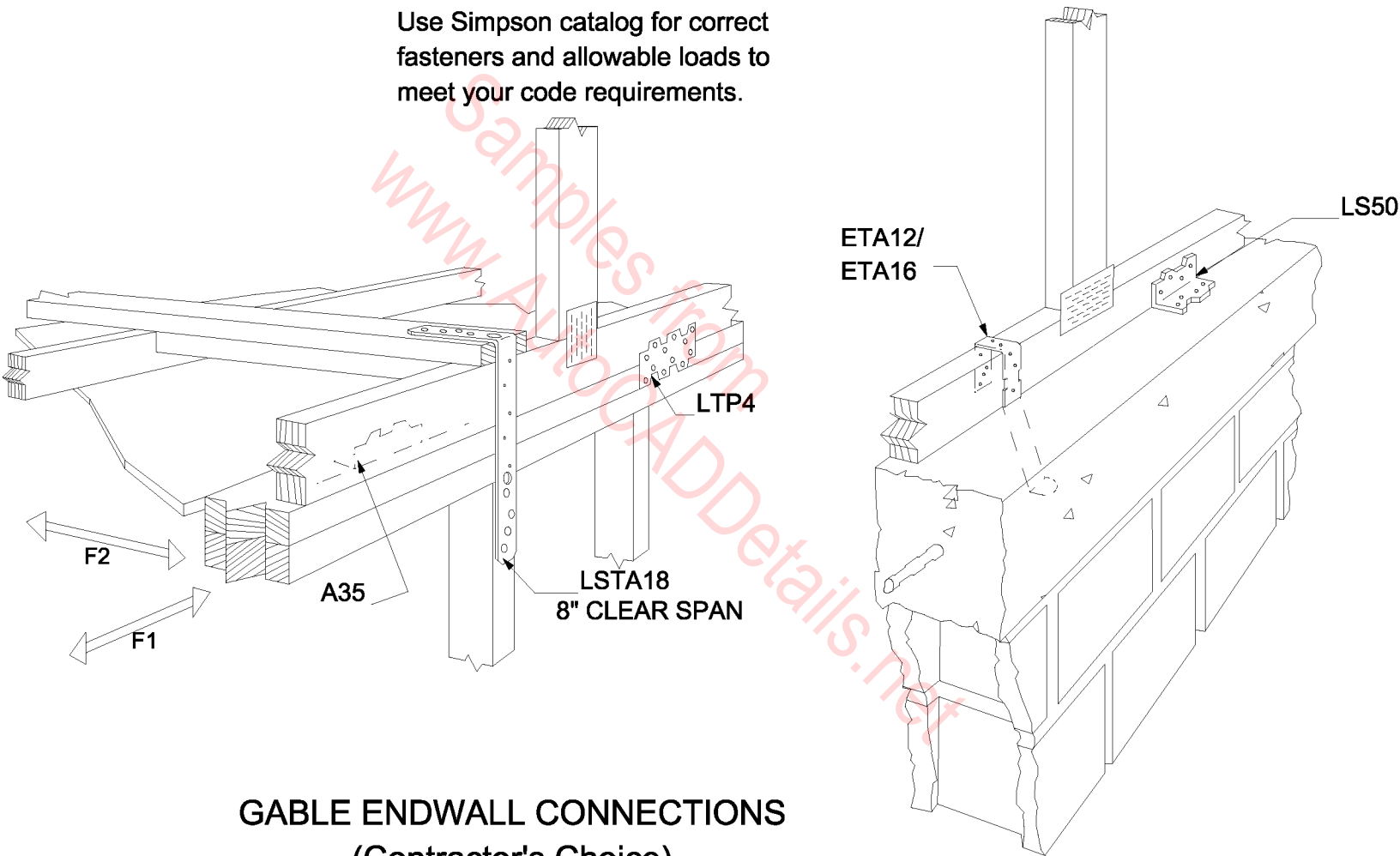

**GABLE ENDWALL CONNECTIONS  
(Contractor's Choice)**

**NOTE:**

Spalling may occur if the anchor is bent horizontally 90 deg. before installation, and then bent up vertically to attach to the stud. Load reduction may apply.

**Fasteners:**

Nails: 9-16d Min Stem Width 6"  
11-16d Min Stem Width 8"

Corner distance  
from edge of  
strap to corner  
1/2" min.

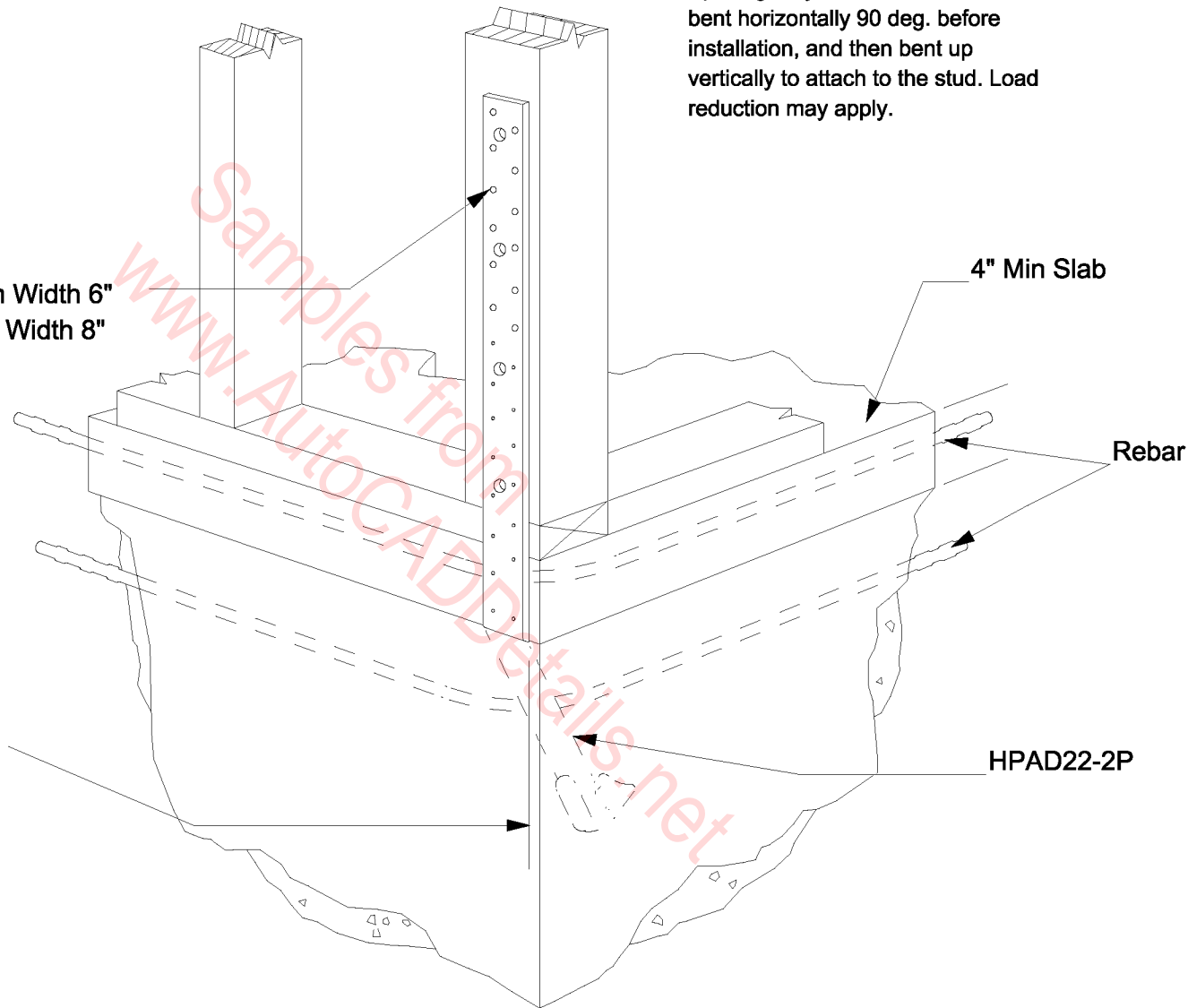

**Typ. Double Pour Corner Holdown Installation  
HPAHD**

Fasteners:

Nails: 16-16d Stem Width 6" min.  
23-16d Stem Width 8" Min

Must be 8" from corner min.

Stem Wall Width  
(6" or 8")

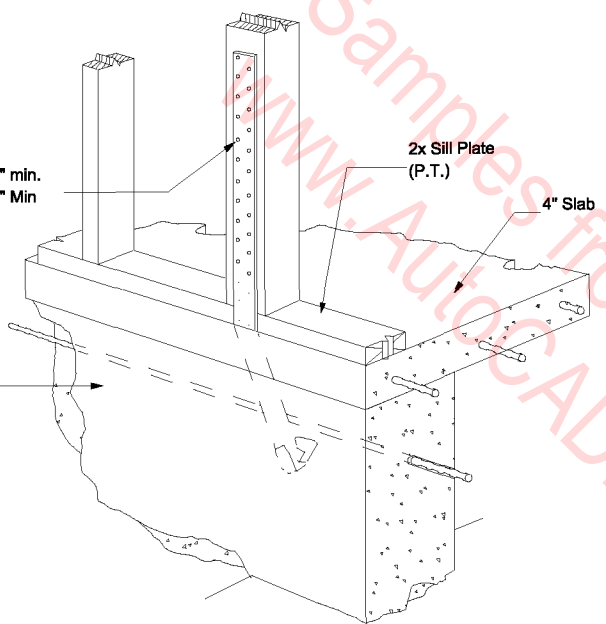

Typ. Double Pour Edge Holdown Installation  
HPAHD22

Fasteners:

Nails: 9-16d Min Stem Width 6"  
11-16d Min Stem Width 8"

Corner distance from  
edge of strap to  
corner 1/2" min.

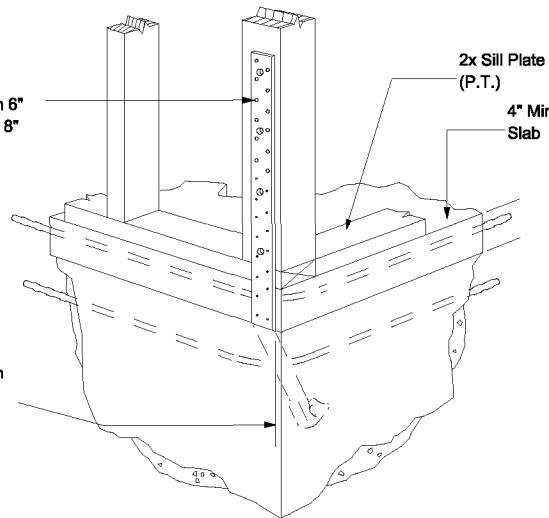

Typ. Double Pour Corner Holdown Installation  
HPAHD

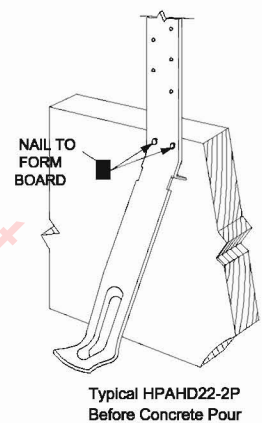
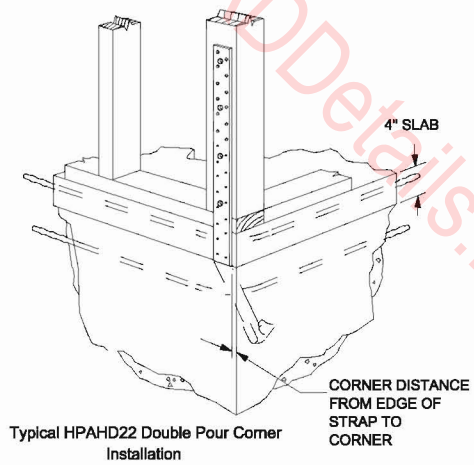
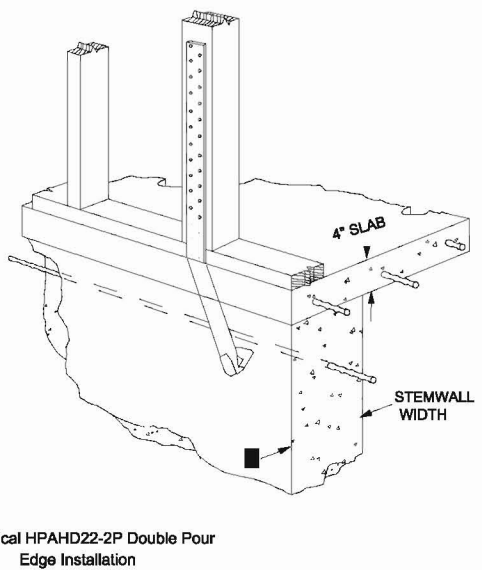
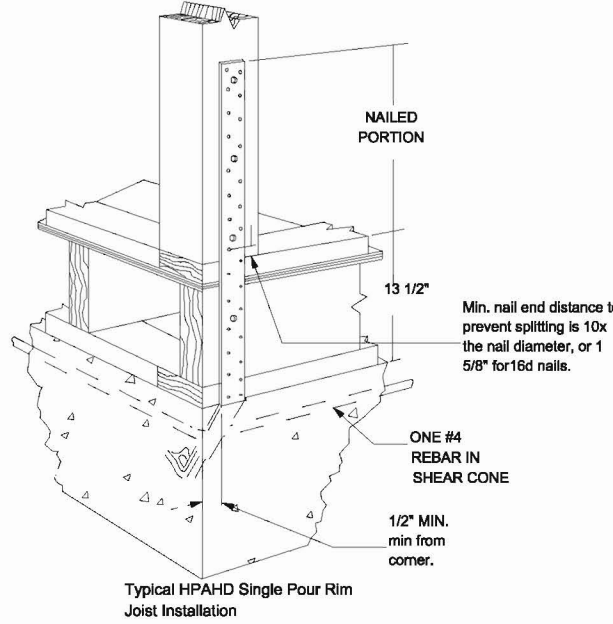
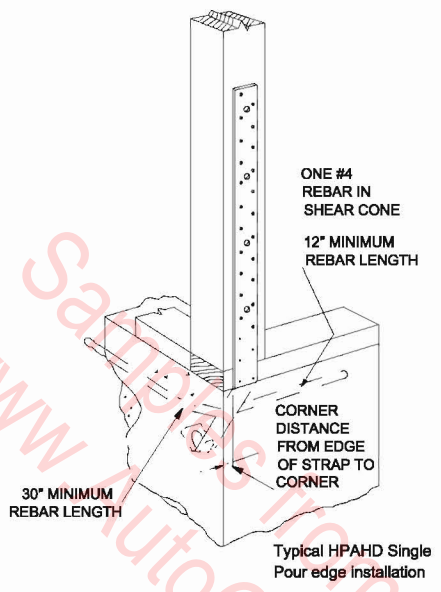
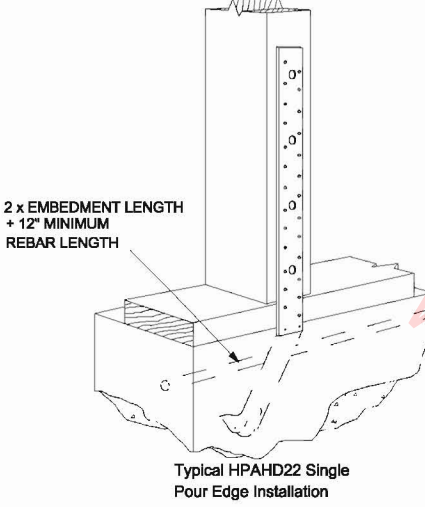

**WOOD TO CONCRETE HOLDOWNS  
HPAHD SERIES--(Contractor's Choice)**

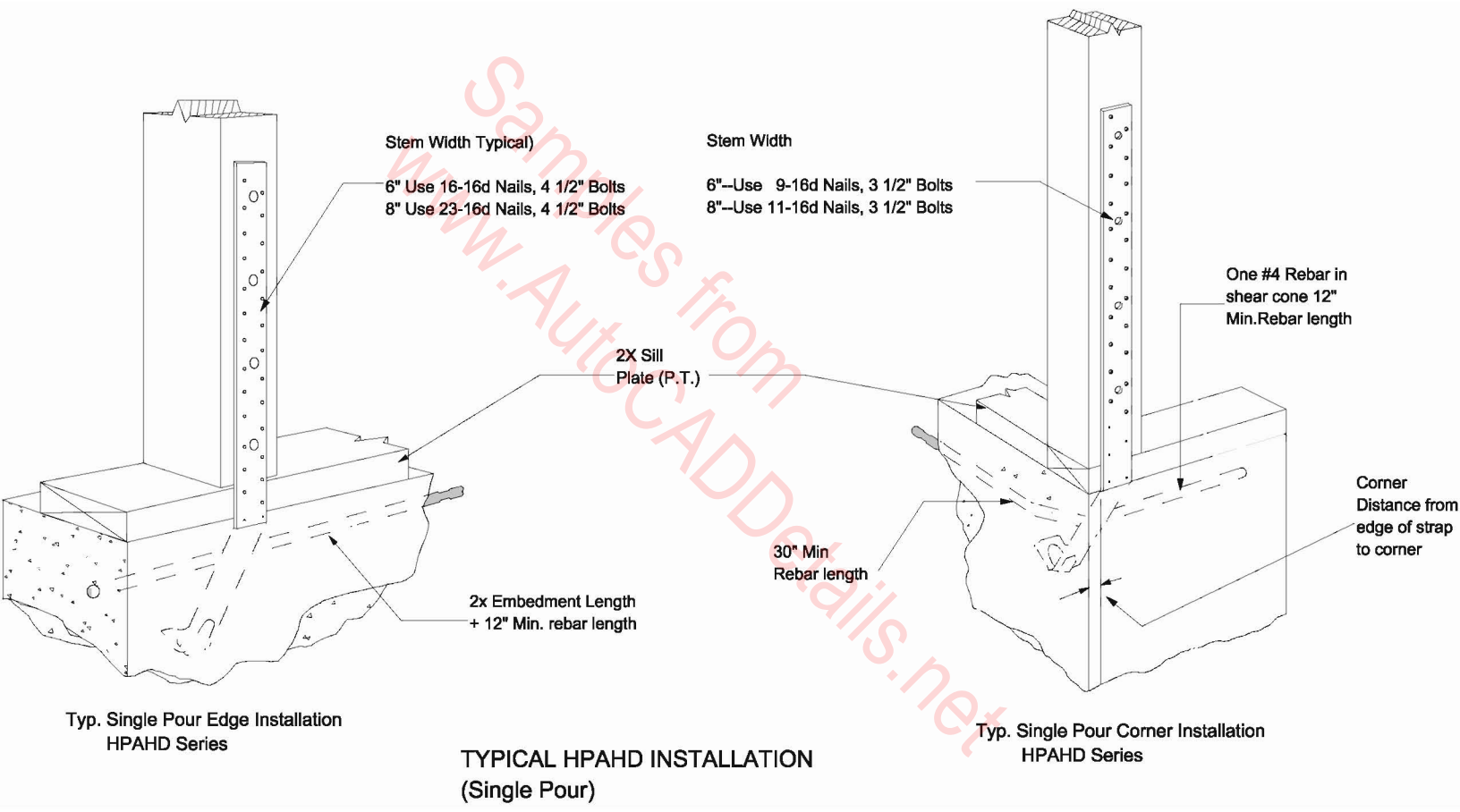

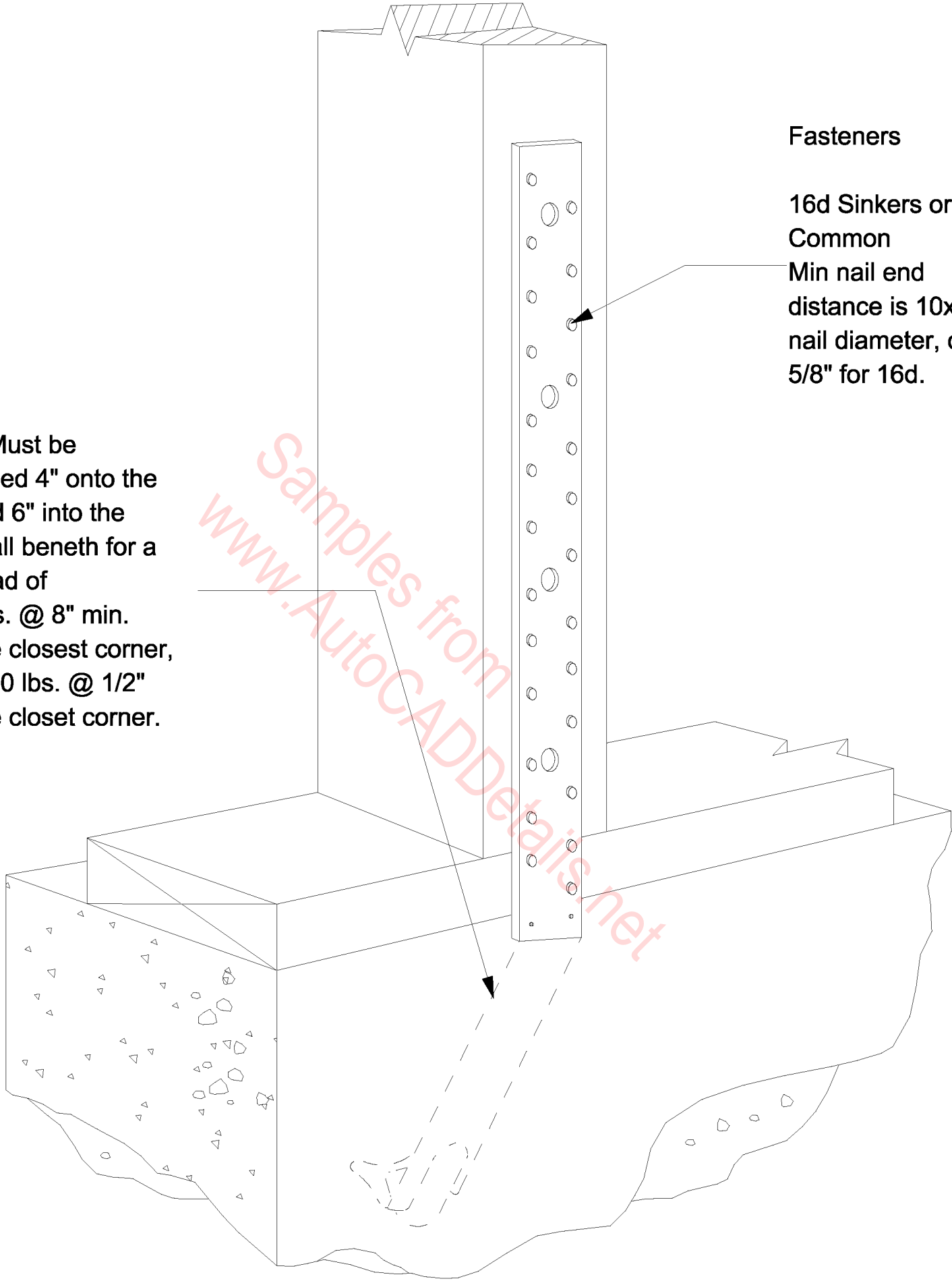

Fasteners

16d Sinkers or 10d Common

Min nail end distance is 10x the nail diameter, or 1 5/8" for 16d.

NOTE: Must be embedded 4" onto the slab and 6" into the stem wall beneath for a max. load of 2810 lbs. @ 8" min. from the closet corner, and 1400 lbs. @ 1/2" from the closet corner.

TYPICAL HOLDOWN  
HPAHD22

**Fasteners:**

Nails: 7-16d Stem Width 6" min.  
9-16d Stem Width 6" min.

Bolts: 3 1/2"

Nails: 10-16d Stem Width 8" min.  
11-16d Stem Width 8" min.

Bolts: 3 1/2"

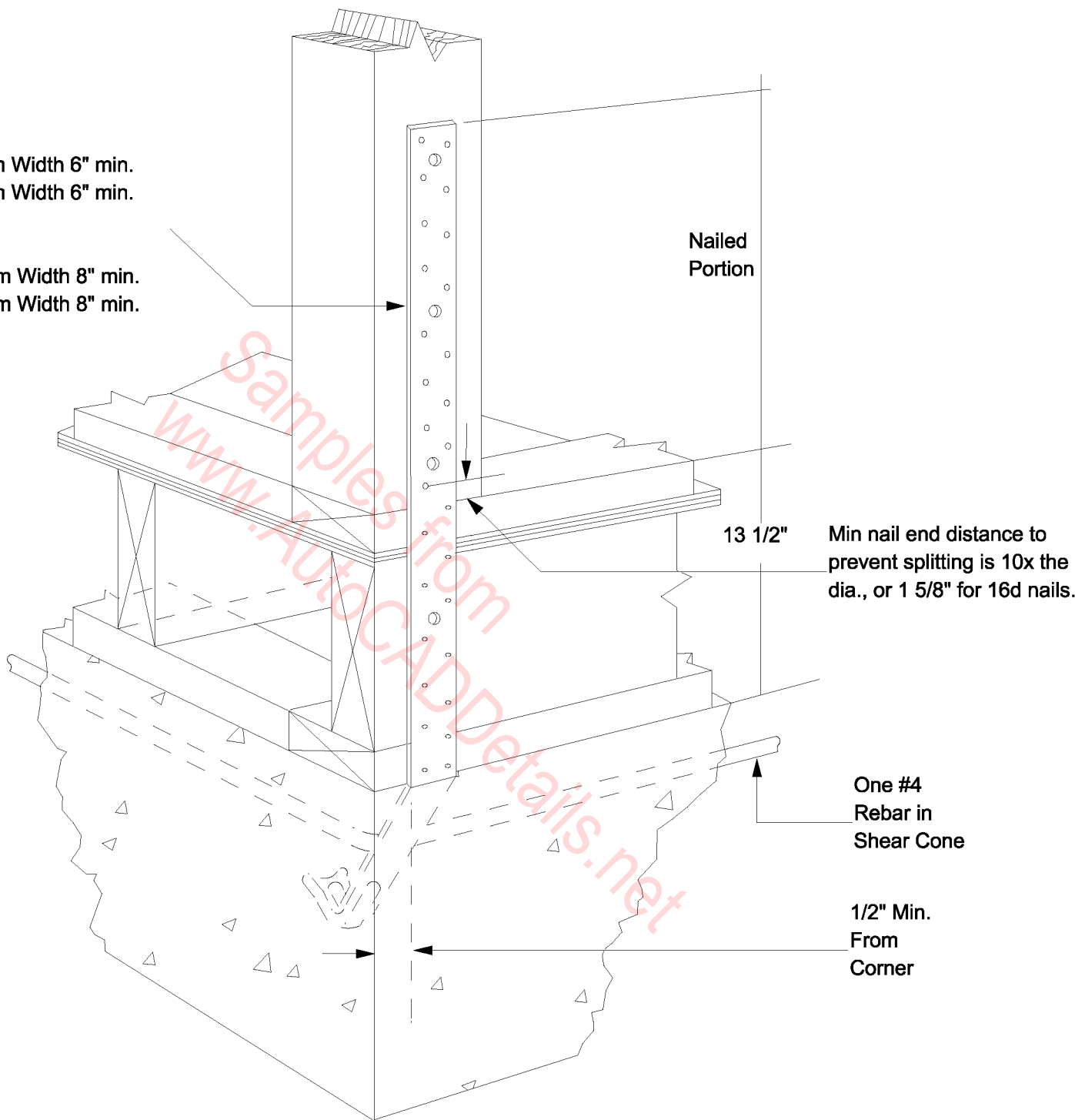

**Typ. Single Pour Rim Joist Installation  
HPAHD Series Holddown**



**NAIL TO  
FORM  
BOARD**

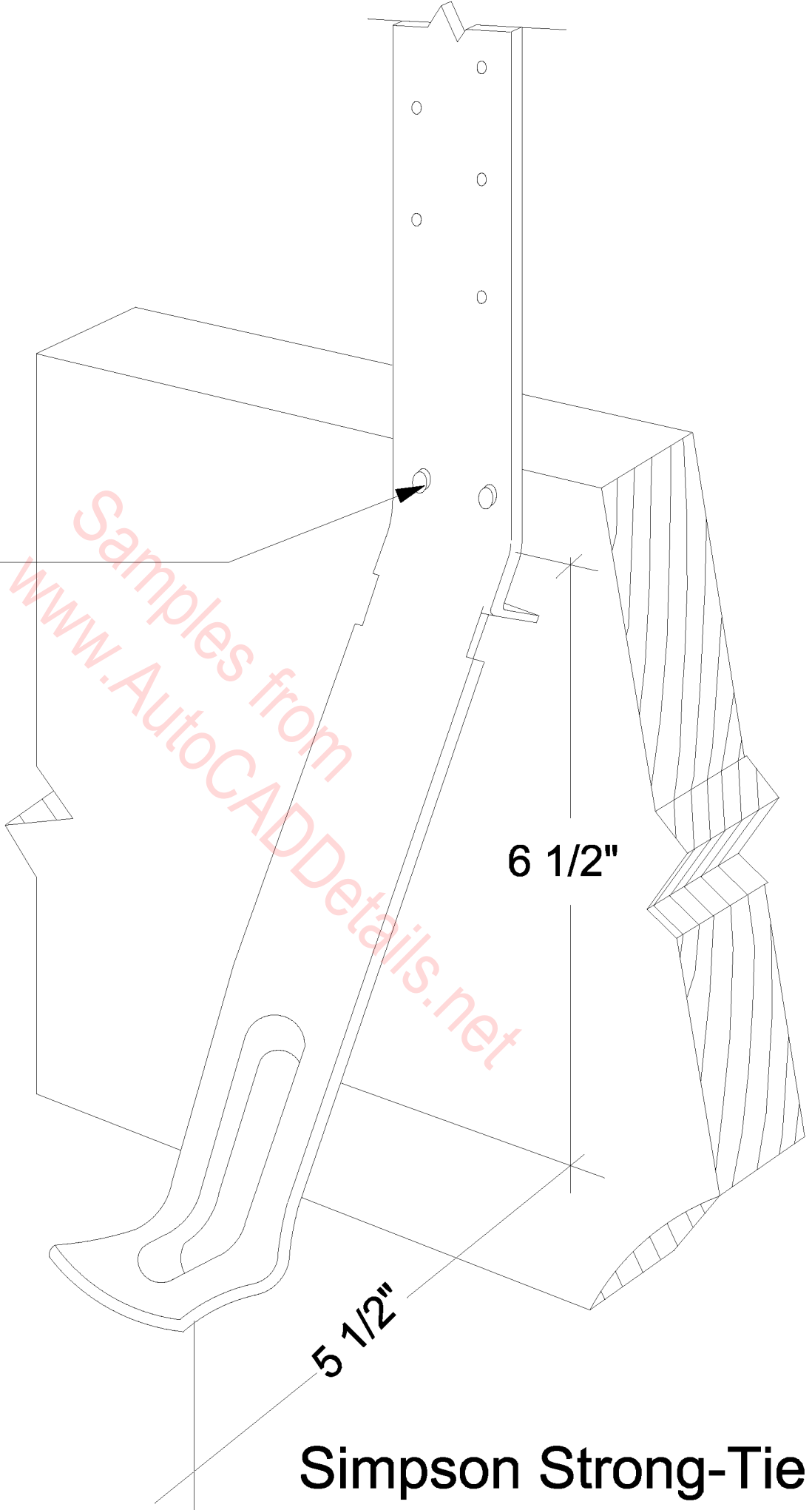

**6 1/2"**

**5 1/2"**

**Simpson Strong-Tie  
HPAHD22-2P**

Note: HTT22 can have a MAX. offset of 2" from the stud face to the centerline of the anchor bolt.

Use the specified number and type of nails to attach the strap portion to the bottom or side of purlin or beam. Bolt the base to the wall or foundation with suitable anchor.

32-16d Sinkers ( 16d sinkers or 10d common may be substituted for the specified 16d.

Anchor Bolt ---5/8"

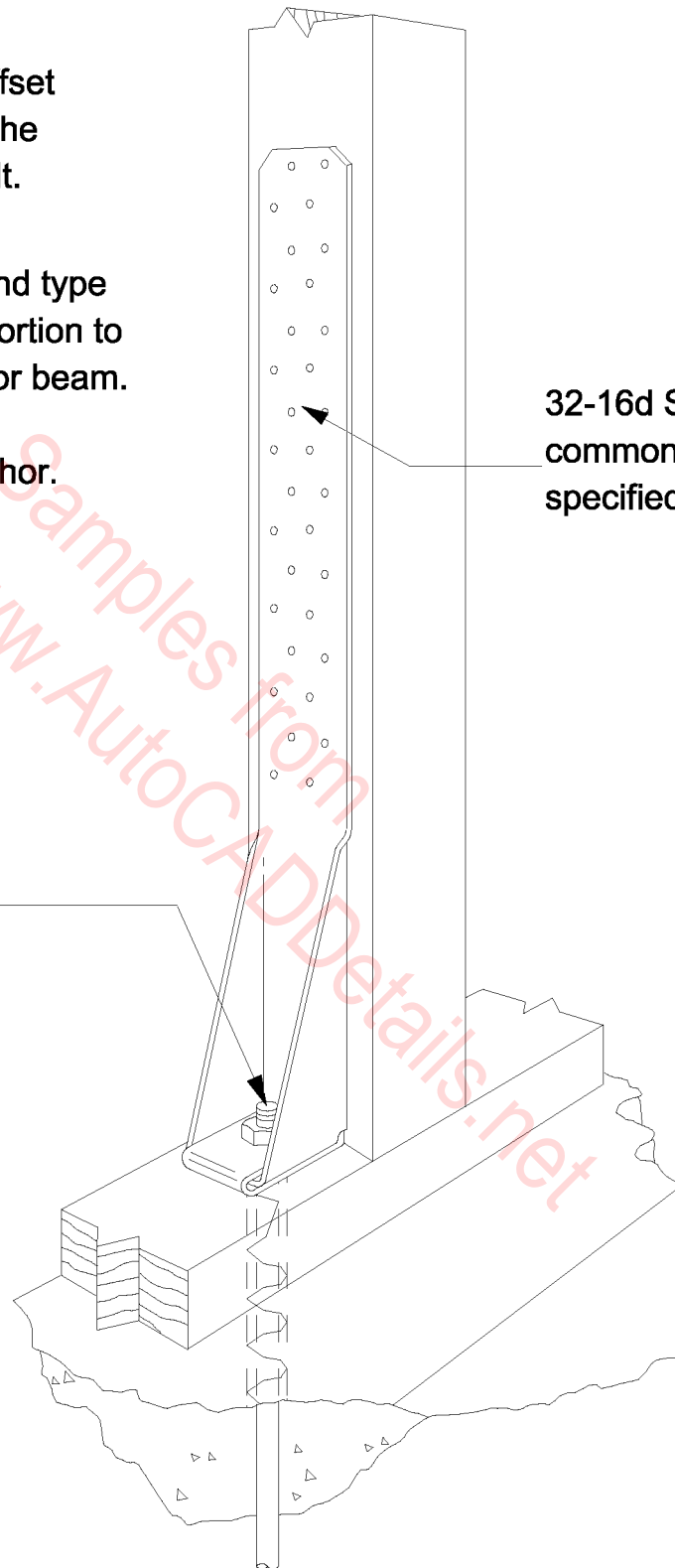

Typical HTT22 as a Holdown by Simpson

NOTE: See Simpson catalog for proper fasteners and allowable loads to meet your code requirements.

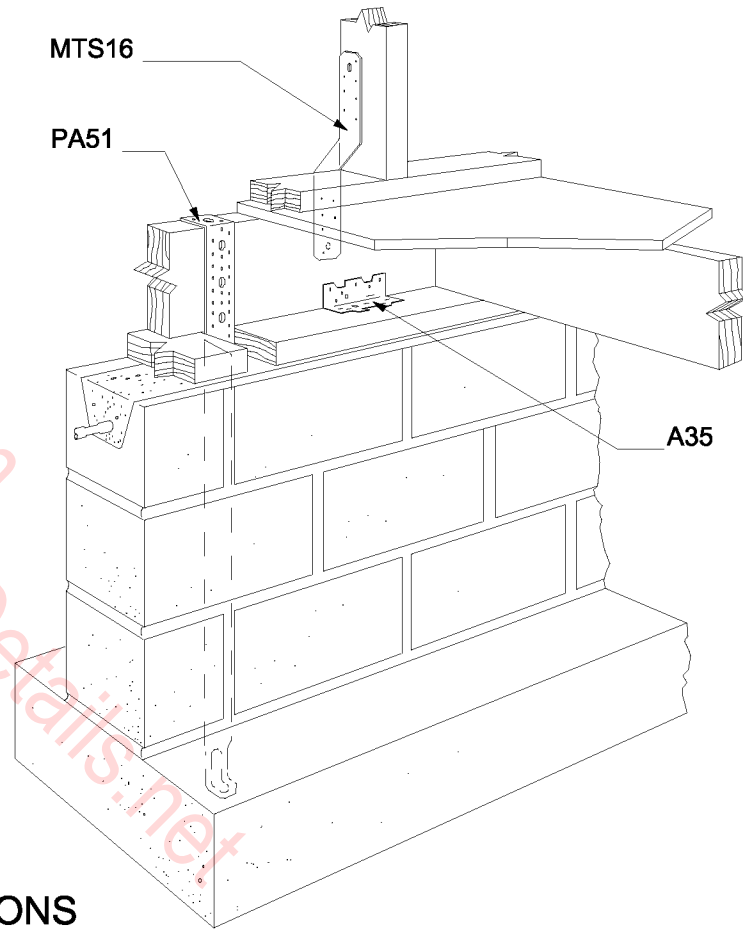
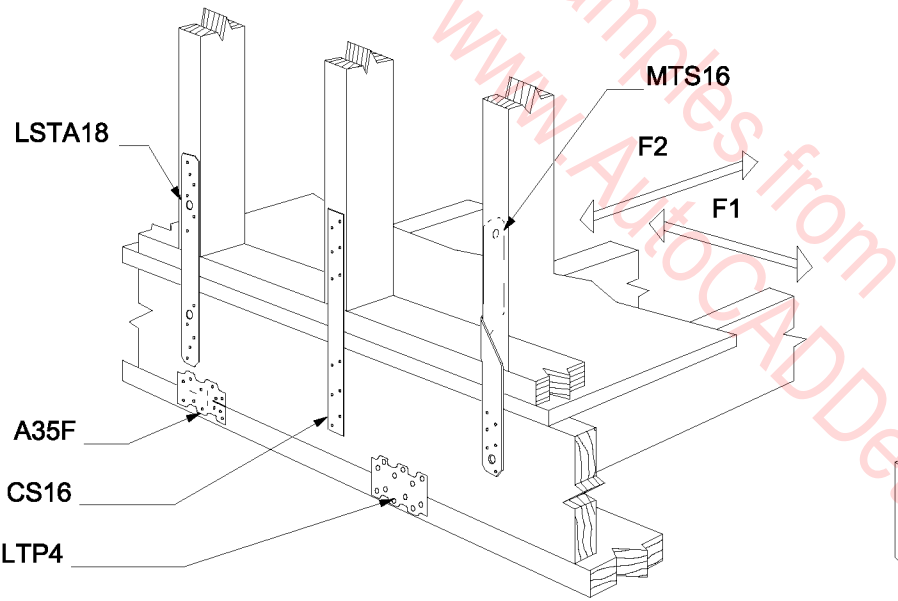

**LATERAL LOAD CONNECTIONS**  
**(Contractor's Choice)**

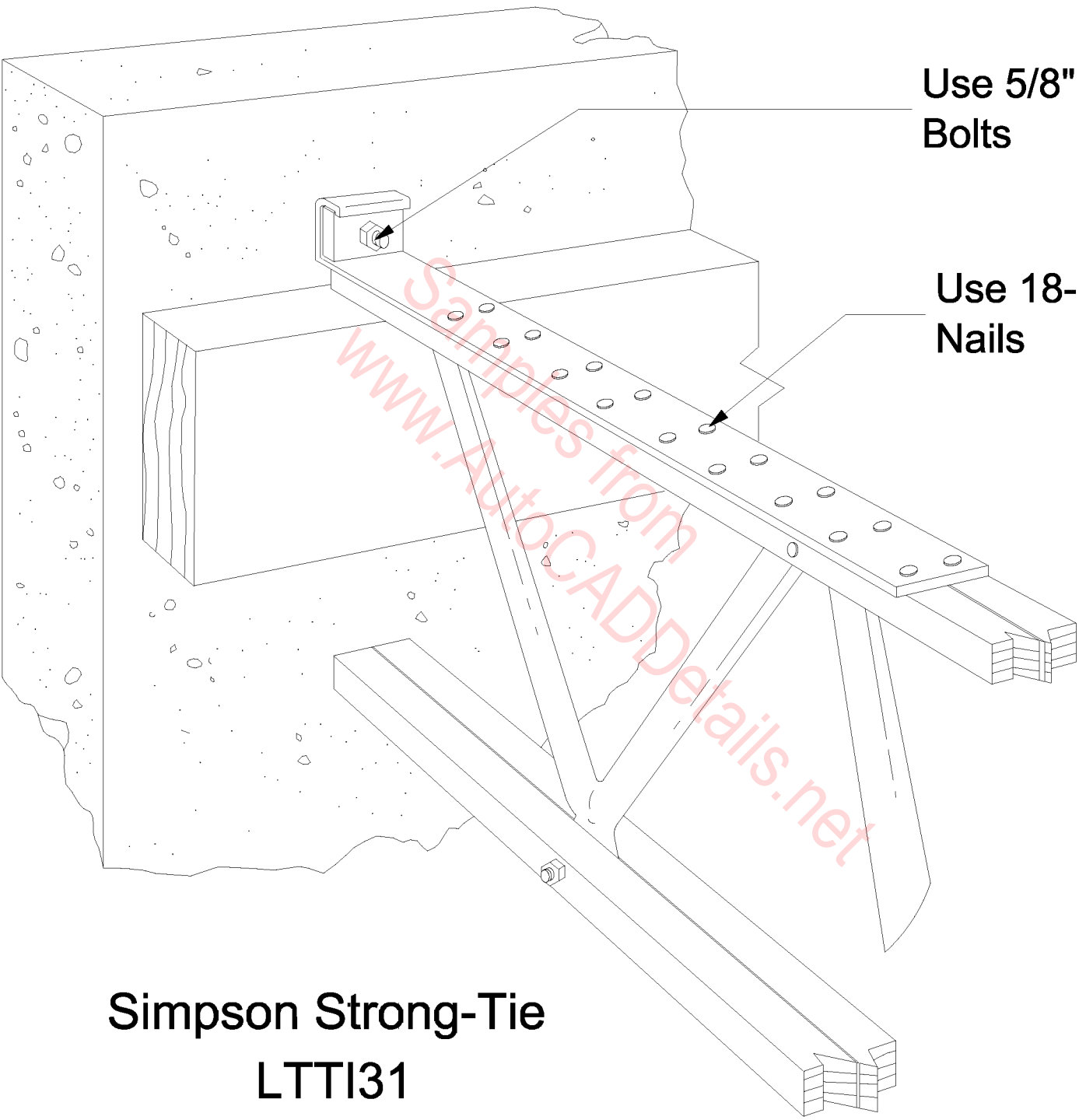

Use 5/8" Anchor Bolts

Use 18-10dx1 1/2" Nails

**Simpson Strong-Tie  
LTTI31**

**LTT19 Use 3/4" Anchor Bolts, 8-16d Sinkers.**

**LTT20B Use 1/2", 5/8", 3/4" Anchor Bolts, 10-16d Nails.**

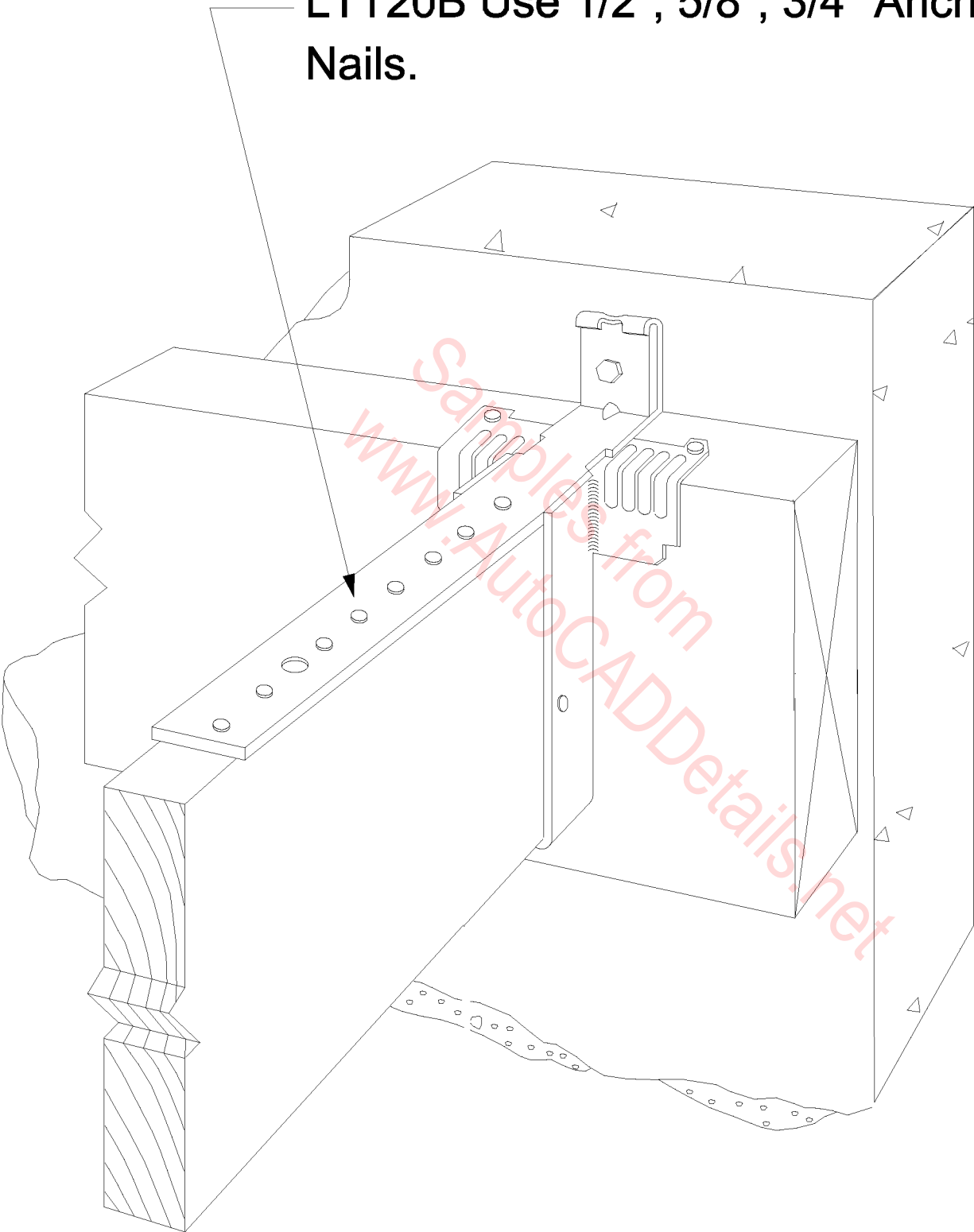

**LTT19 Installation (LTT20B similar)**

**Simpson Strong-Tie**

**FOR INSTALLATION EASE,  
NAIL ONE DUPLEX NAIL INTO  
SIDE FORM BOARD**

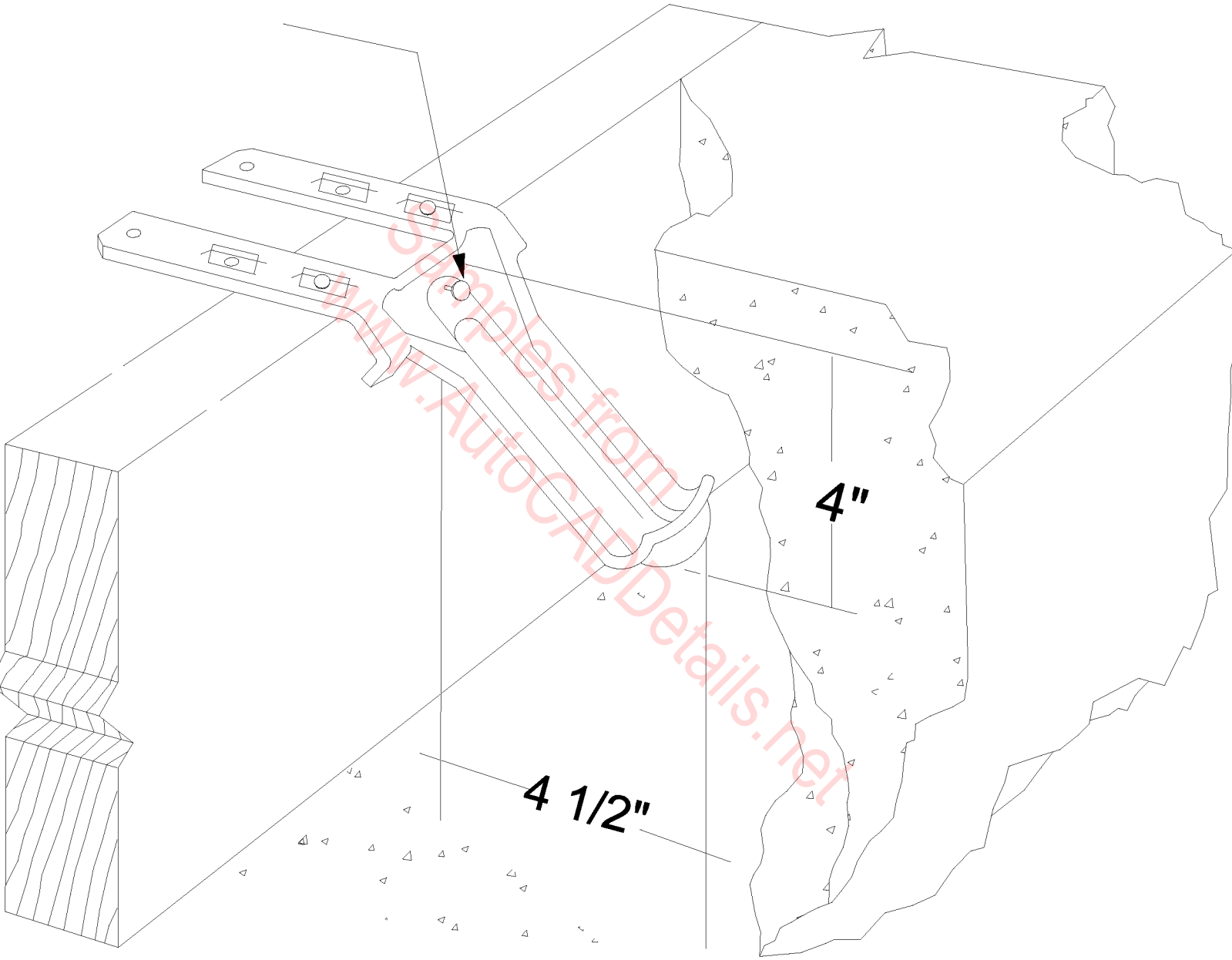

**Mudsill Anchor Singleside  
Installation Cut-away  
(Typical)MAS**

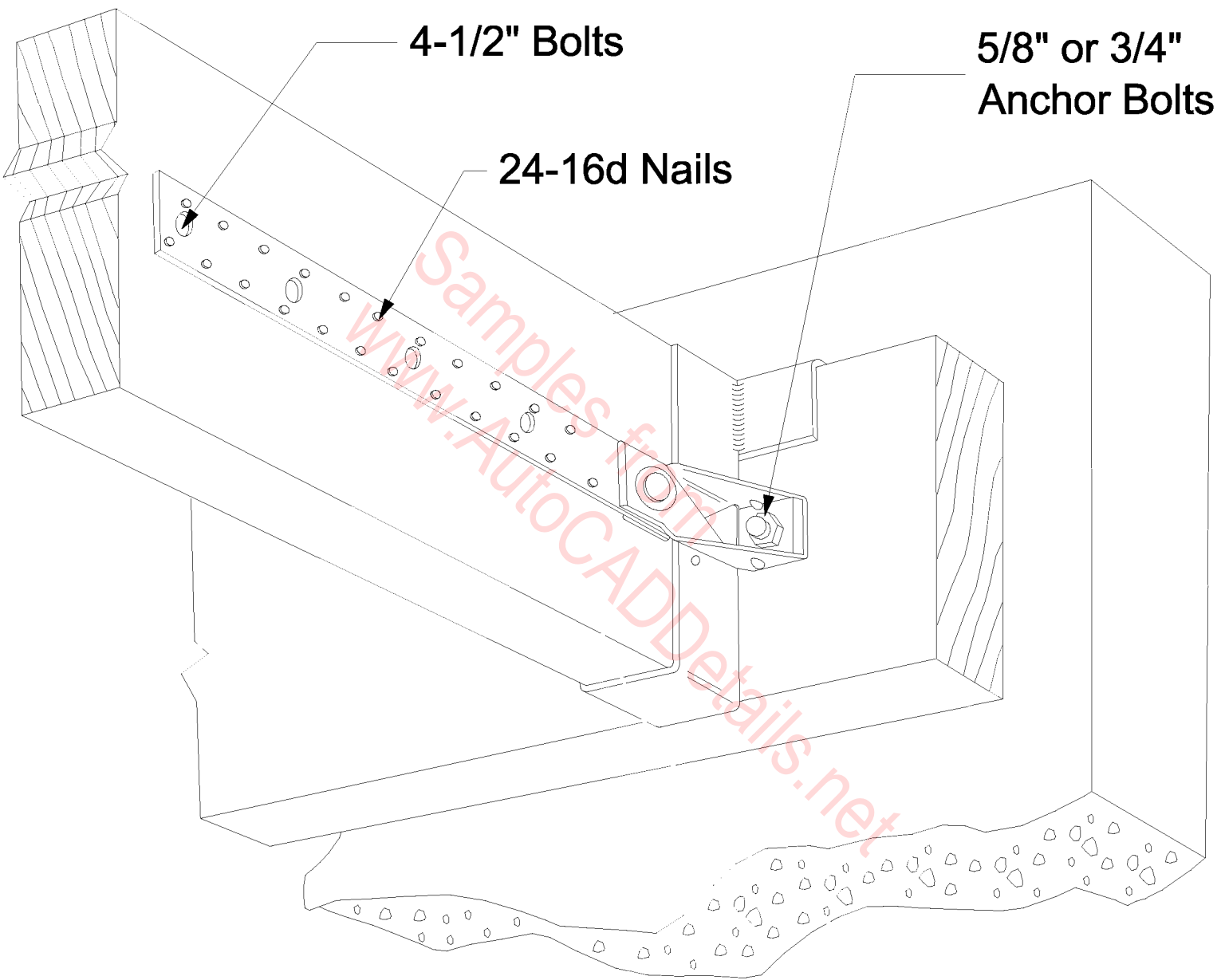

4-1/2" Bolts

5/8" or 3/4"  
Anchor Bolts

24-16d Nails

**MTT28B**  
**Simpson Strong-Tie**

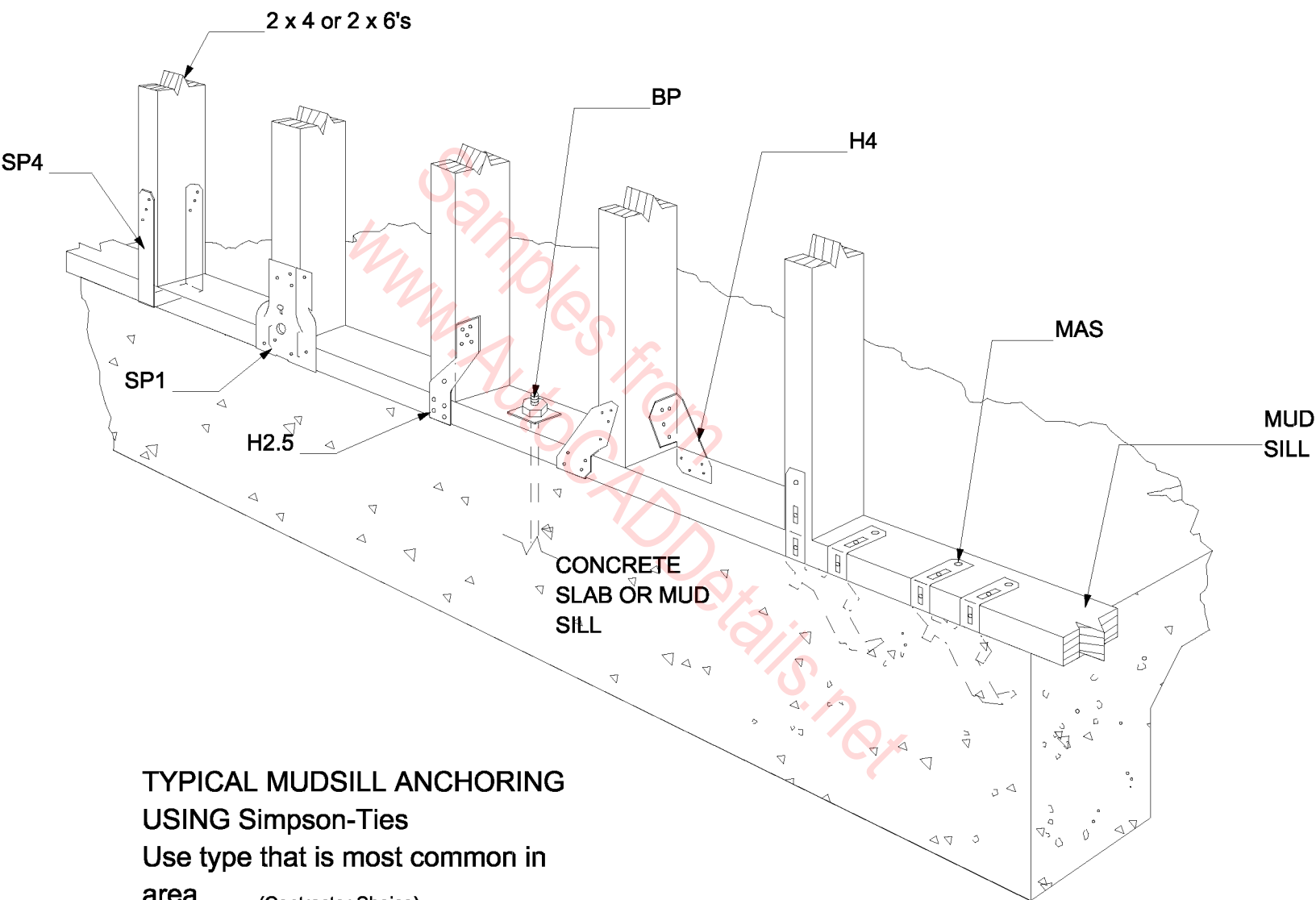

**TYPICAL MUDSILL ANCHORING  
USING Simpson-Ties**  
Use type that is most common in  
area. (Contractor Choice)



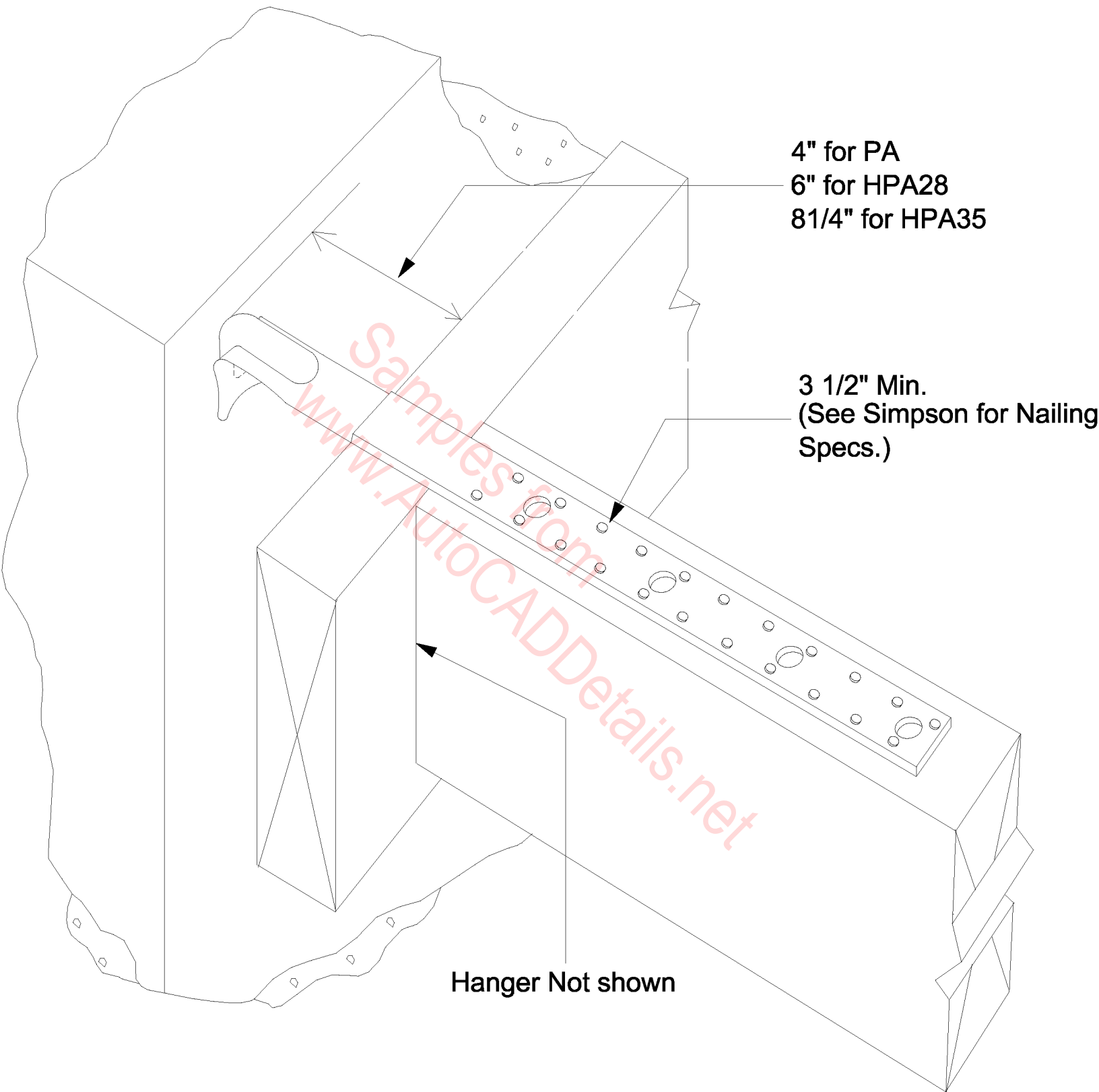

4" for PA  
6" for HPA28  
8 1/4" for HPA35

3 1/2" Min.  
(See Simpson for Nailing  
Specs.)

Hanger Not shown

PA OR HPA Purlin To Concrete Wall  
Simpson Strong-Tie

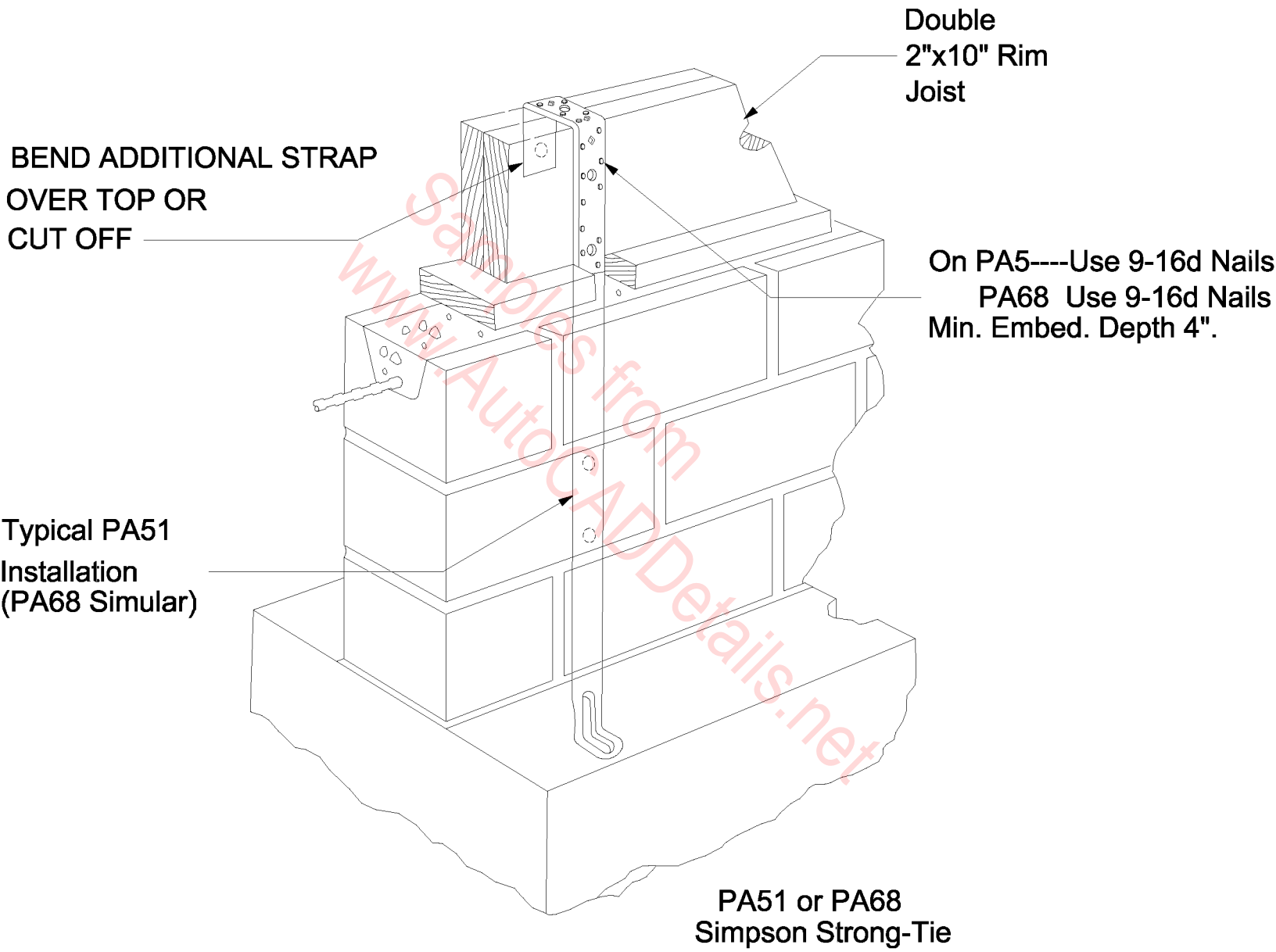

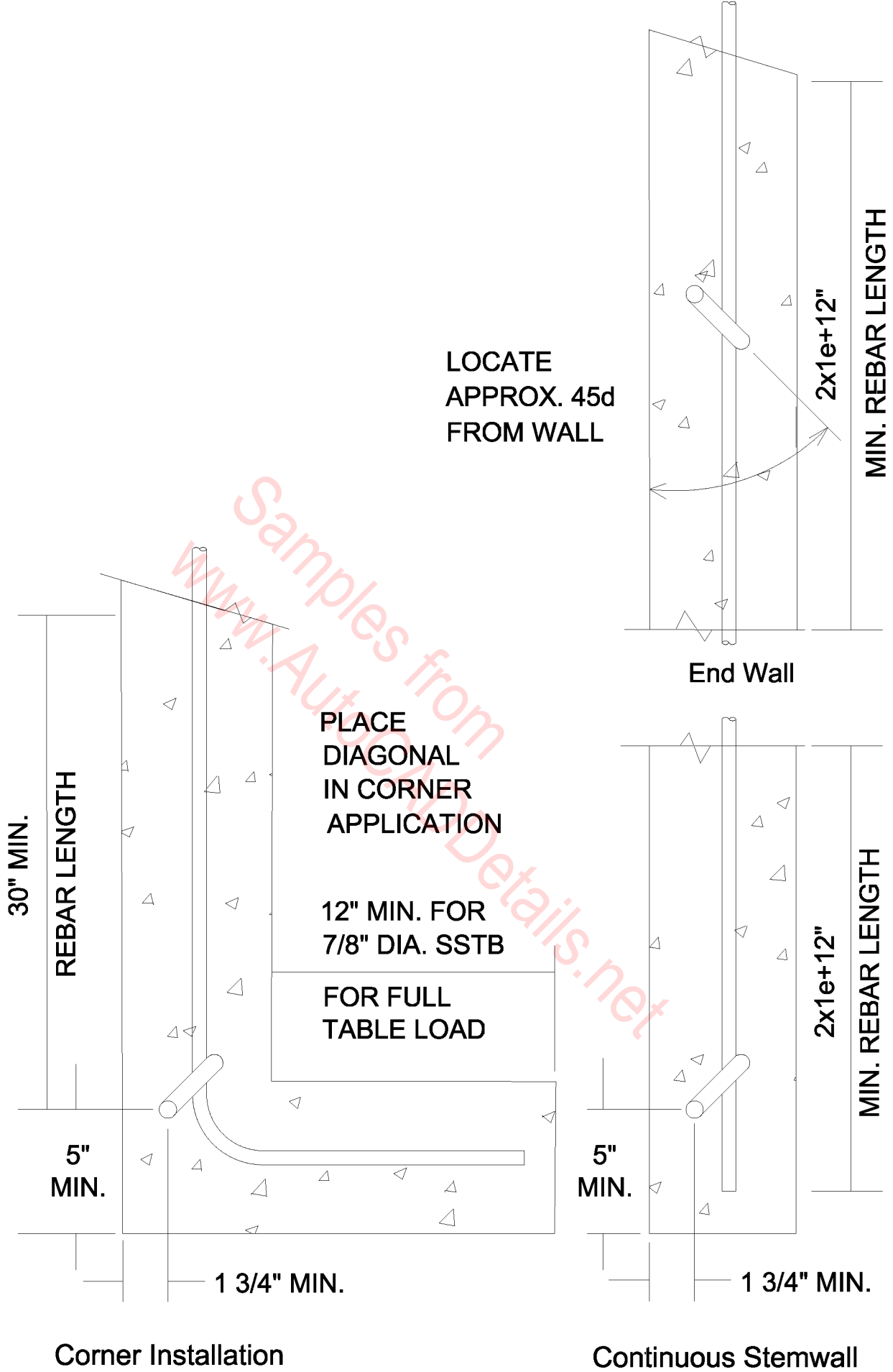

Typical Plan Views  
of Rebar installation  
(SSTB)

2" MINIMUM  
SIDECOVER

Use 12-16d  
Nails

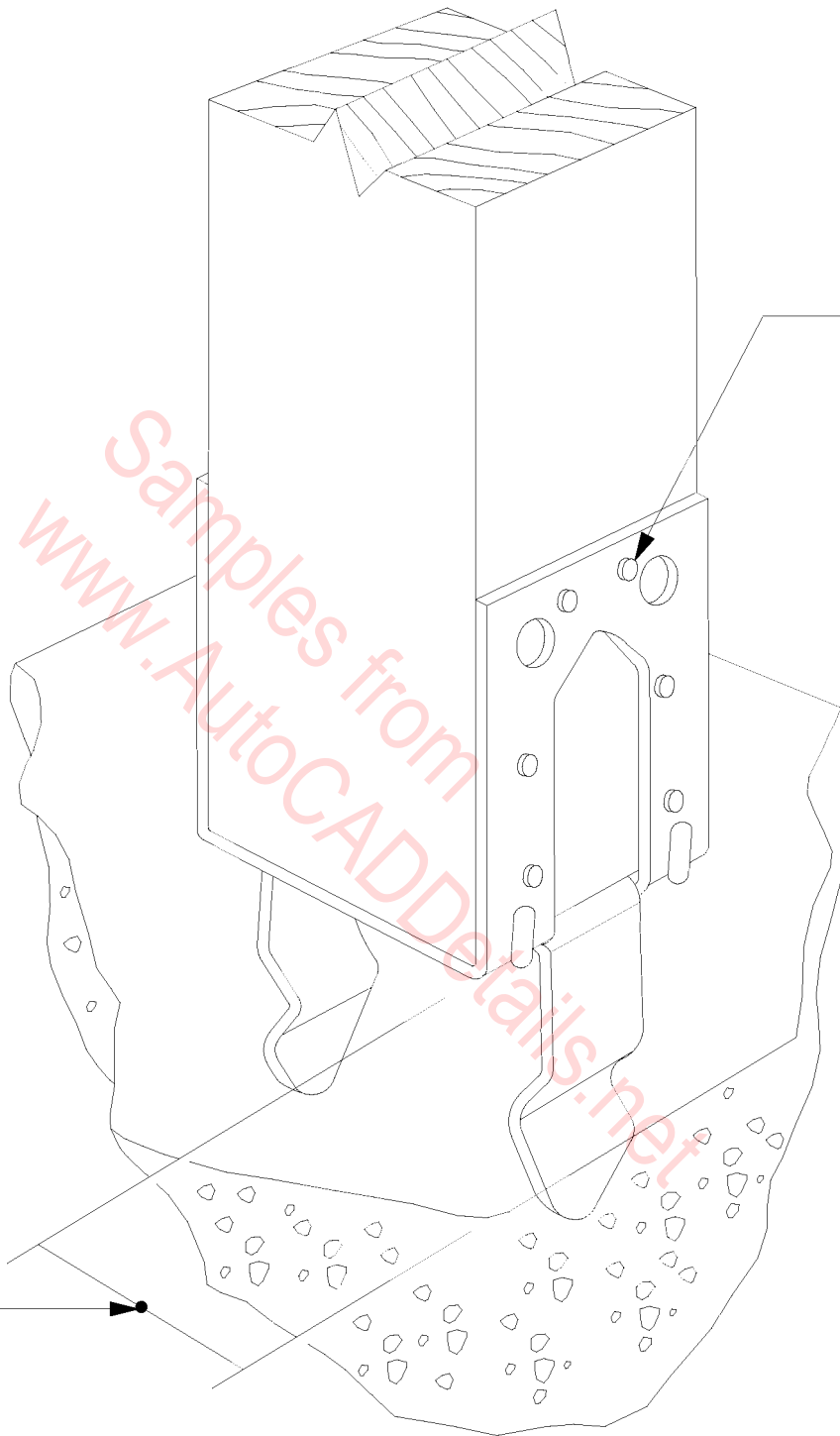

Typical PB Installation

Use 8-16d Nails

Allow 1" to 2 1/2" clearance  
above concrete. 2" for  
EPB44A. Insert EPB into  
concrete after screeding.

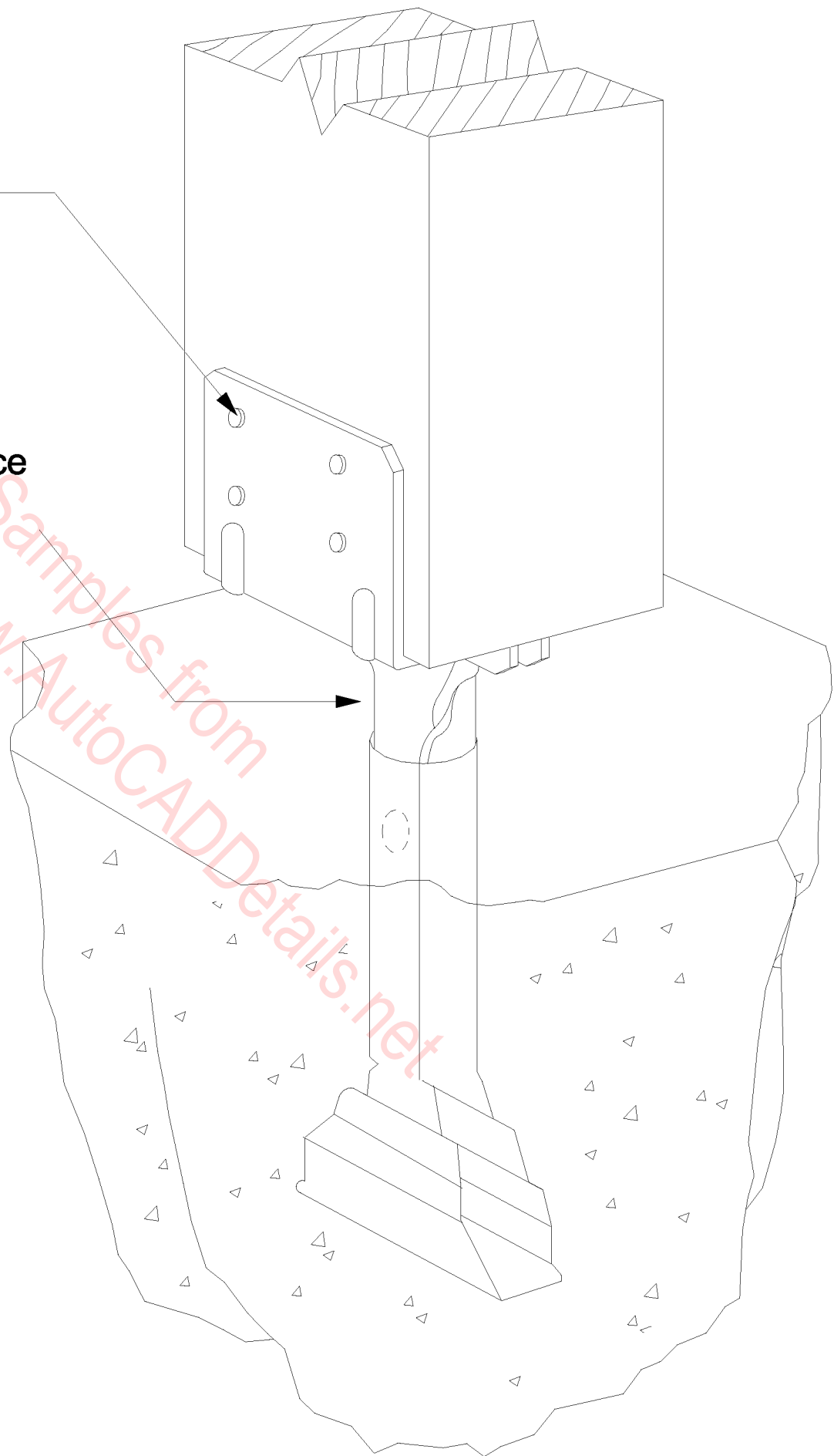

Typical EPB44A Installation

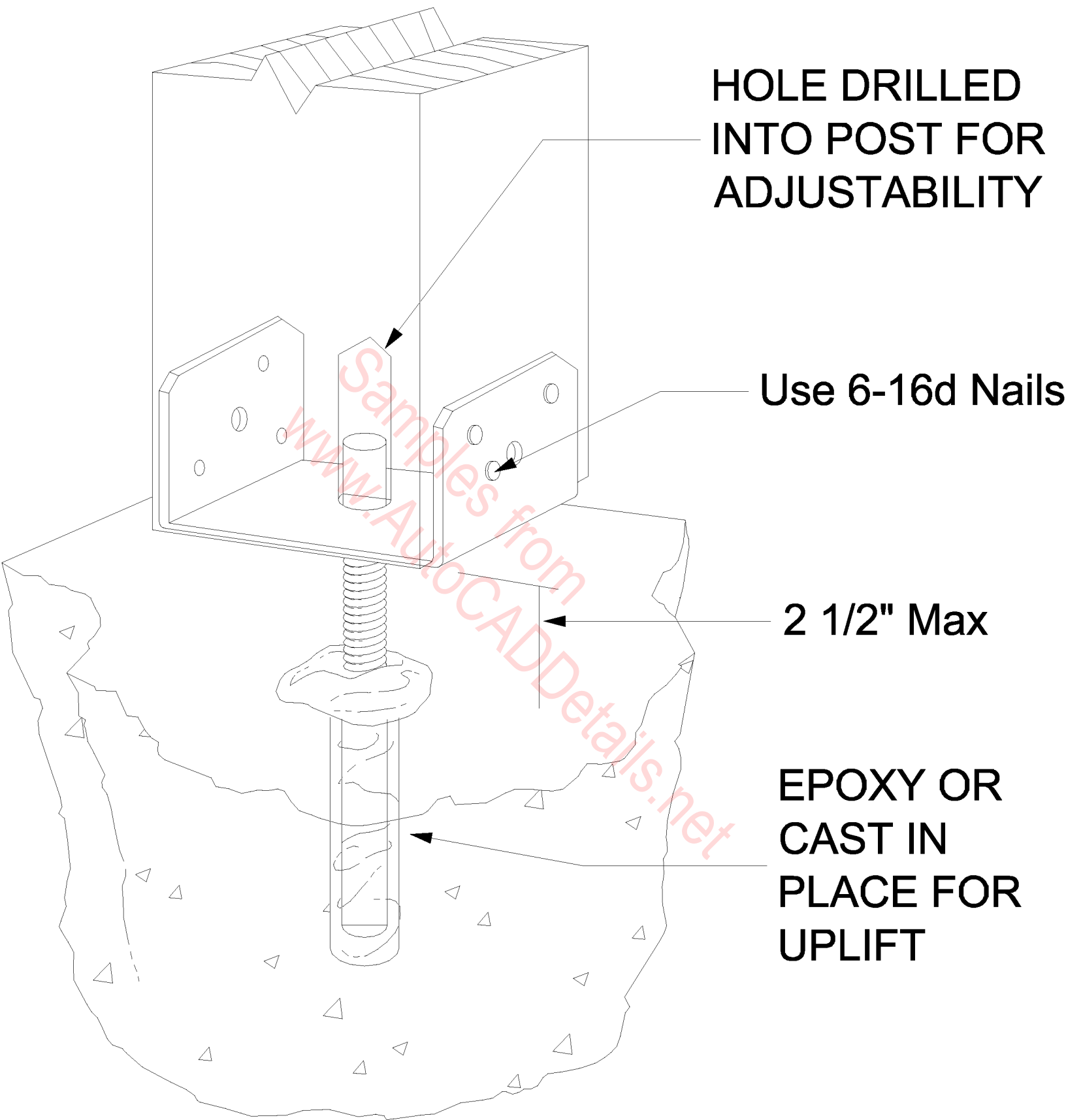

Typical EPB44T Installation with Epoxy

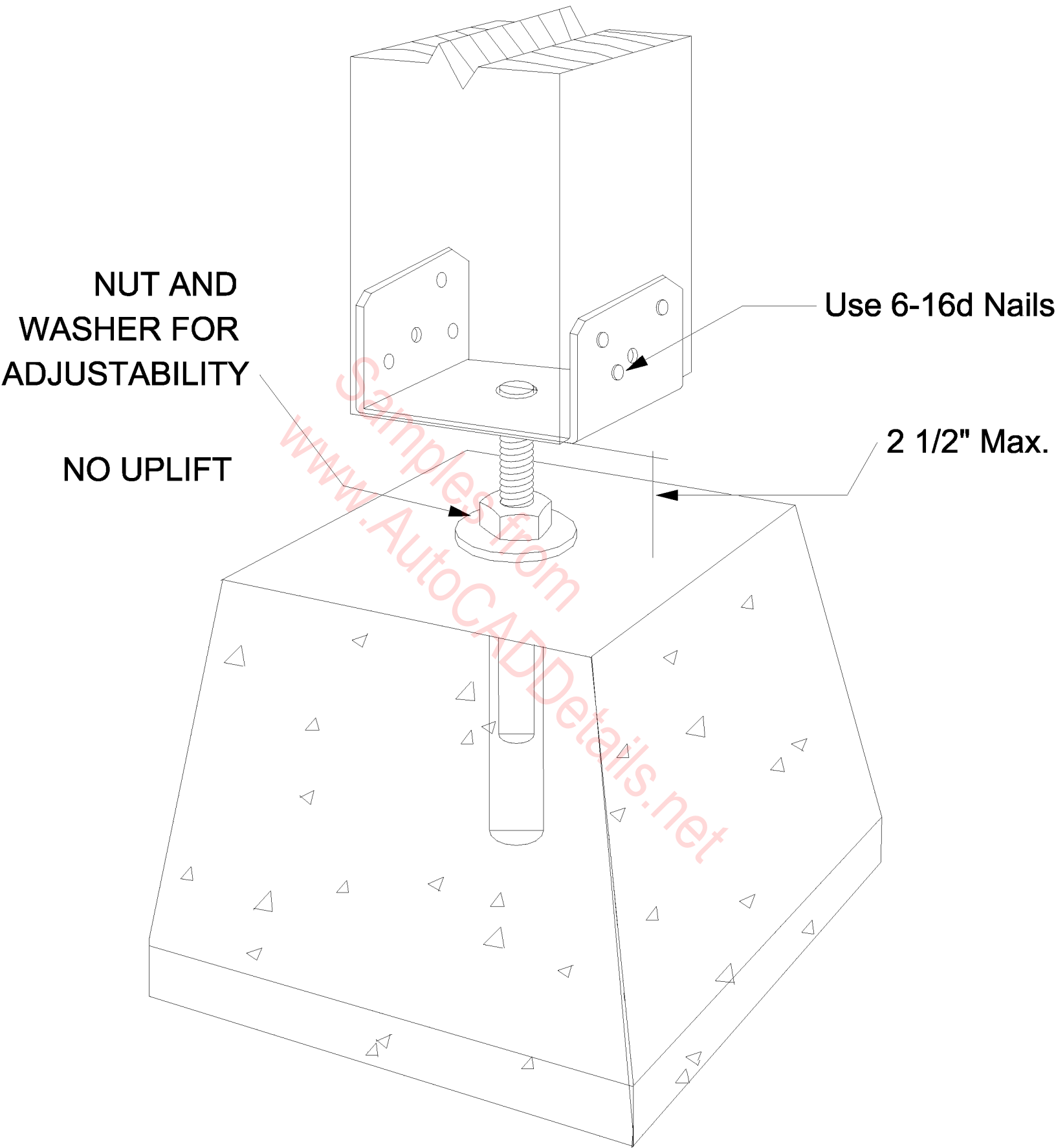

Typical EPB44T Installation w/nut & washer

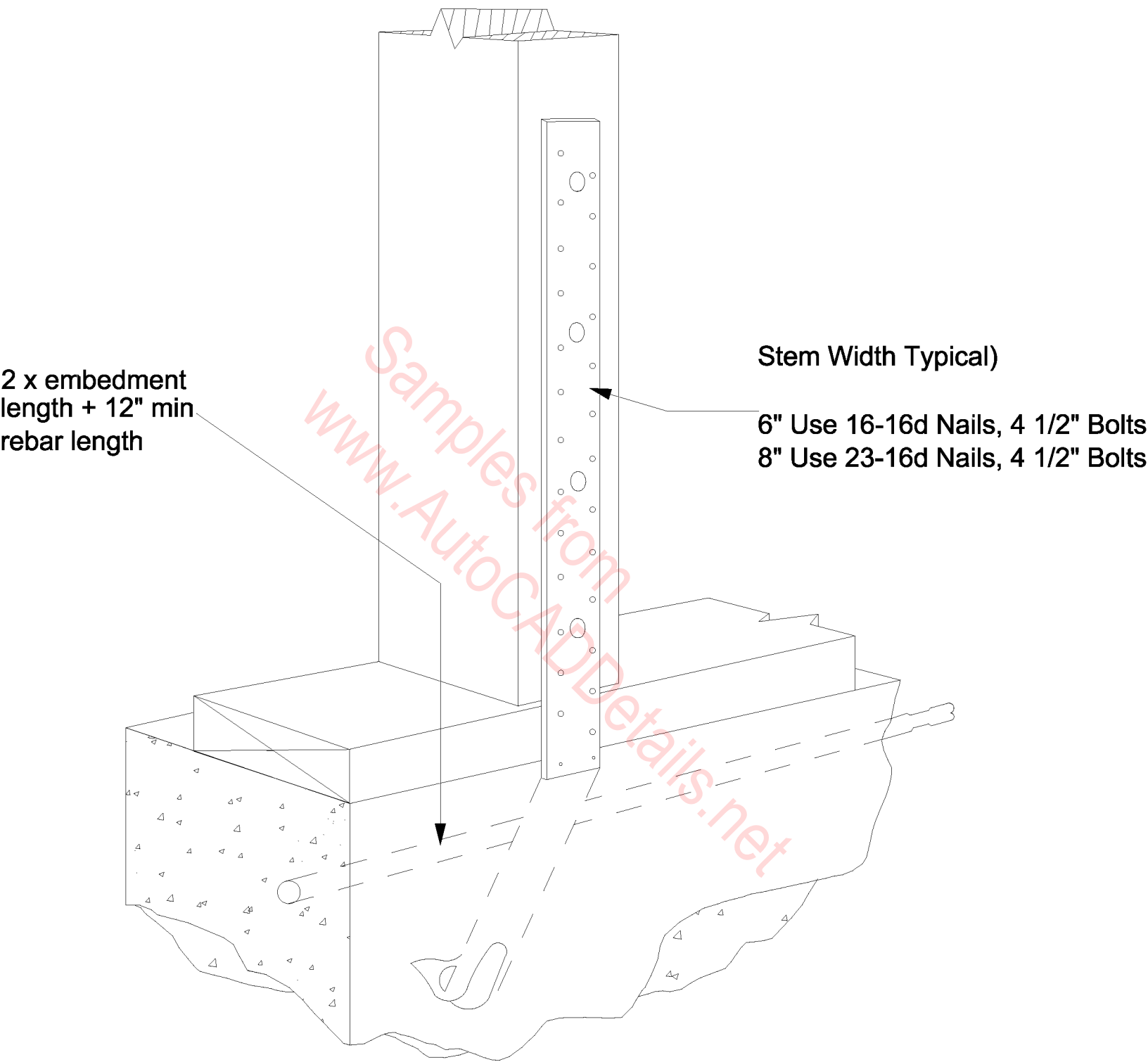

**Typ. Single Pour Edge Installation  
HPAHD Series**



Stem Width

6"--Use 9-16d Nails, 3 1/2" Bolts

8"--Use 11-16d Nails, 3 1/2" Bolts

One #4 Rebar in shear  
cone 12" Min. Rebar  
length

30" Min Rebar  
length

Corner Distance  
from edge of strap  
to corner

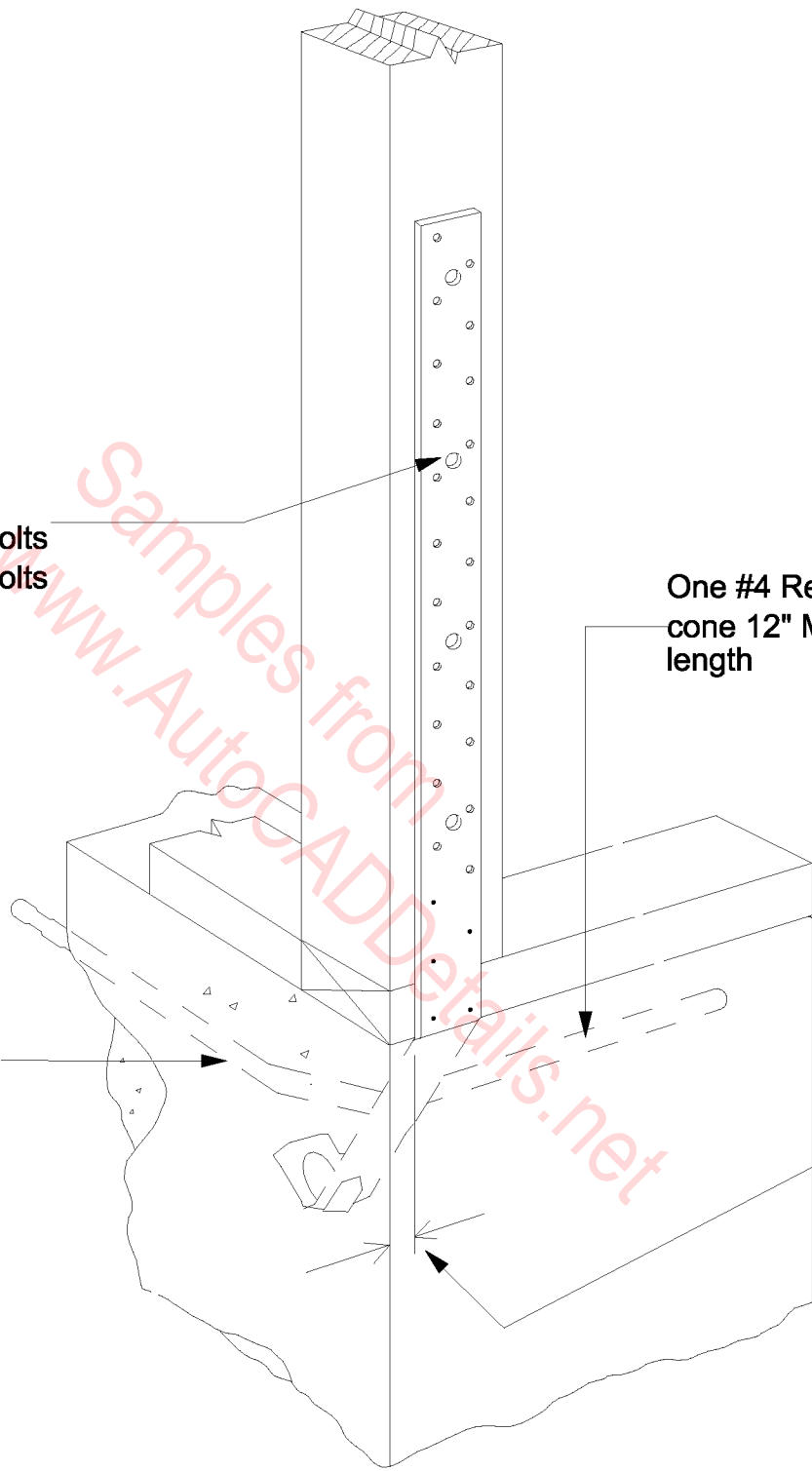

Typ. Single Pour Corner Installation  
HPAHD Series

Stem Wall  
Thickness  
6" Min. 8" For 7/8"  
SSTB

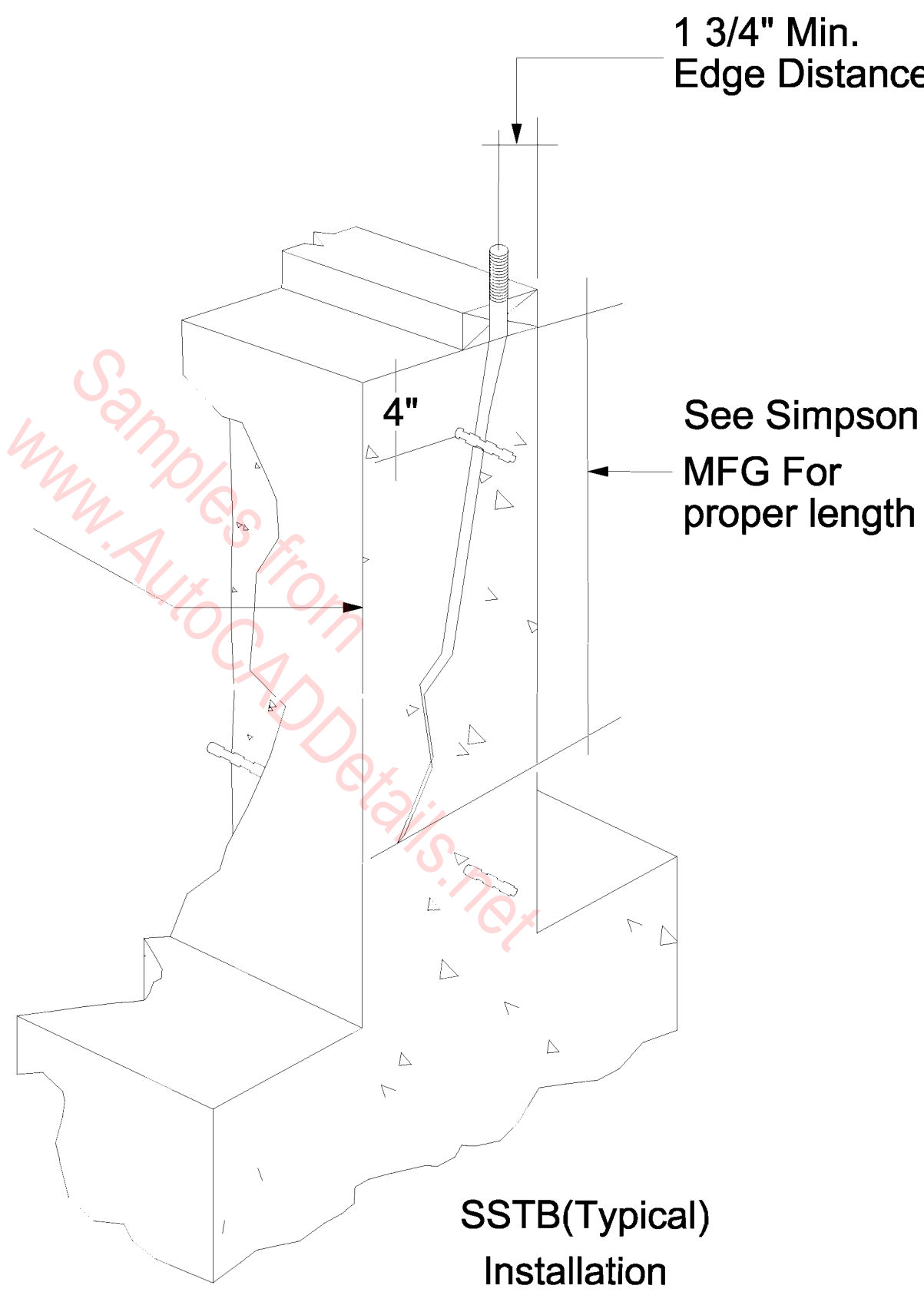

1 3/4" Min.  
Edge Distance

4"

See Simpson  
MFG For  
proper length

SSTB(Typical)  
Installation

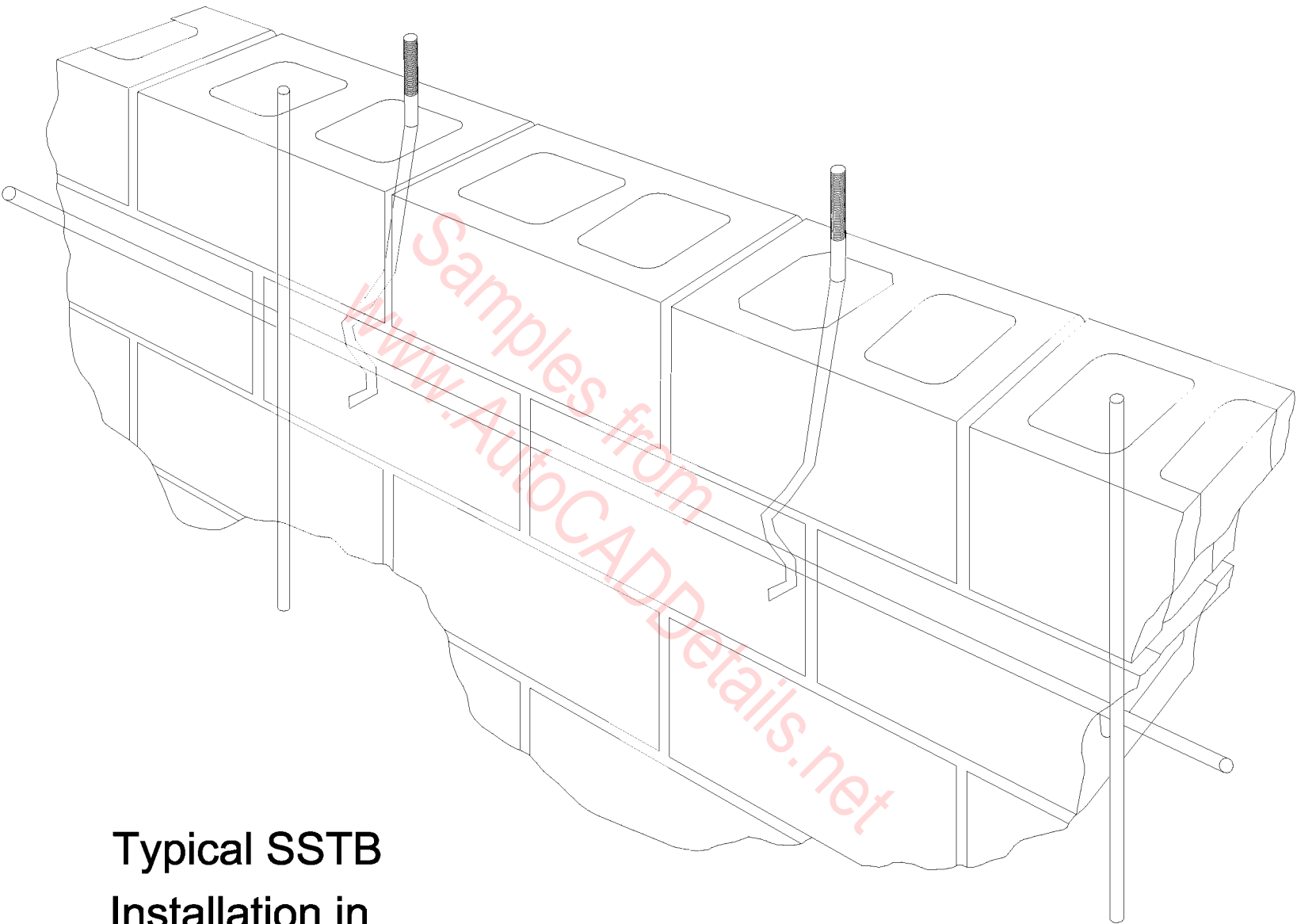

**Typical SSTB  
Installation in  
Grouted Concrete  
Block**