

SLIDING TACKBOARD DETAIL

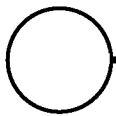

3" = 1'-0"

12B-3001

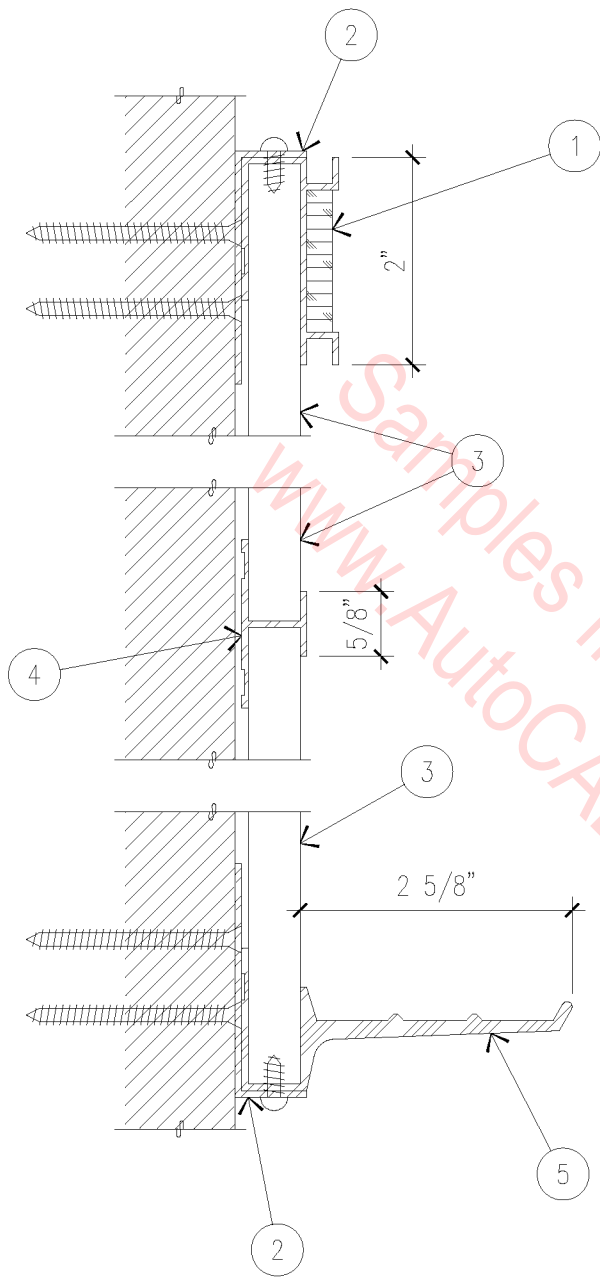

1. MAP RAIL WITH CORK INSERT – MAP HOOKS AT 2'-0" O.C.
2. 'L' CLIP MOUNTING BRACKET WITH (2) 2" SCREWS.
3. CHALK BOARD.
4. 'H' BAR DIVIDER.
5. CHALK TRAY.

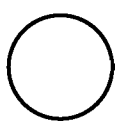

CHALKBOARD MOUNTING

6" = 1'-0"

12B-3002

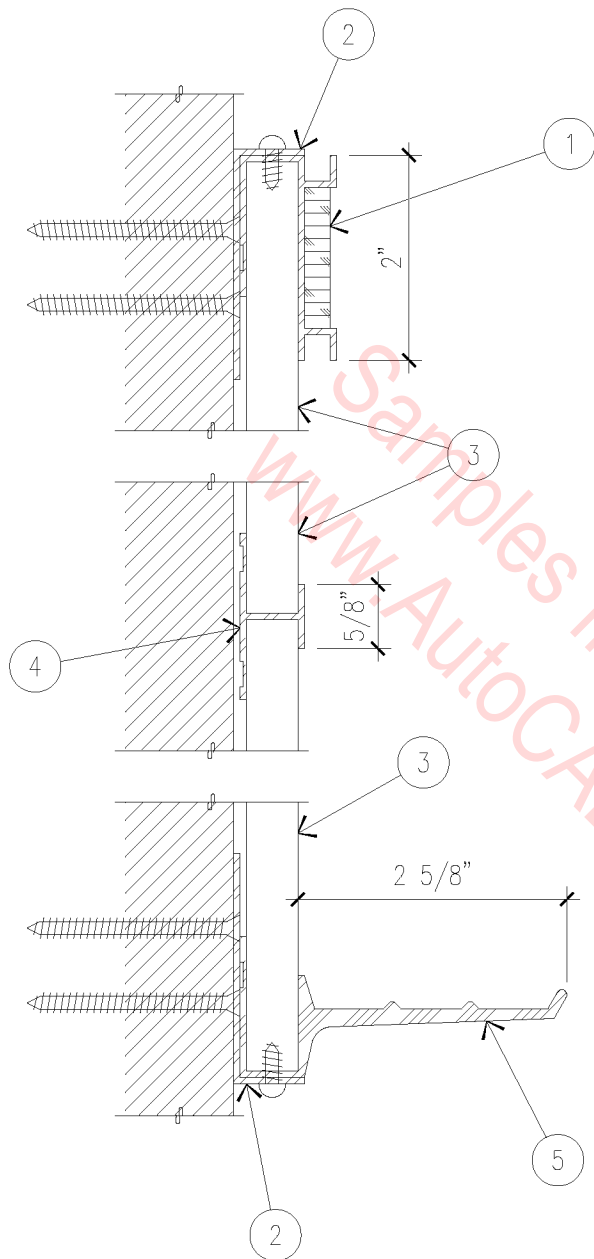

1. MAP RAIL WITH CORK INSERT – MAP HOOKS AT 2'-0" O.C.
2. 'L' CLIP MOUNTING BRACKET WITH (2) 2" SCREWS.
3. CHALK BOARD.
4. 'H' BAR DIVIDER.
5. CHALK TRAY.

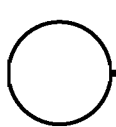

CHALKBOARD MOUNTING

6" = 1'-0"

12B-3002

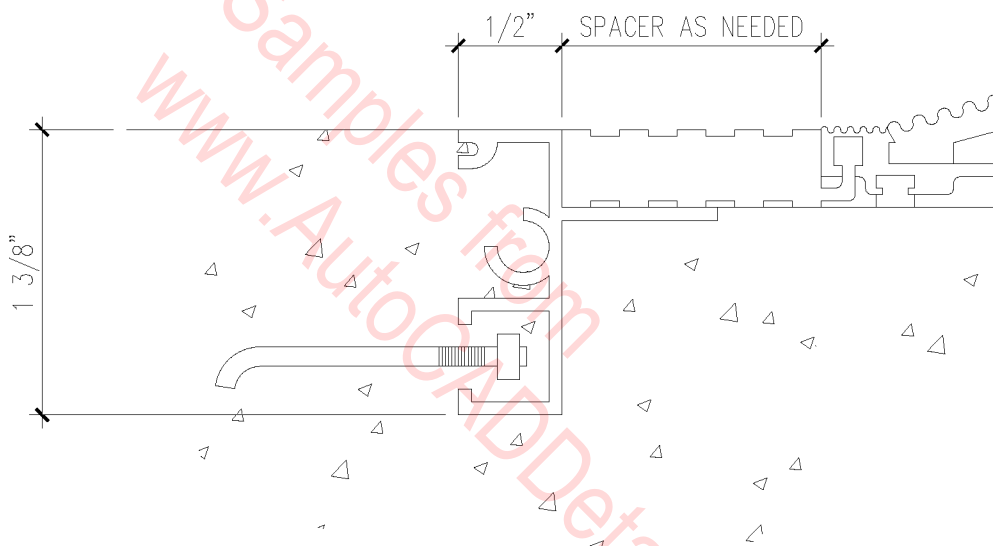

HINGE MAT MOUNTED
TO CONCRETE SLAB

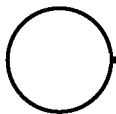

1" = 1"

12B-2001

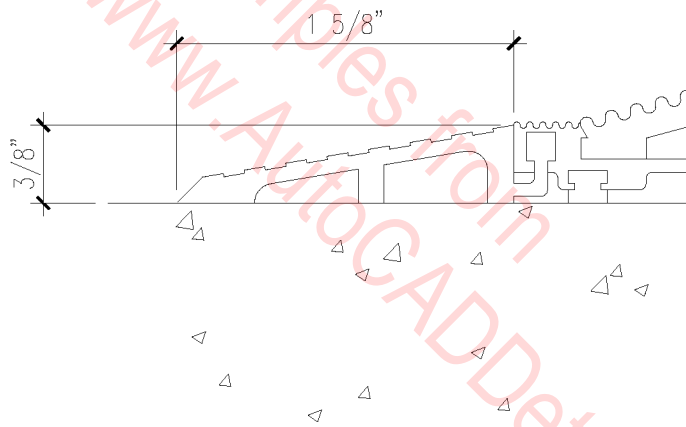

HINGE MAT MOUNTED
TO CONCRETE SLAB

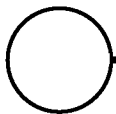

1" = 1"

12B-2002

- 1. VCT FLOORING.
- 2. RUBBER MAT FLOORING.
- 3. CONCRETE SLAB.

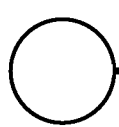
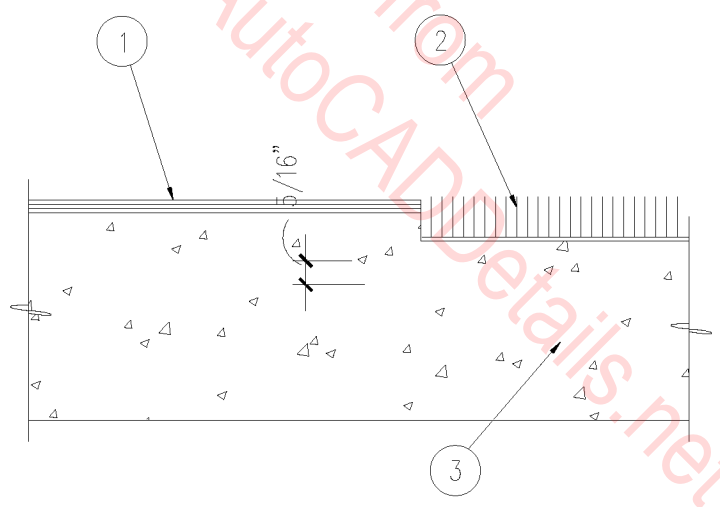

RECESSED RUBBER MAT

3" = 1'-0"

12B-1001

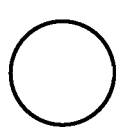
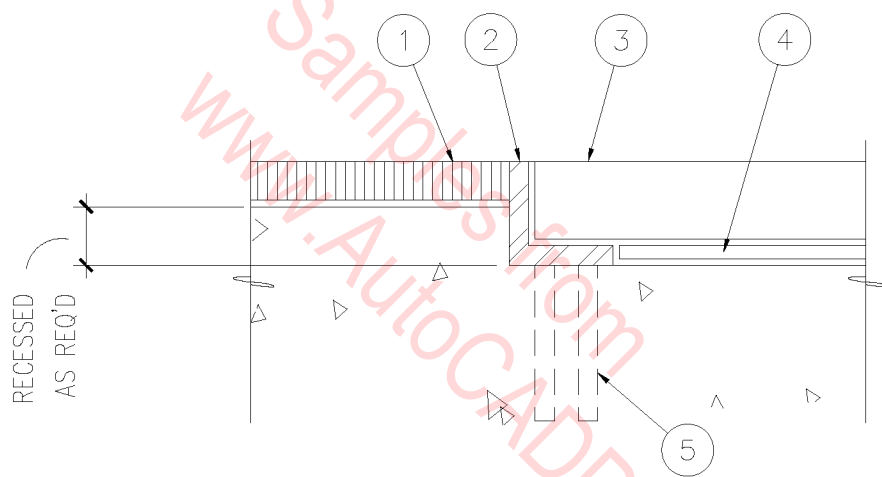

RECESSED FLOOR MAT

3" = 1'-0"

12B-1002

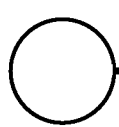
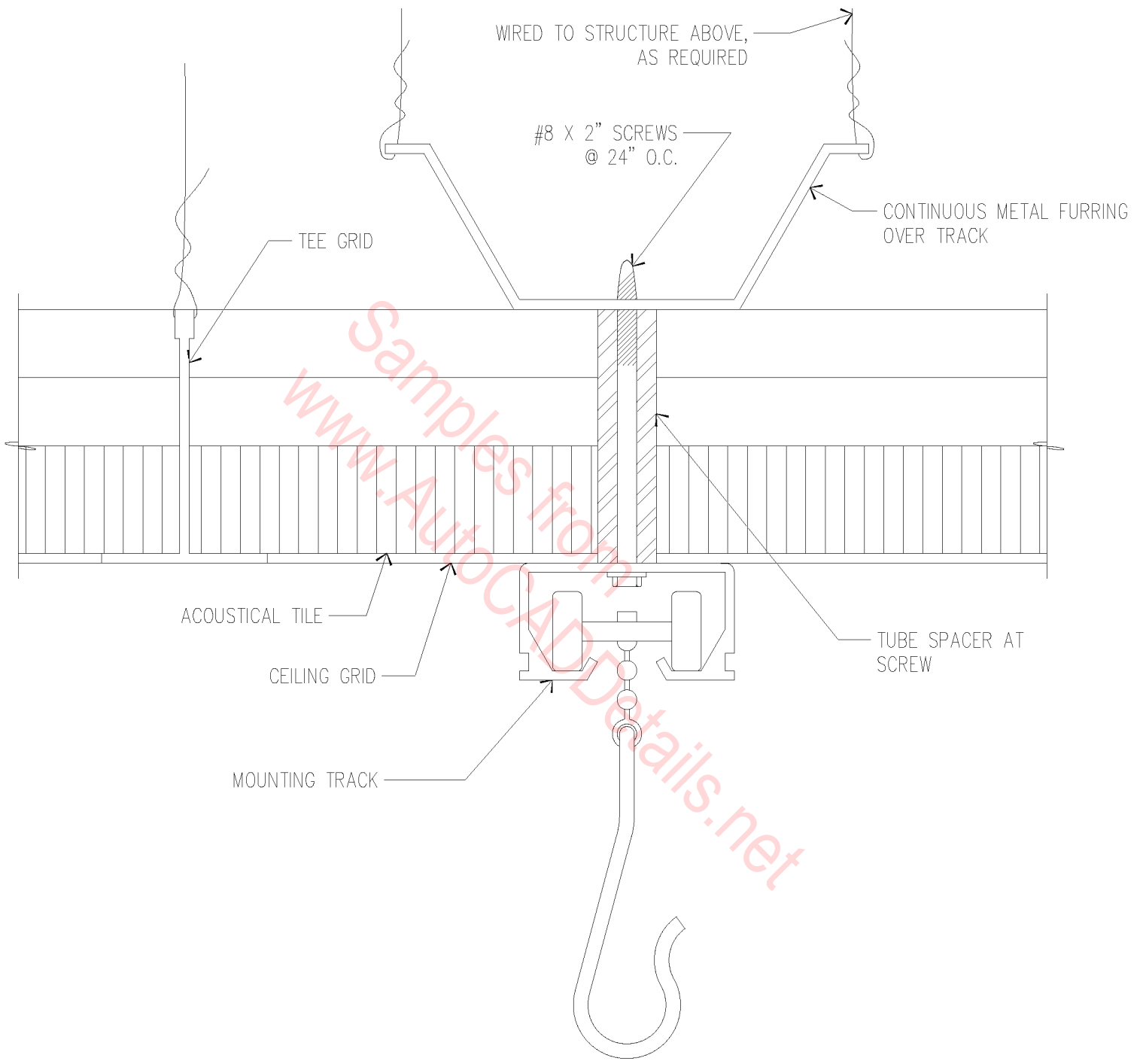

CURTAIN TRACK DETAIL

1" = 1"

12A-1001

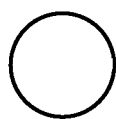
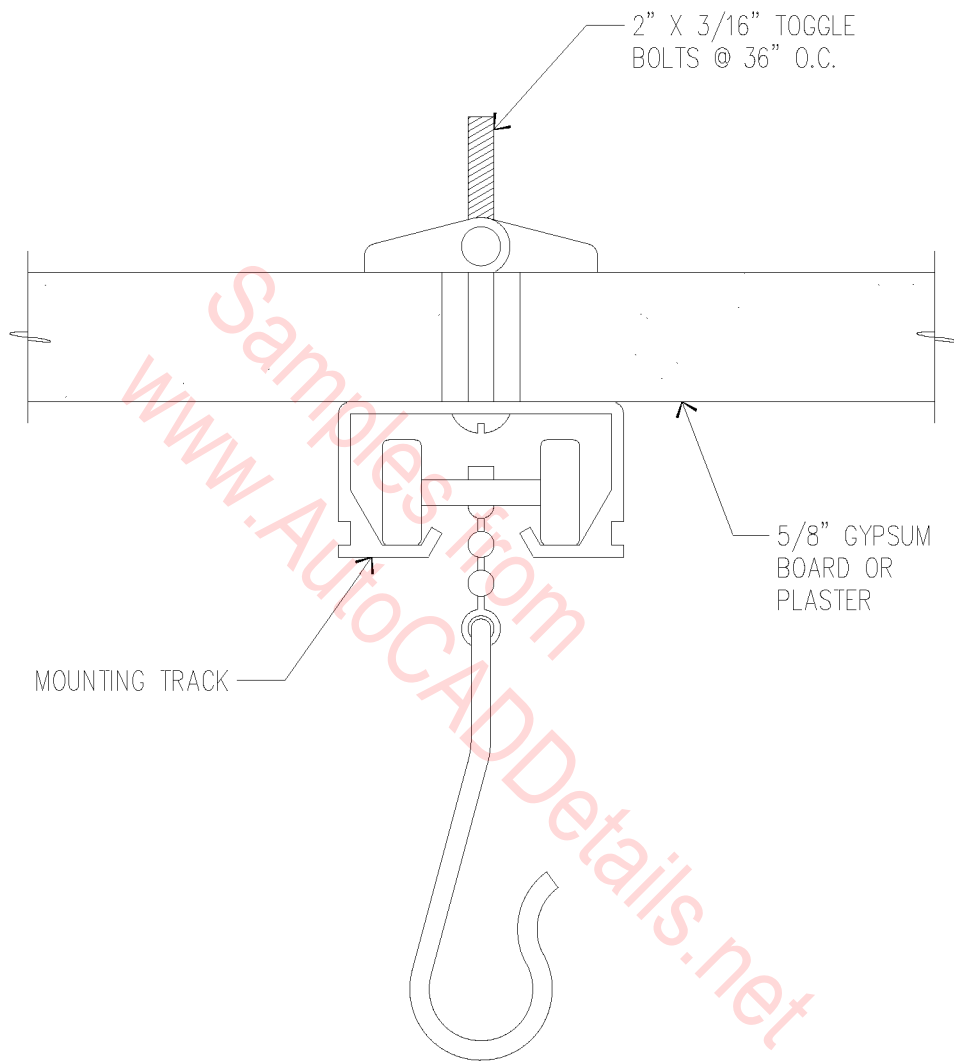

CURTAIN TRACK DETAIL

1" = 1"

12A-1002

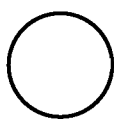
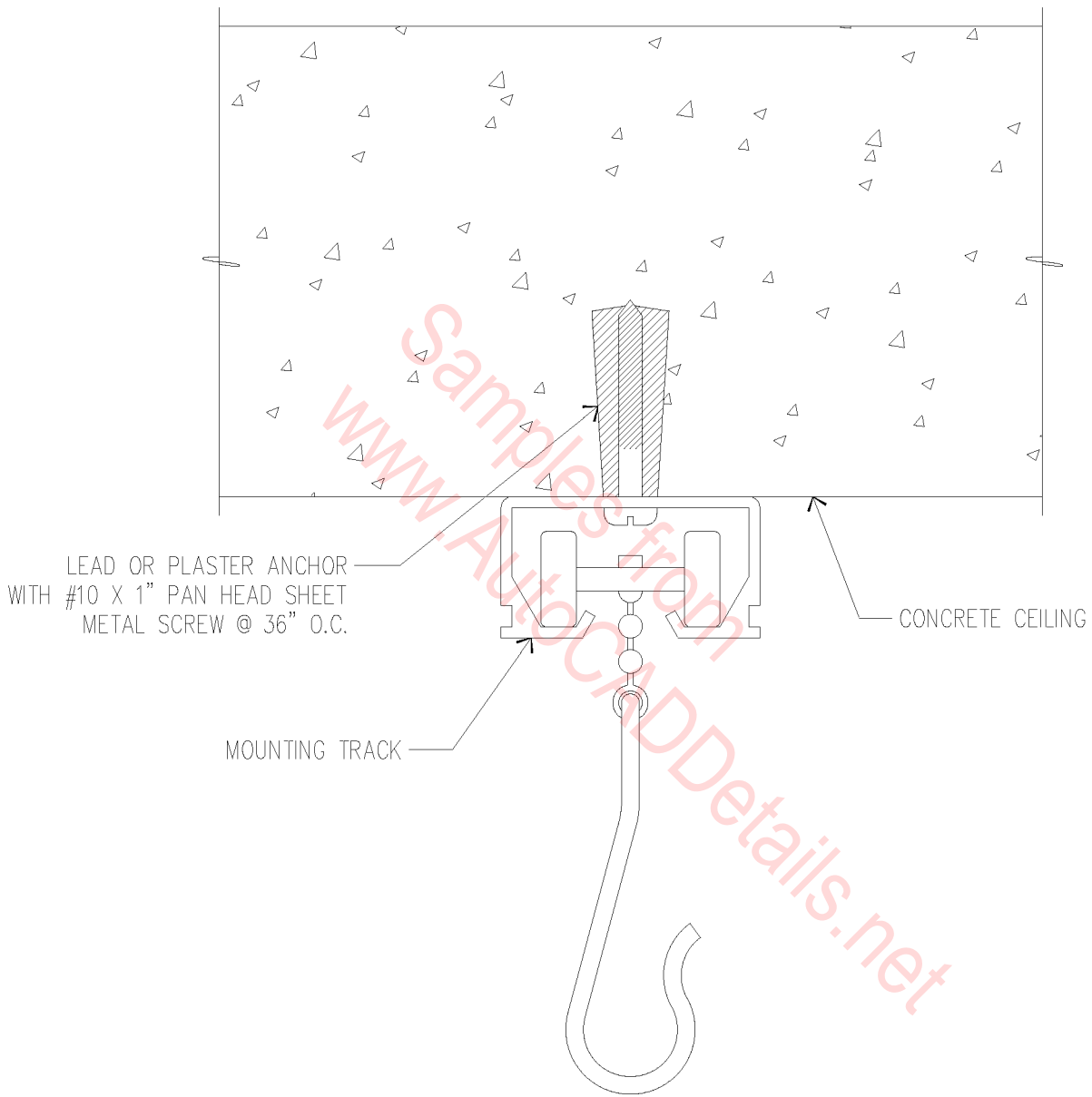

CURTAIN TRACK DETAIL

1" = 1"

12A-1003

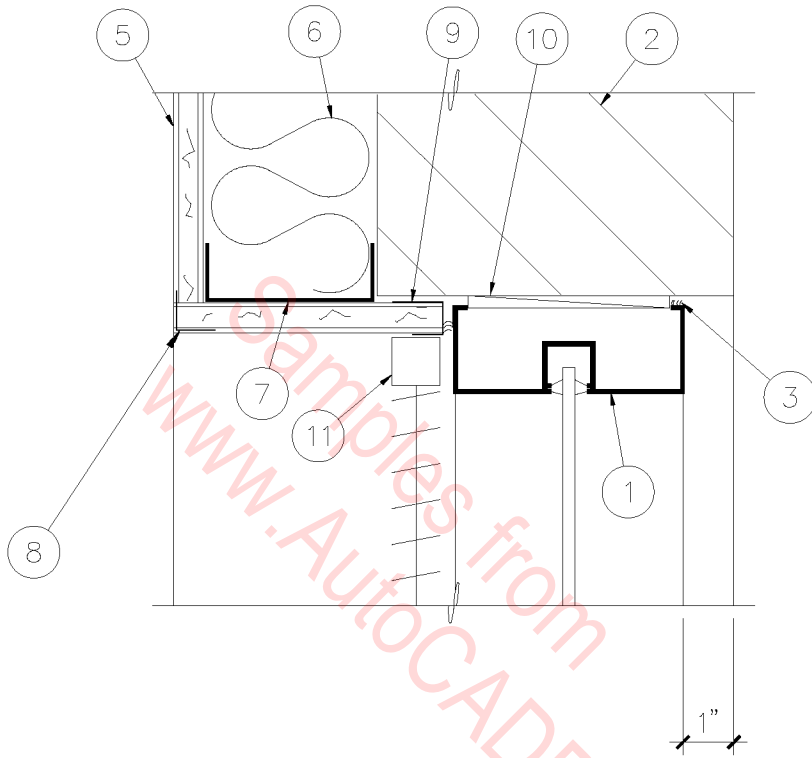

1. 1-3/4" X 4-1/2"
ALUMINUM FRAMING SYSTEM.
2. MASONRY WALL.
3. SEALANT.
4. GLASS.
5. 5/8" TYPE 'X' GYPSUM BOARD.
6. R-11 BATT INSULATION.
7. METAL STUDS.
8. CORNER BEAD.
9. CASING BEAD.
10. SHIM AS REQUIRED.
11. WINDOW BLIND.

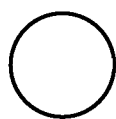

ALUMINUM FRAME

3" = 1'-0"

12A-2001

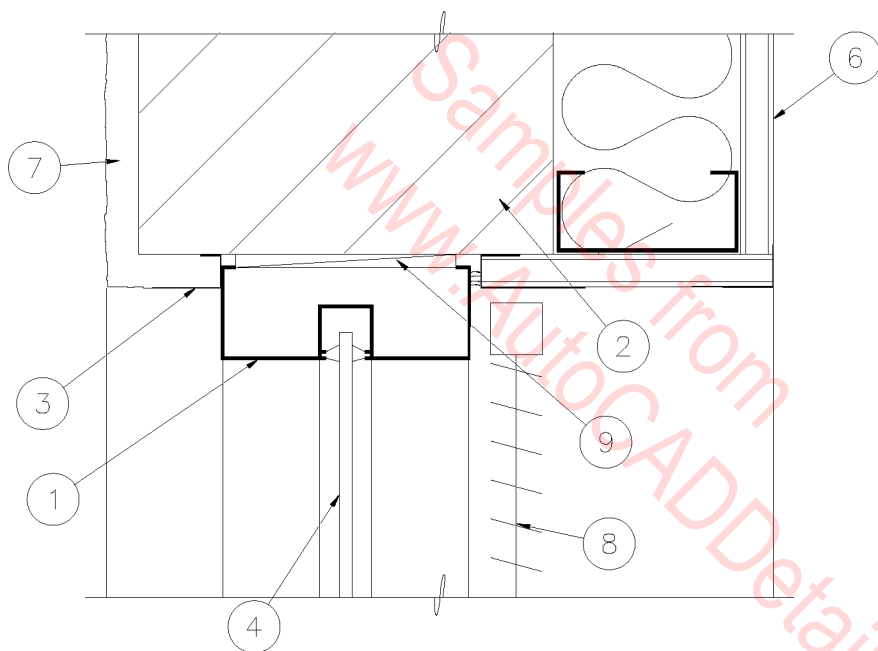

1. 1-3/4" X 4-1/2" ALUMINUM FRAMING SYSTEM.
2. MASONRY WALL.
3. 'J' MOLD & SEALANT - TYPICAL BOTH SIDES.
4. 1/4" GLASS.
5. CORNER BEAD - TYPICAL.
6. 5/8" GYP. BOARD ON 3-5/8" METAL STUDS WITH R-11 BATT INSULATION.
7. 5/8" CEMENT PLASTER.
8. WINDOW BLIND.
9. SHIM.

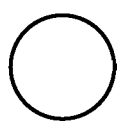

ALUMINUM FRAME

3" = 1'-0"

12A-2002

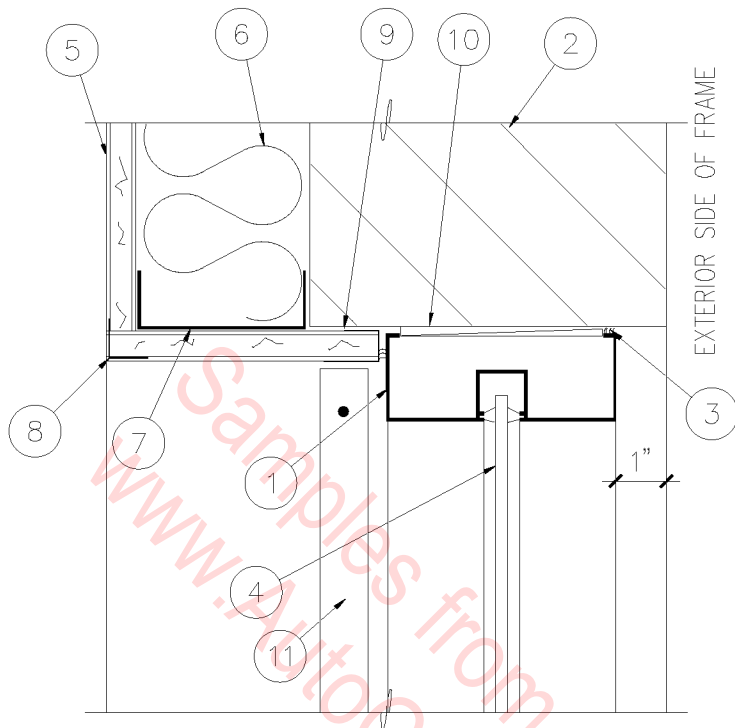

1. 1-3/4" X 4-1/2" ALUMINUM FRAMING SYSTEM.
2. MASONRY WALL.
3. SEALANT EACH SIDE.
4. GLASS.
5. 5/8" GYPSUM BOARD.
6. R-11 BATT INSULATION.
7. METAL STUDS.
8. CORNER BEAD.
9. CASING BEAD.
10. SHIM AS REQUIRED.
11. WINDOW BLIND.

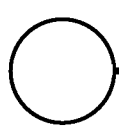

ALUMINUM HRAME JAMB

3" = 1'-0"

12A-2003