

Min. of 2" to Bolt
Center

FSA ANCHOR Fasteners

TO Stud/joist/plate
8-10dx1 1/2

TO Foundation
2--RFB#4X6 Anchor Bolt
& Epoxy

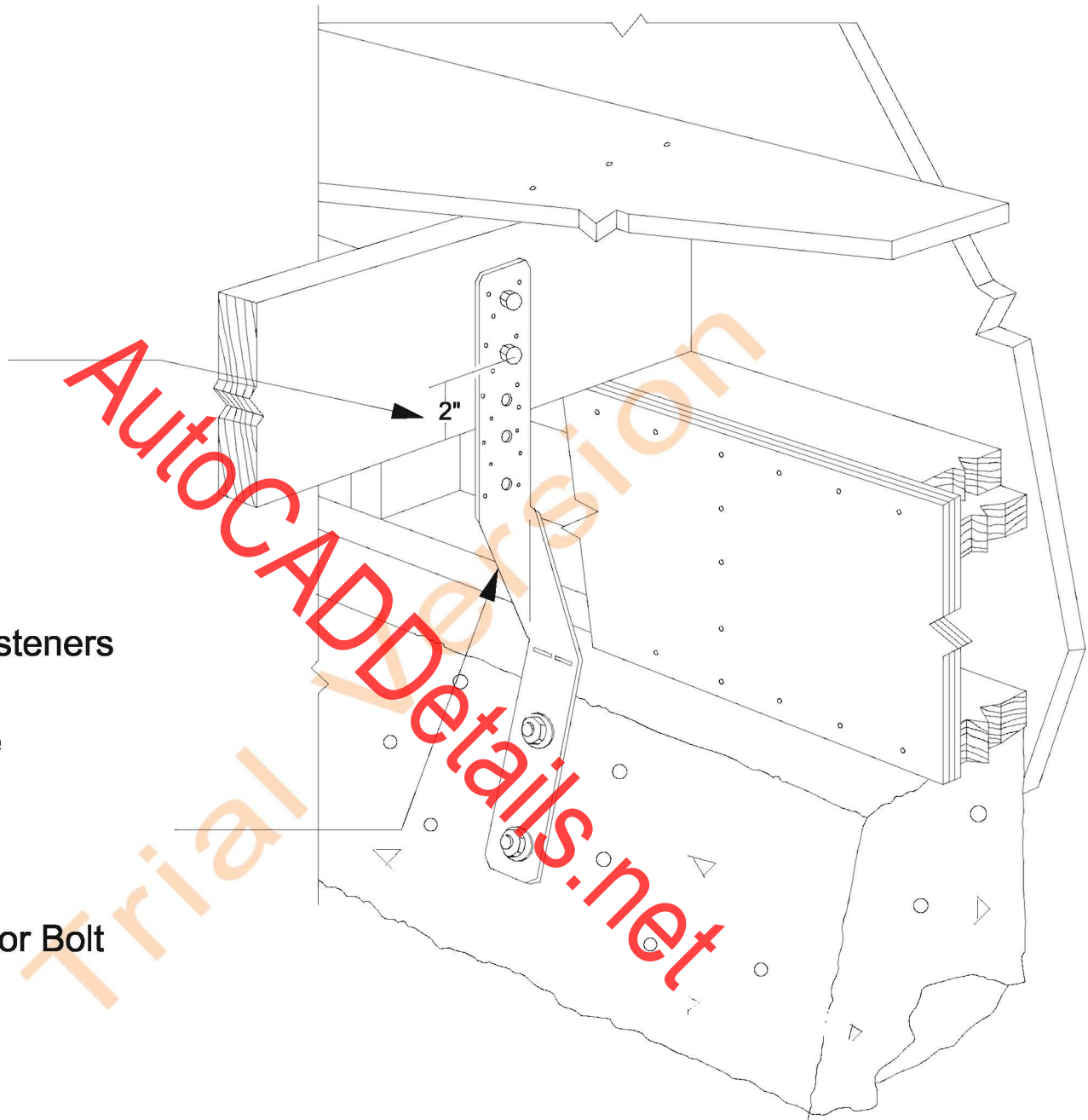

FOUNDATION TO FLOOR JOIST
(RETROFIT)

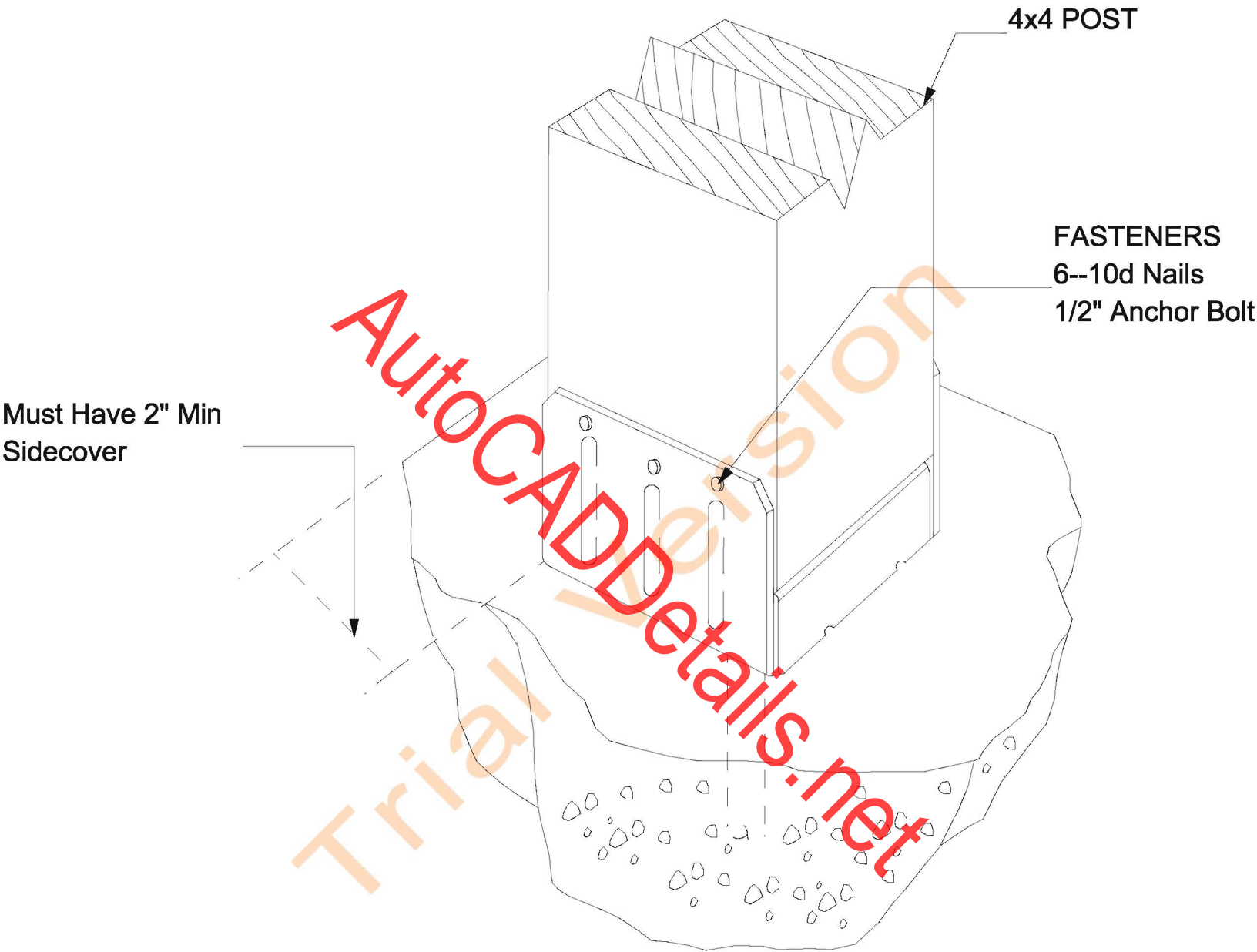

STANDOFF POST BASE
Using Simpson ABE44
Post Base

See MFG for proper
fasteners to use in
Post or Beam

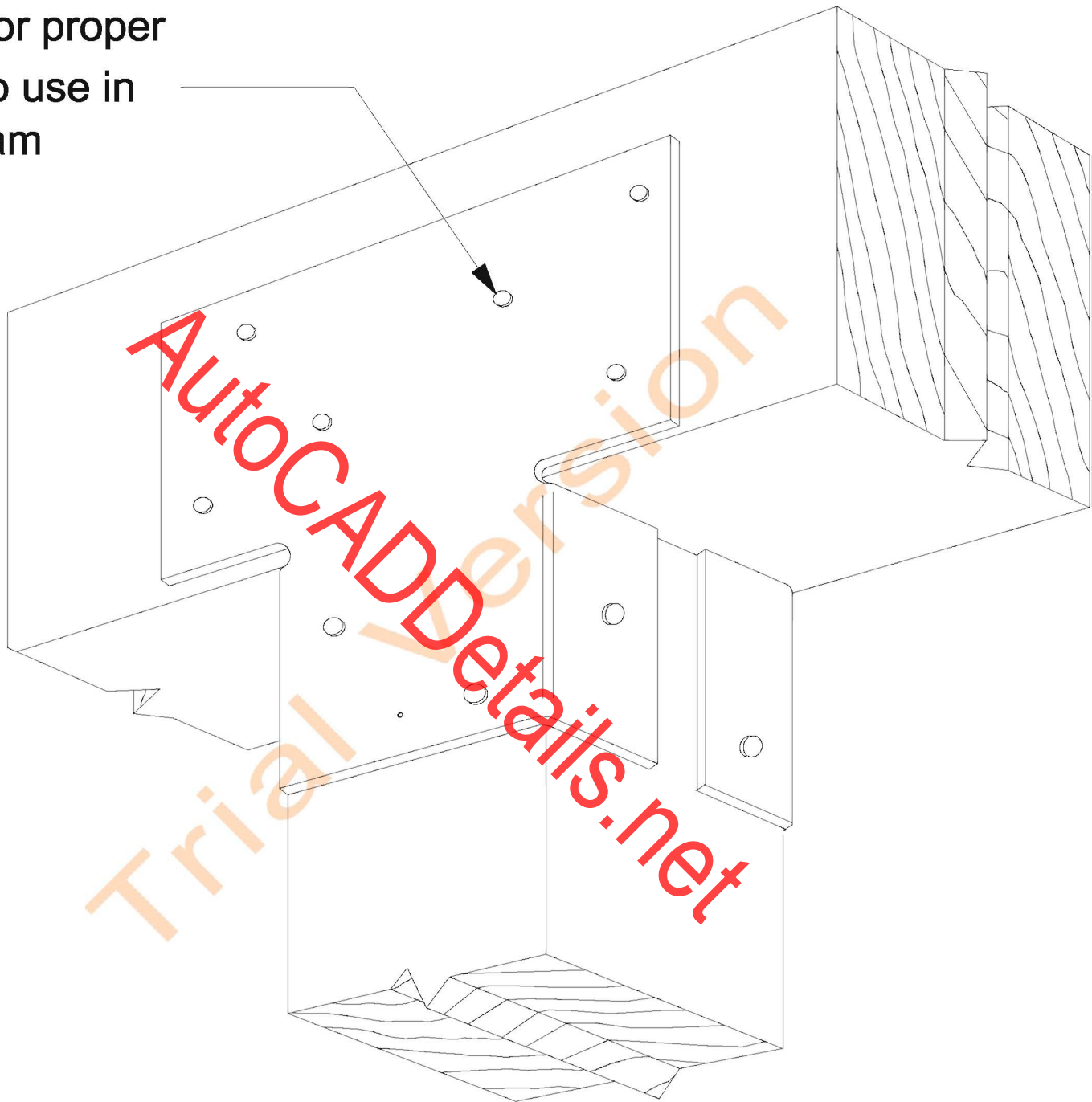

Typical AC Installation

NOTE:

See Simpson catalog for fasteners and allowable loads to meet local code requirements.

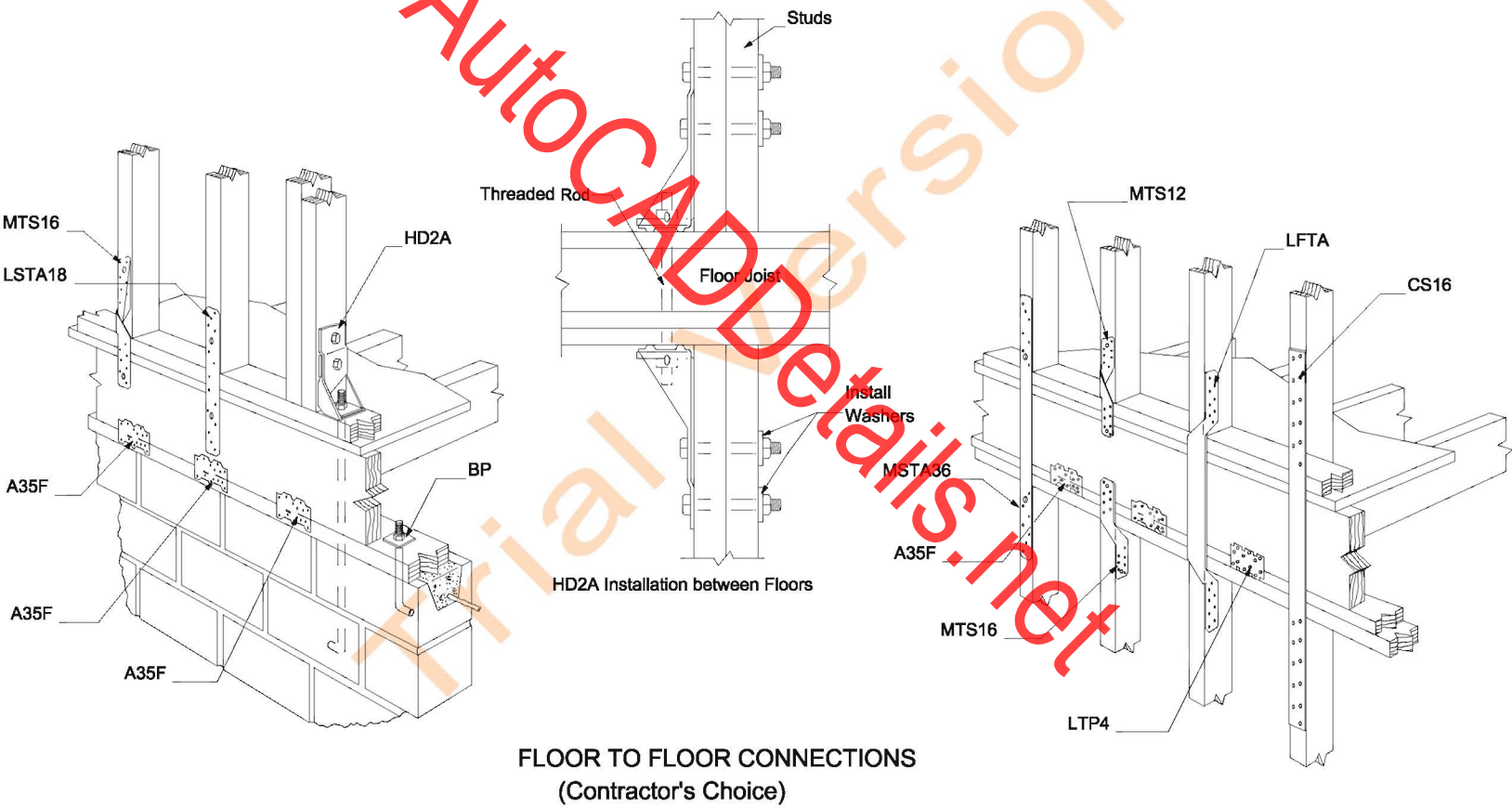

FLOOR TO FLOOR CONNECTIONS
(Contractor's Choice)

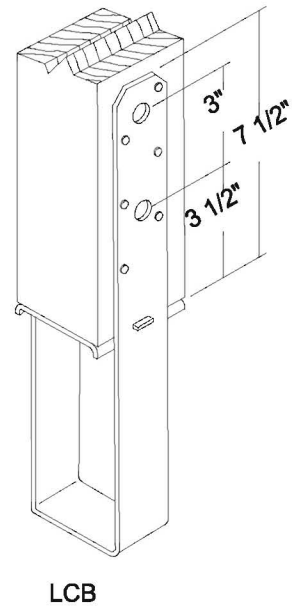
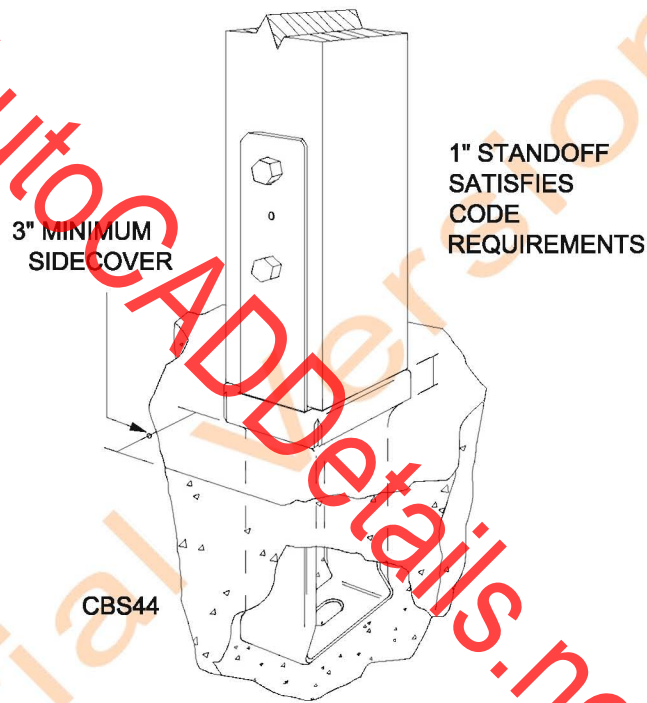
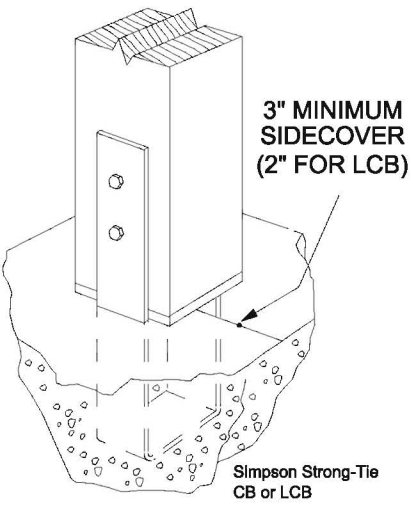

COLUMN BASES (Contractor's Choice)

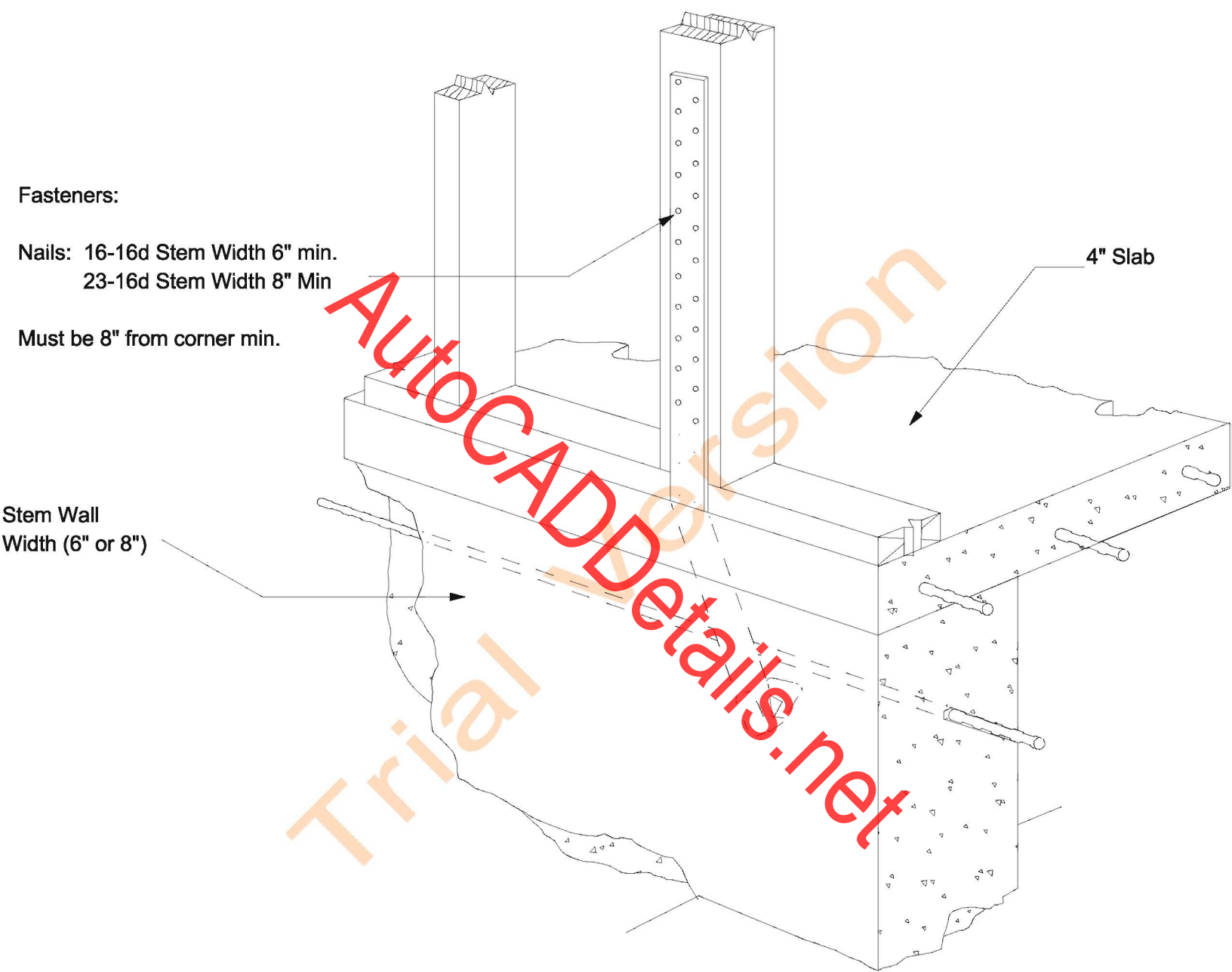

Fasteners:

Nails: 16-16d Stem Width 6" min.
23-16d Stem Width 8" Min

Must be 8" from corner min.

4" Slab

Stem Wall
Width (6" or 8")

Typ. Double Pour Edge Holdown Installation
HPAHD22-2P Series

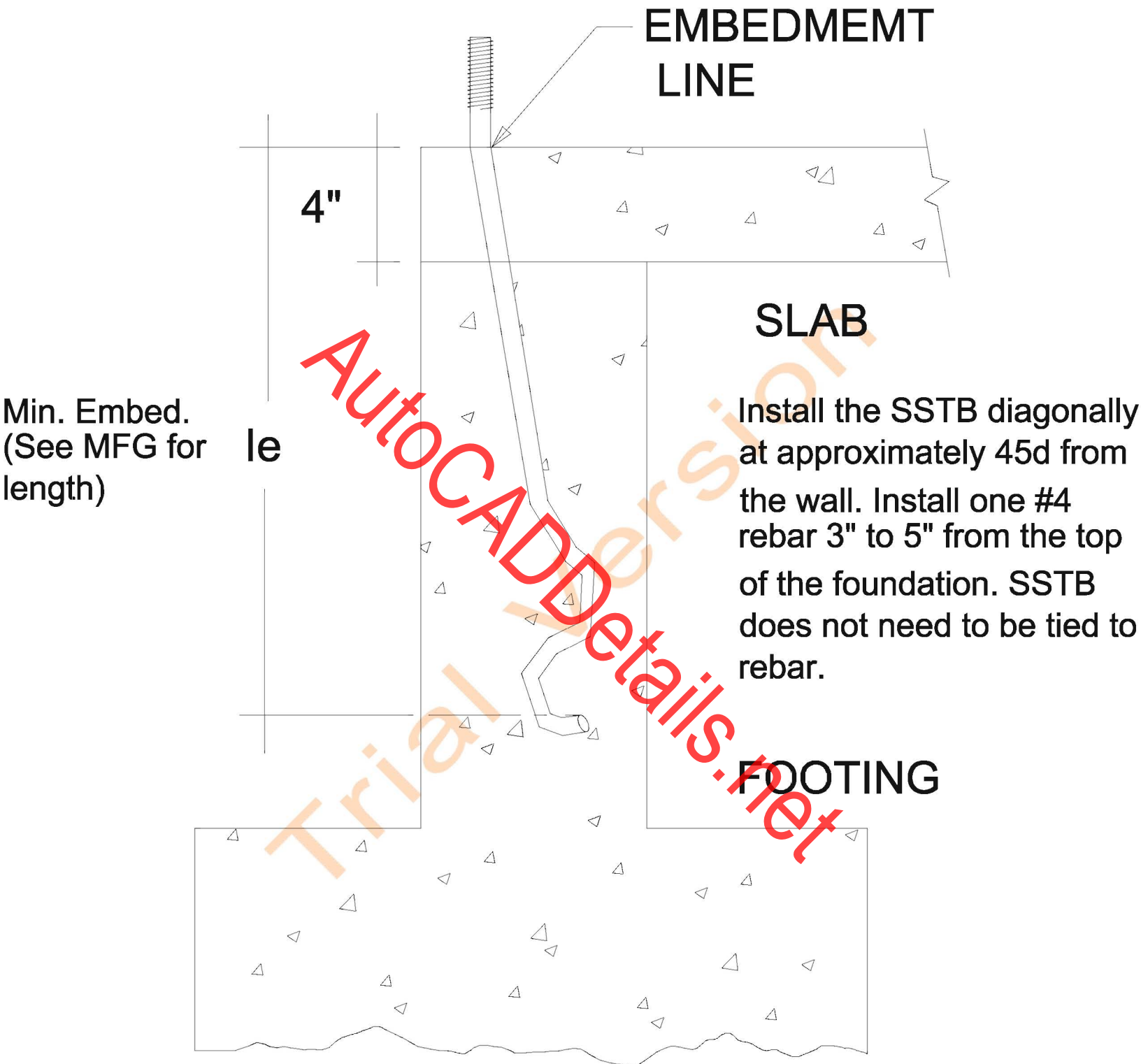

**Double Pour Installation
(SSTB20, 24 and 34)**

NOTE:

See Simpson for correct attachments and loads for your local area to meet code requirements.

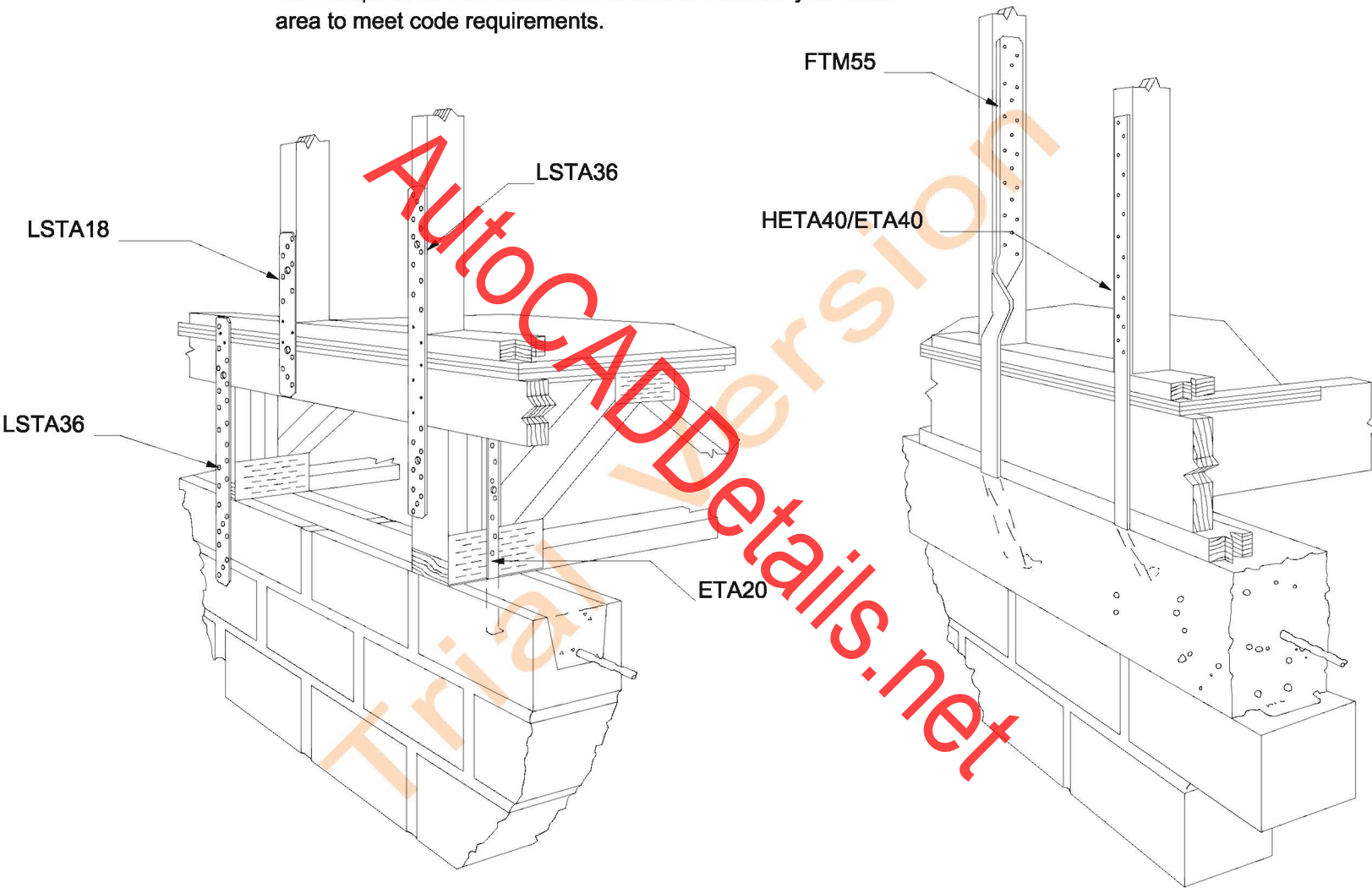

**FLOOR TO FLOOR CONNECTION
(Contractor's Choice)**

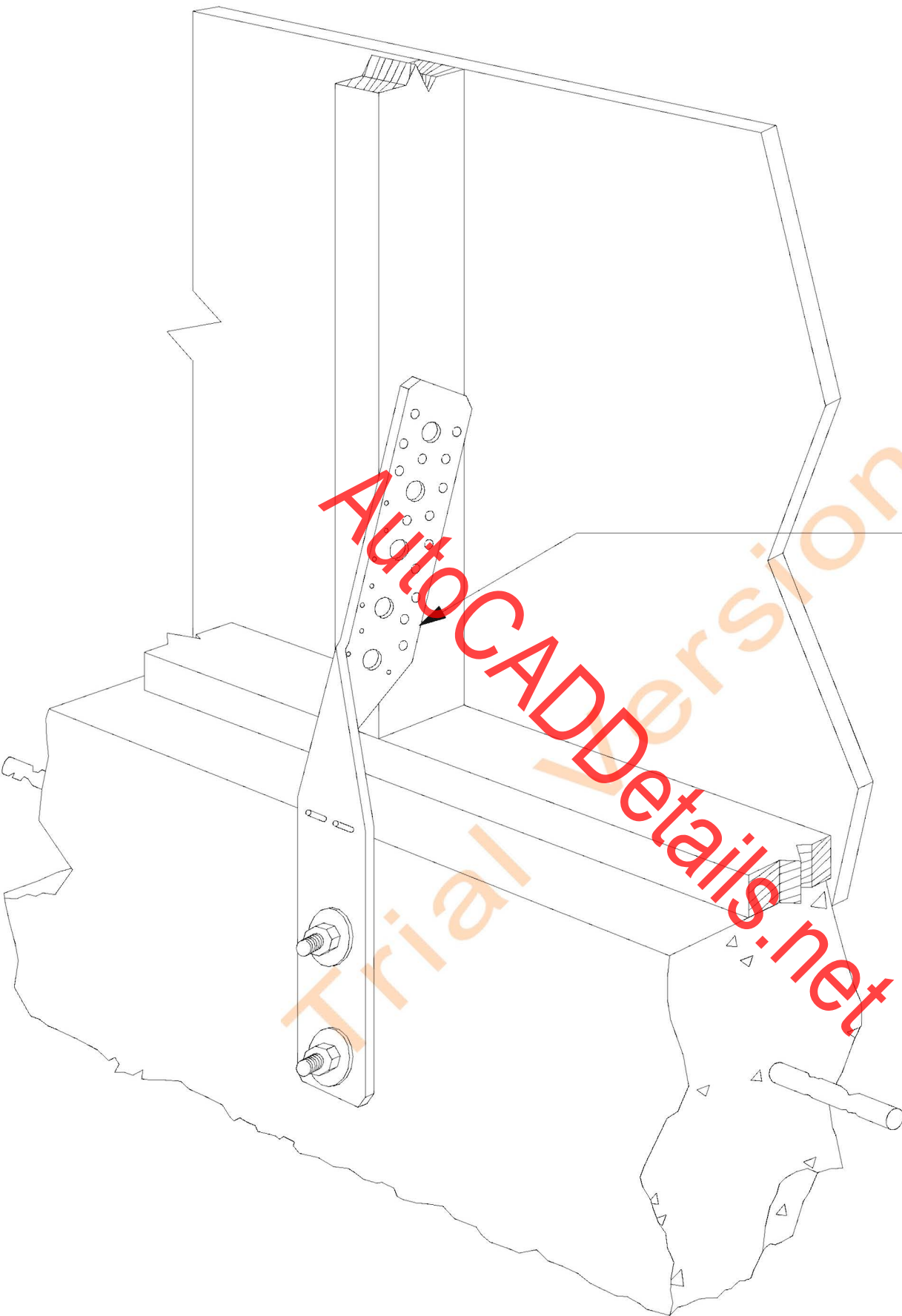

Fasteners

2--1/2" Anchor Bolts

8--10d x 1 1/2" Nails

2--1/2" MB

**Typ. FSA Installation
Foundation to stud**

NOTE:

Use Simpson catalog for correct fasteners and allowable loads to meet your code requirements.

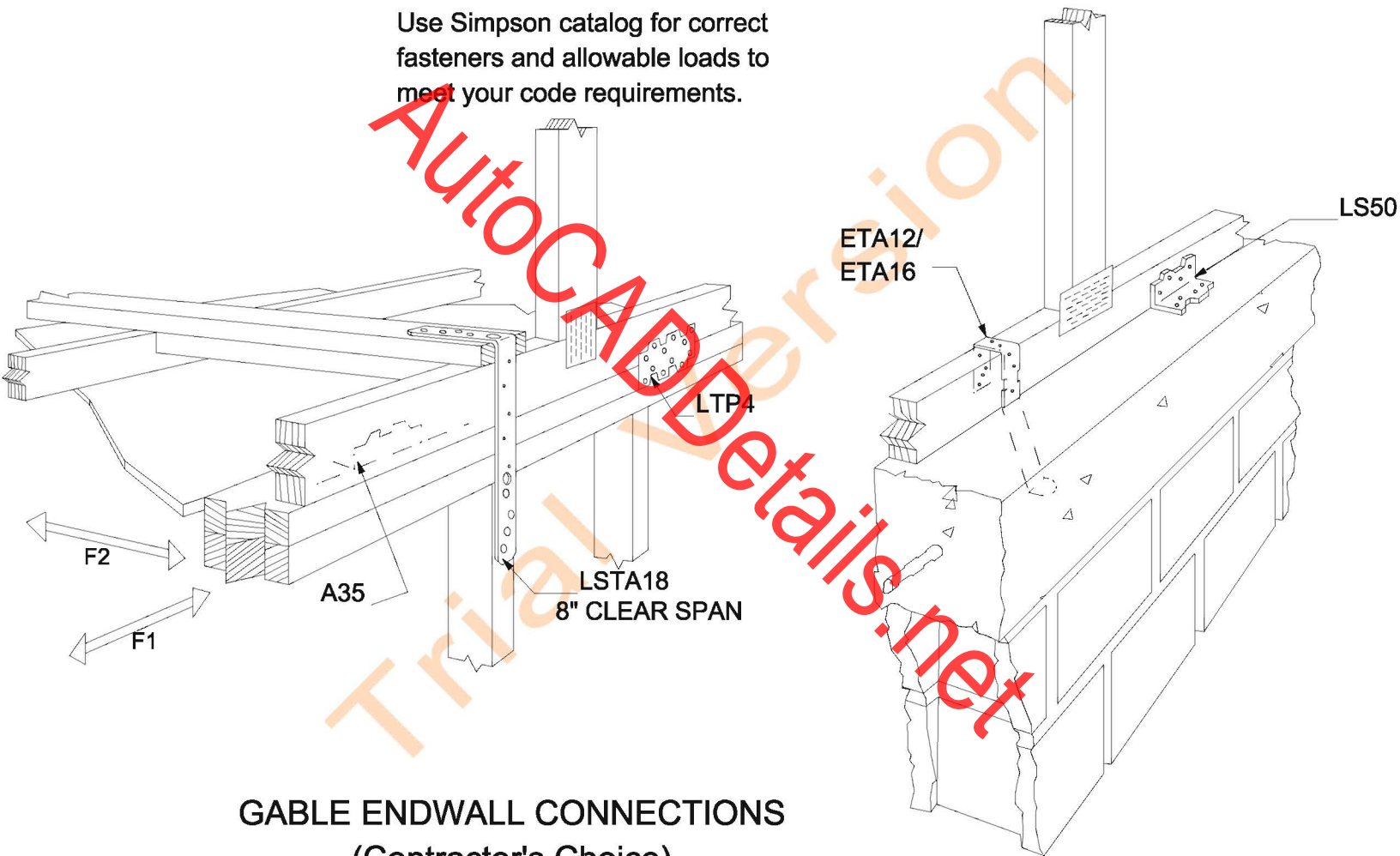

GABLE ENDWALL CONNECTIONS
(Contractor's Choice)

NOTE:

Spalling may occur if the anchor is bent horizontally 90 deg. before installation, and then bent up vertically to attach to the stud. Load reduction may apply.

Fasteners:

Nails: 9-16d Min Stem Width 6"
11-16d Min Stem Width 8"

Corner distance
from edge of
strap to corner
1/2" min.

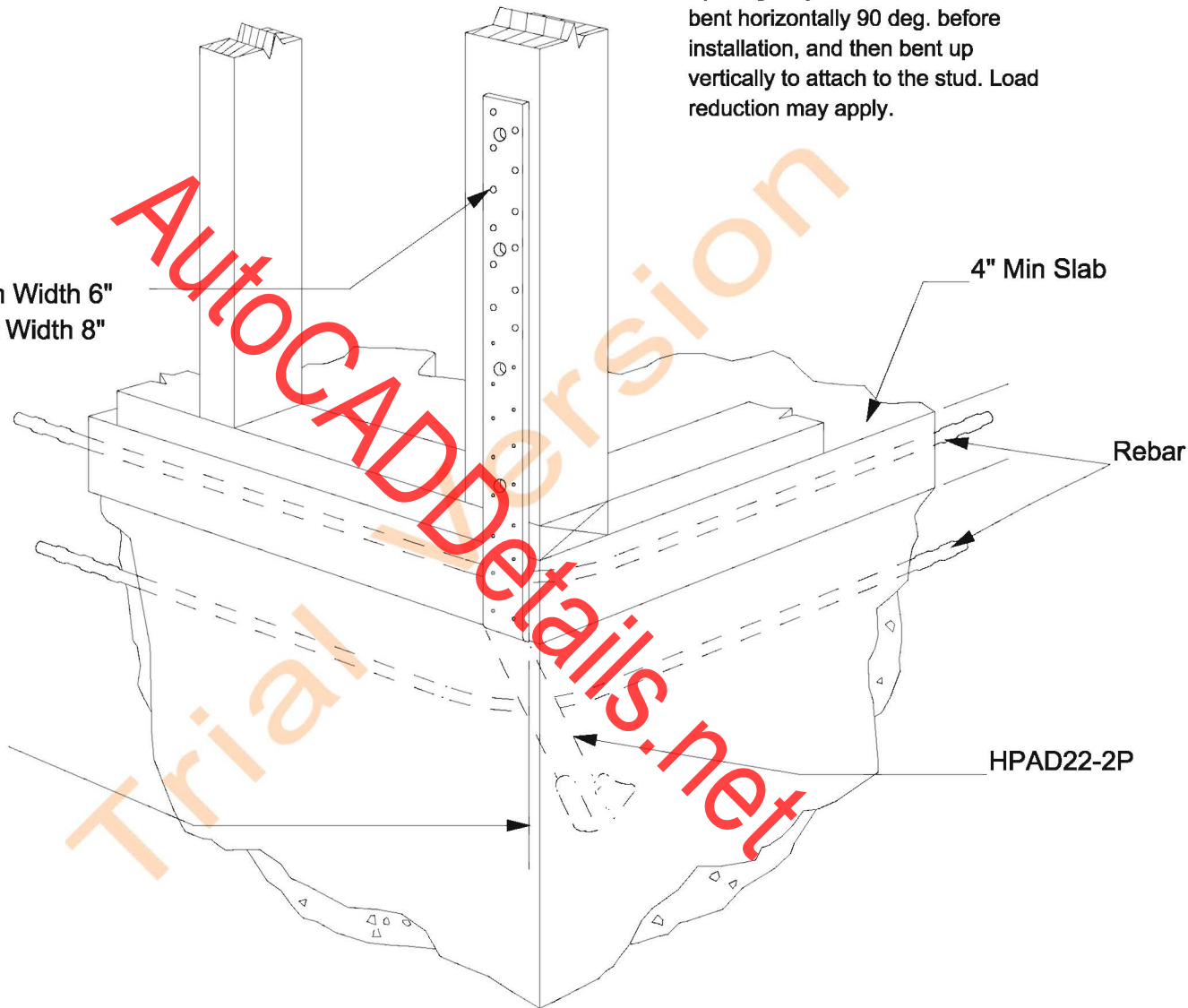

**Typ. Double Pour Corner Holdown Installation
HPAHD**

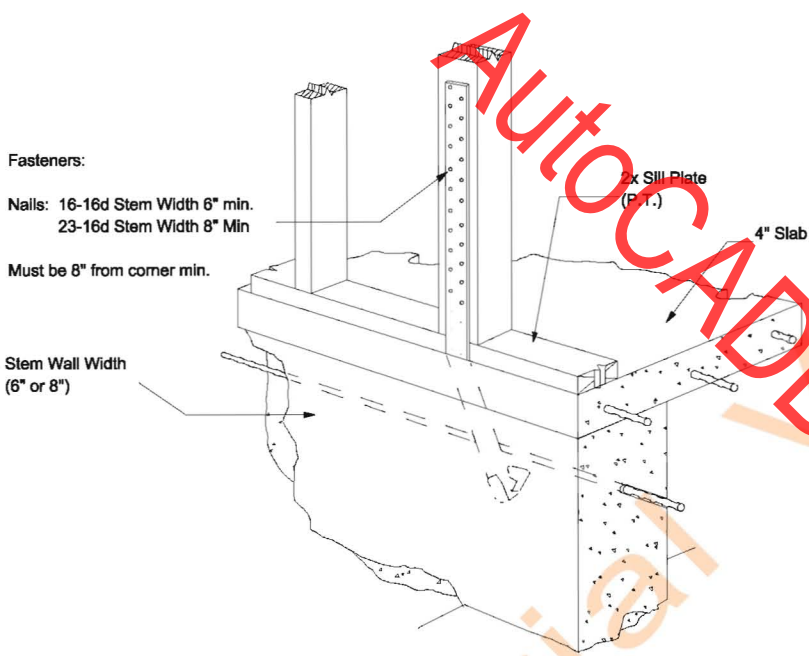

Typ. Double Pour Edge Holdown Installation
 HPAHD22

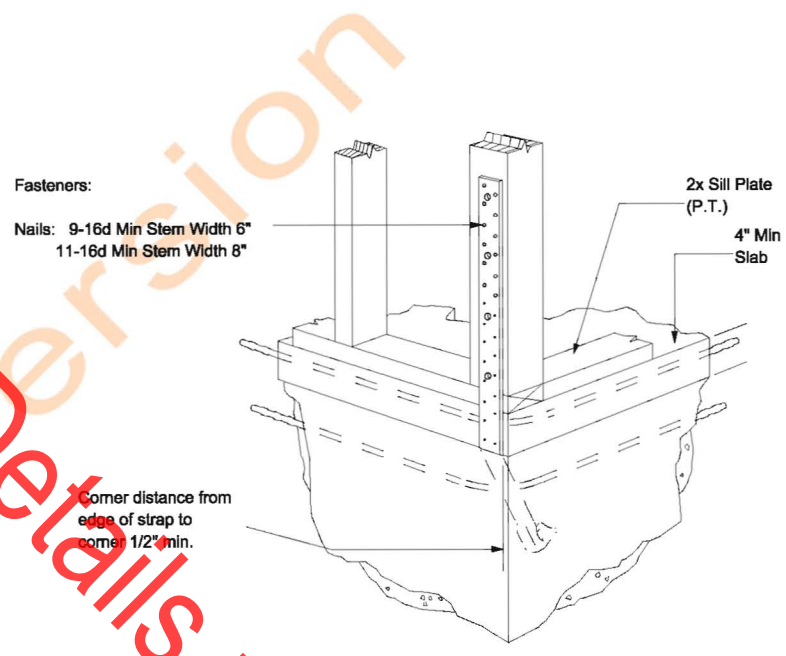

Typ. Double Pour Corner Holdown Installation
 HPAHD

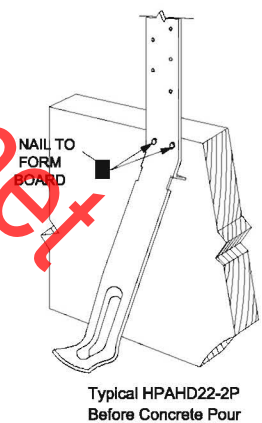
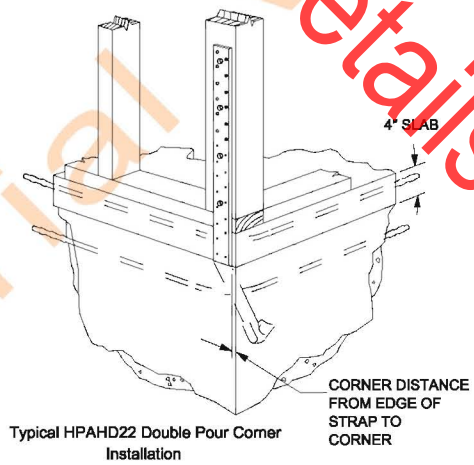
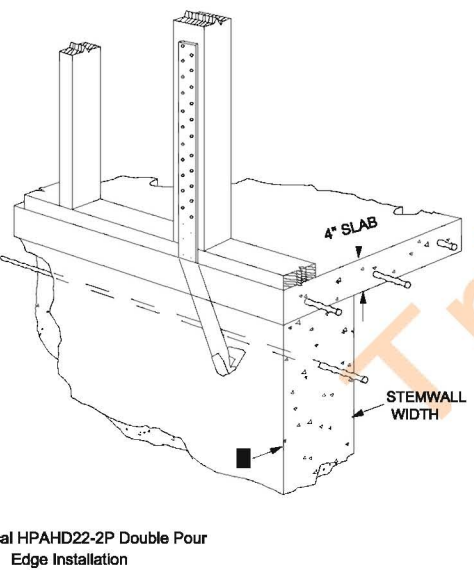
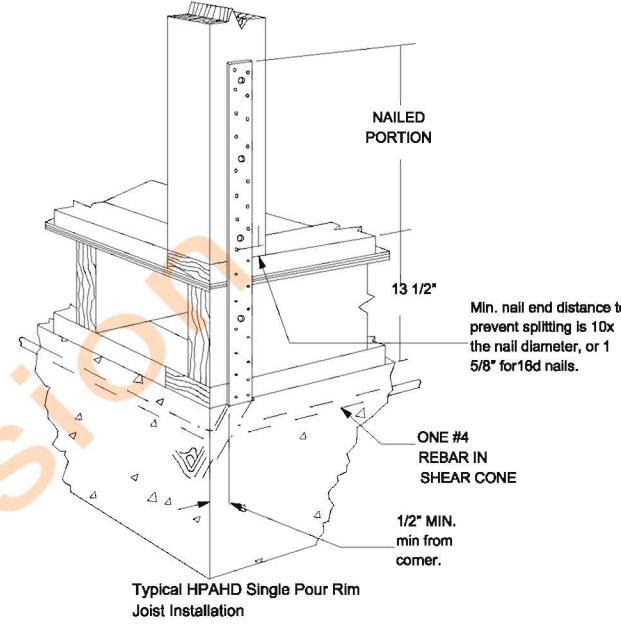
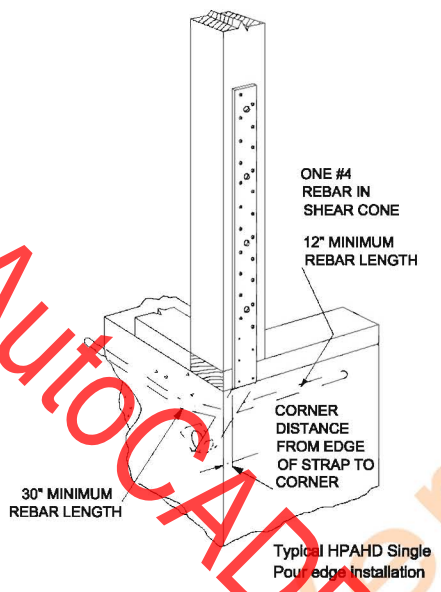
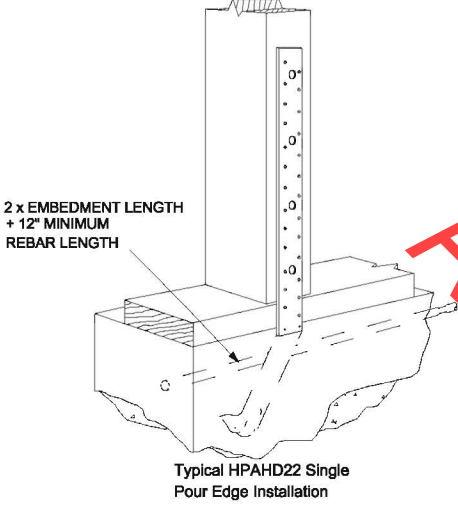

WOOD TO CONCRETE HOLDOWNS
HPAHD SERIES--(Contractor's Choice)

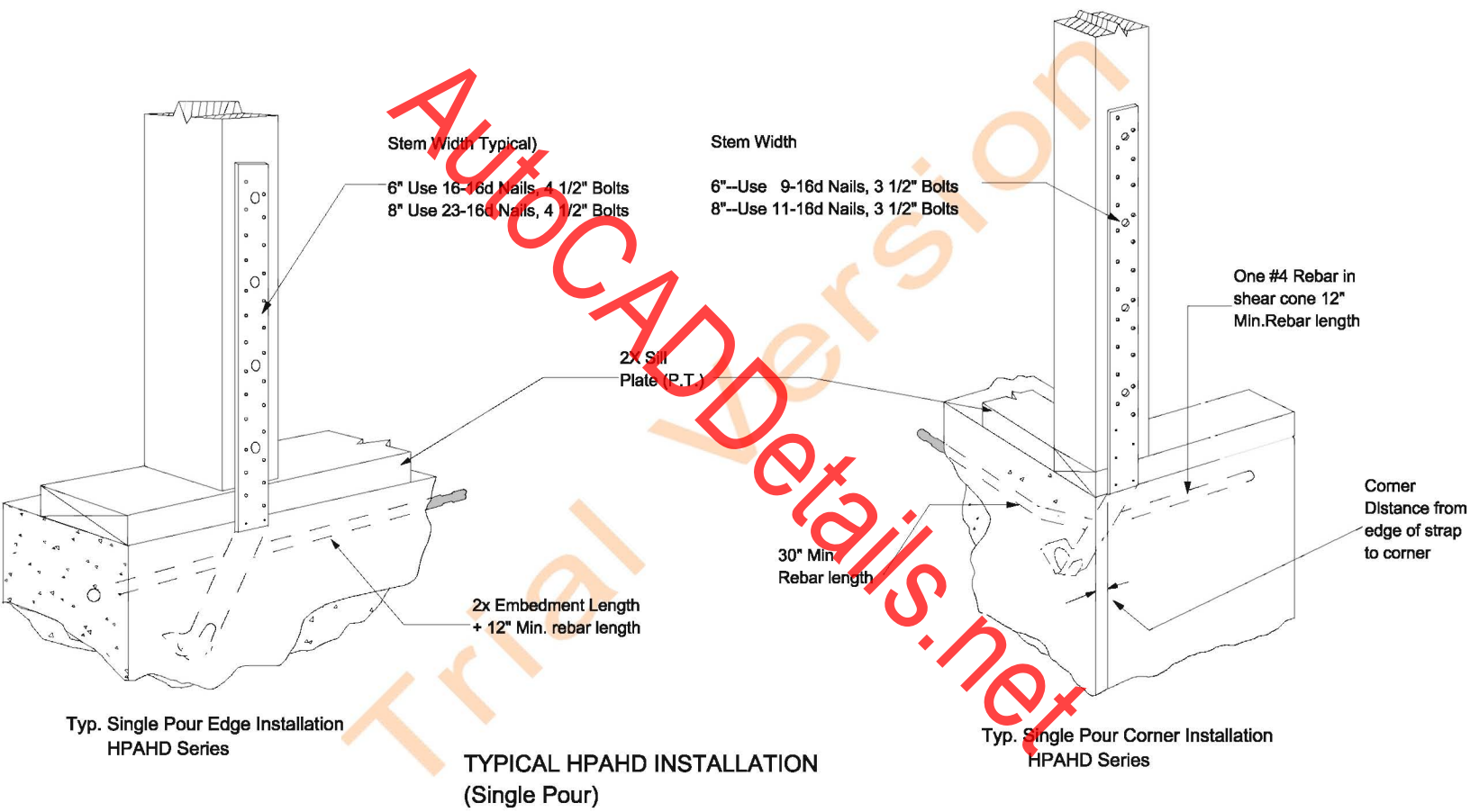

NOTE: Must be embedded 4" onto the slab and 6" into the stem wall beneath for a max. load of 2810 lbs. @ 8" min. from the closest corner, and 1400 lbs. @ 1/2" from the closet corner.

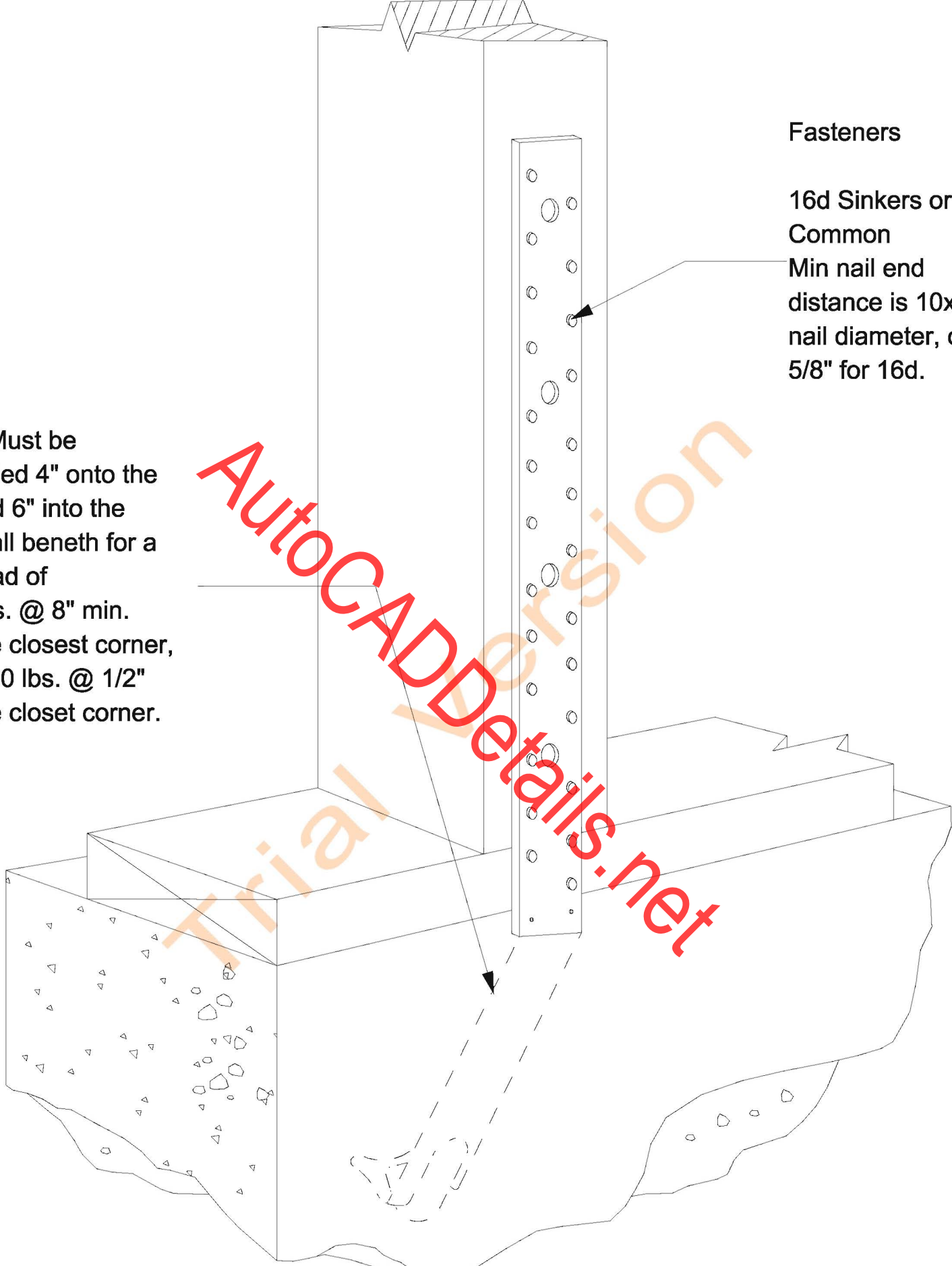

Fasteners

16d Sinkers or 10d Common

Min nail end distance is 10x the nail diameter, or 1 5/8" for 16d.

AutocADD
Trial Version
Details.net

**TYPICAL HOLDOWN
HPAHD22**

Fasteners:

Nails: 7-16d Stem Width 6" min.
9-16d Stem Width 6" min.

Bolts: 3 1/2"

Nails: 10-16d Stem Width 8" min.
11-16d Stem Width 8" min.

Bolts: 3 1/2"

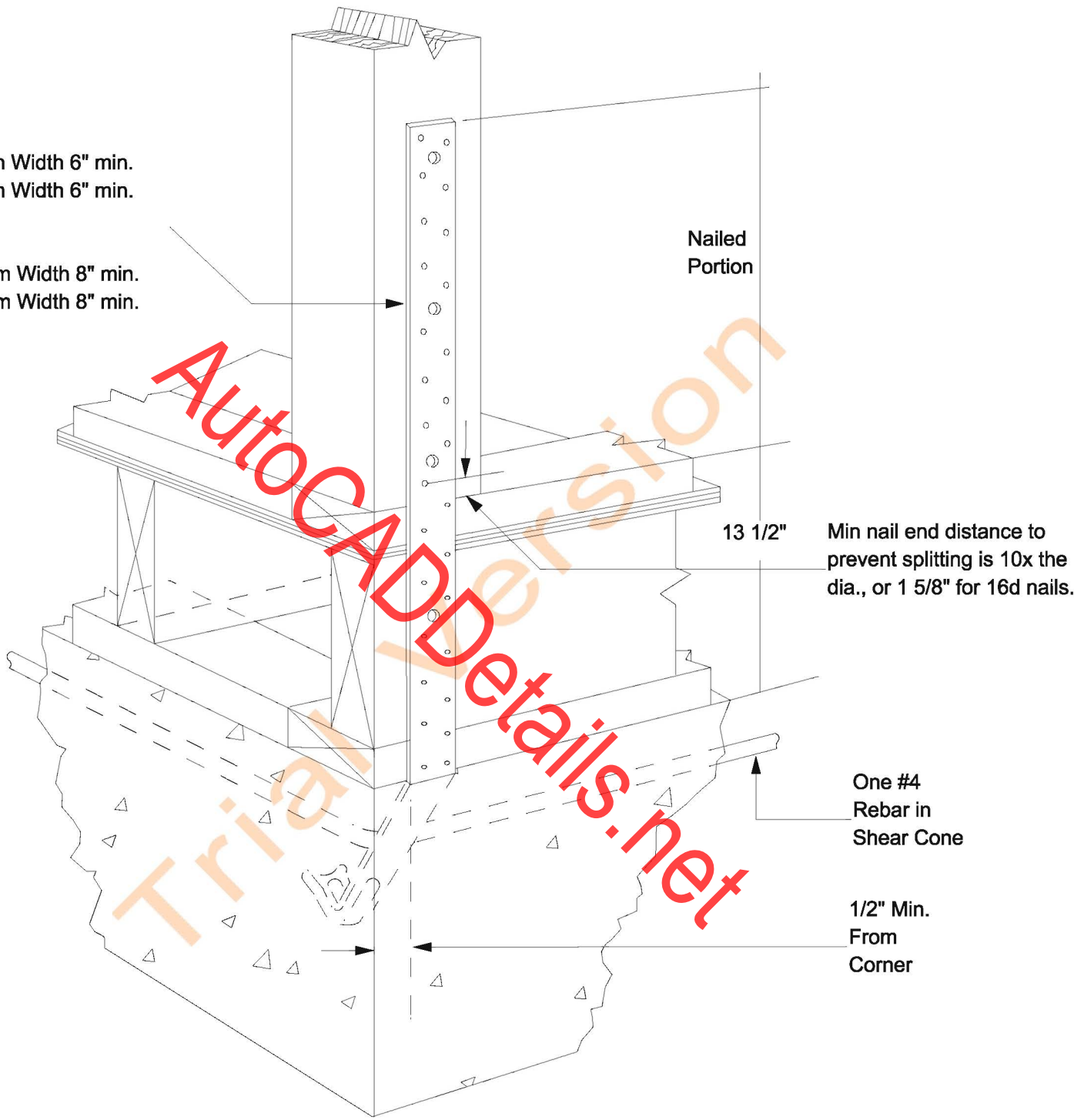

**Typ. Single Pour Rim Joist Installation
HPAHD Series Holddown**

NAIL TO
FORM
BOARD

Trial Version
AutocADDetails.net

6 1/2"

5 1/2"

Simpson Strong-Tie
HPAHD22-2P

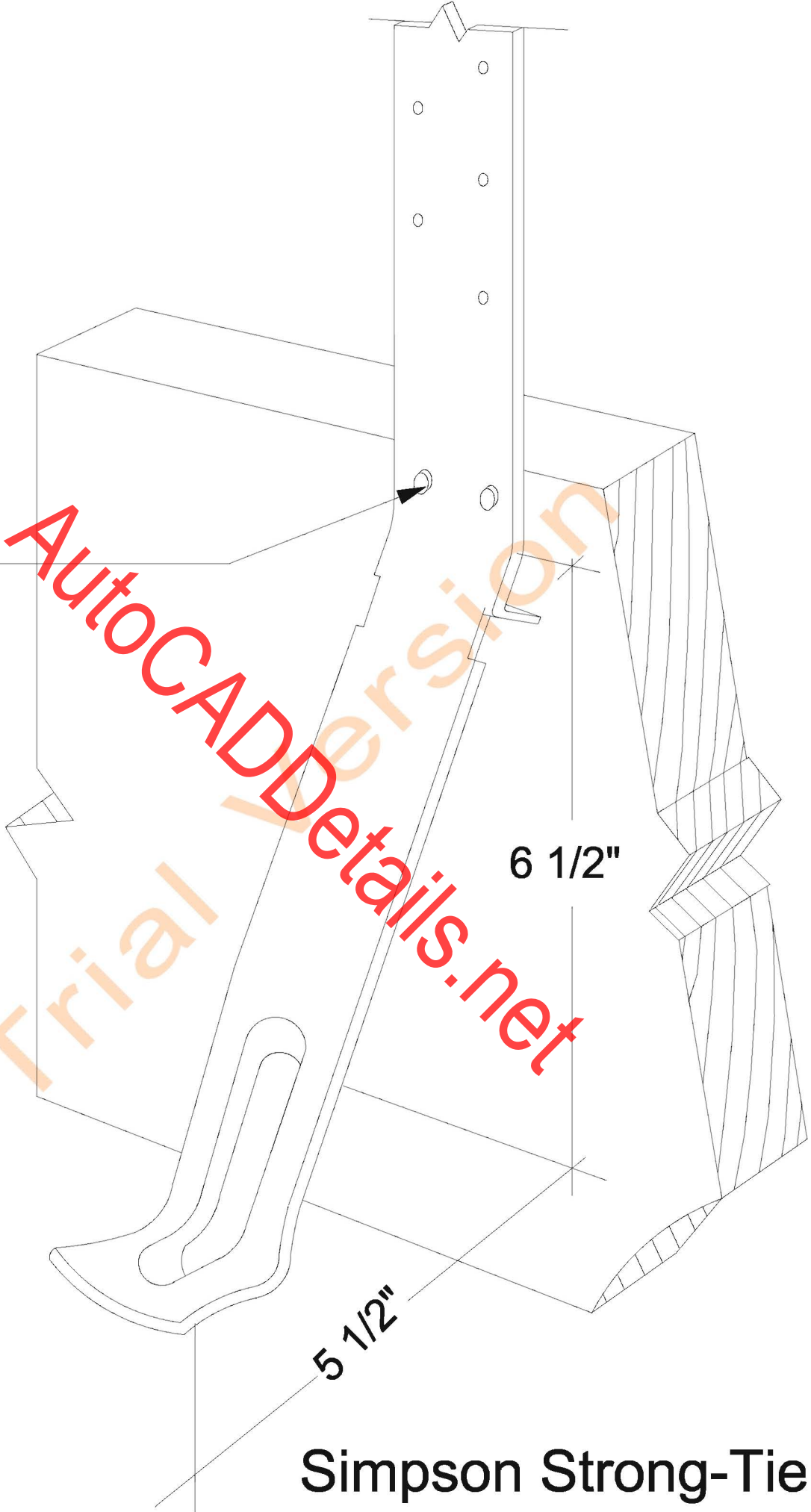

Note: HTT22 can have a MAX. offset of 2" from the stud face to the centerline of the anchor bolt.

Use the specified number and type of nails to attach the strap portion to the bottom or side of purlin or beam. Bolt the base to the wall or foundation with suitable anchor.

32-16d Sinkers (16d sinkers or 10d common may be substituted for the specified 16d.

Anchor Bolt ---5/8"

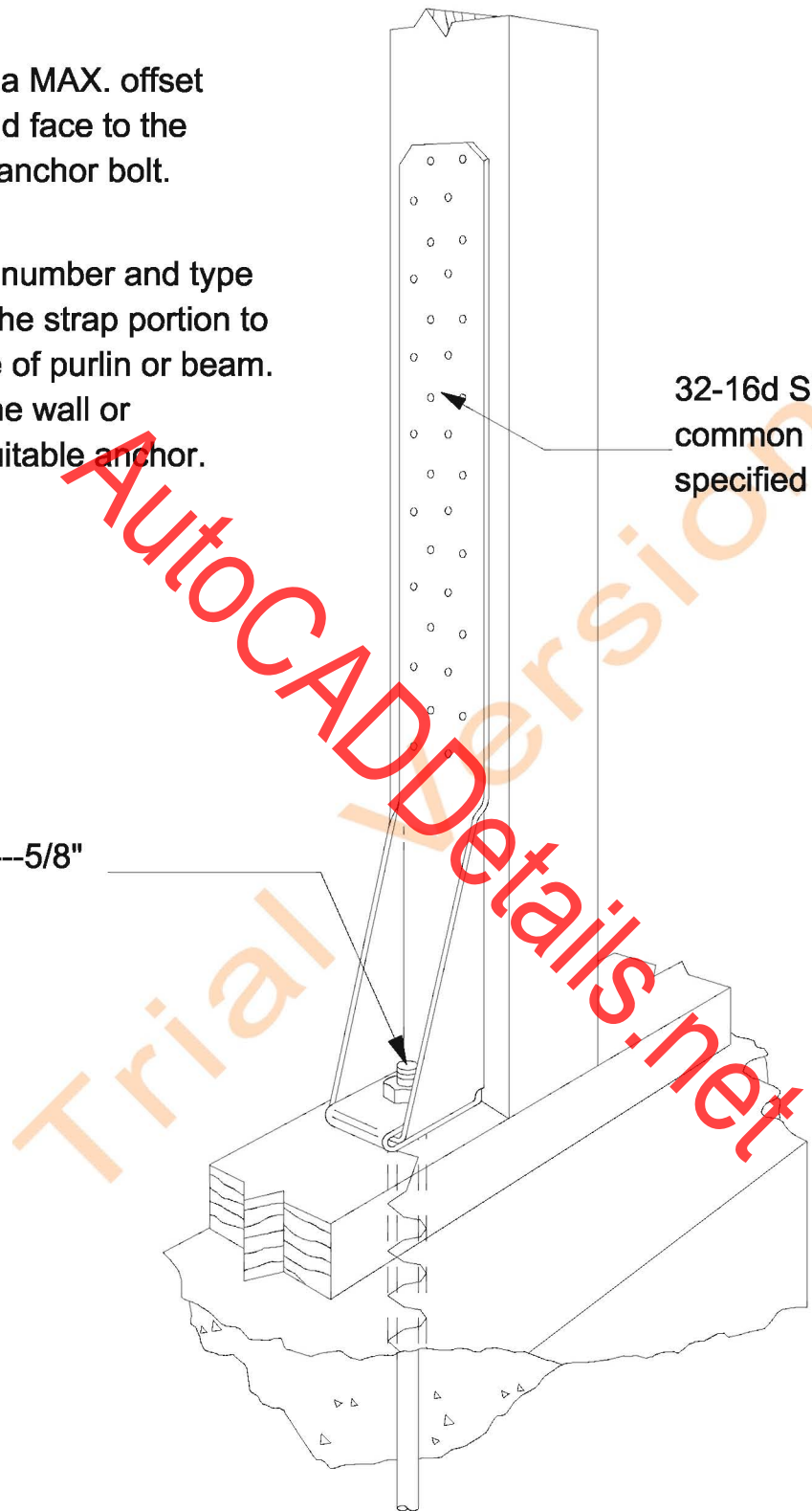

Typical HTT22 as a Holddown by Simpson

NOTE: See Simpson catalog for proper fasteners and allowable loads to meet your code requirements.

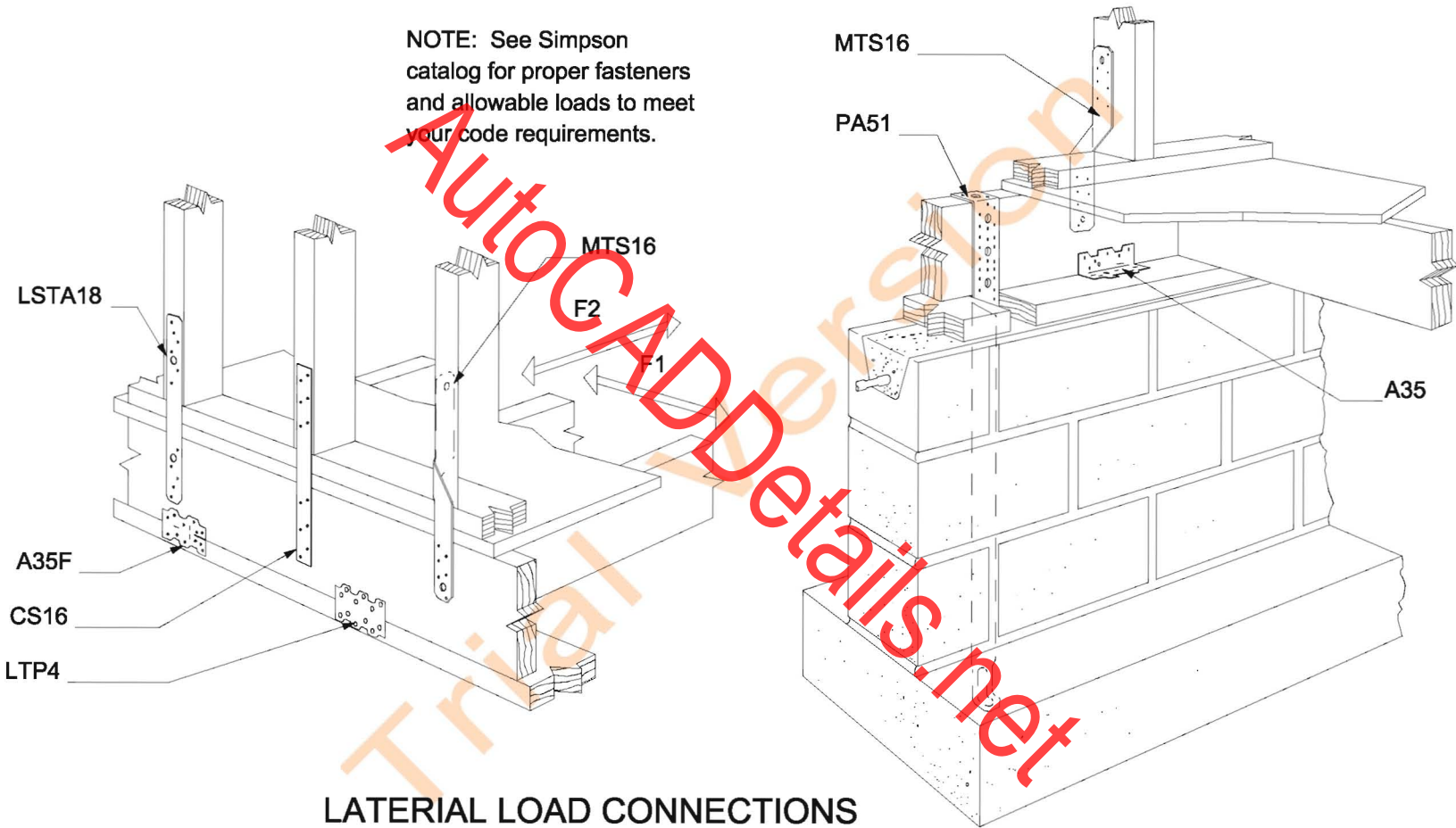

LATERAL LOAD CONNECTIONS
(Contractor's Choice)

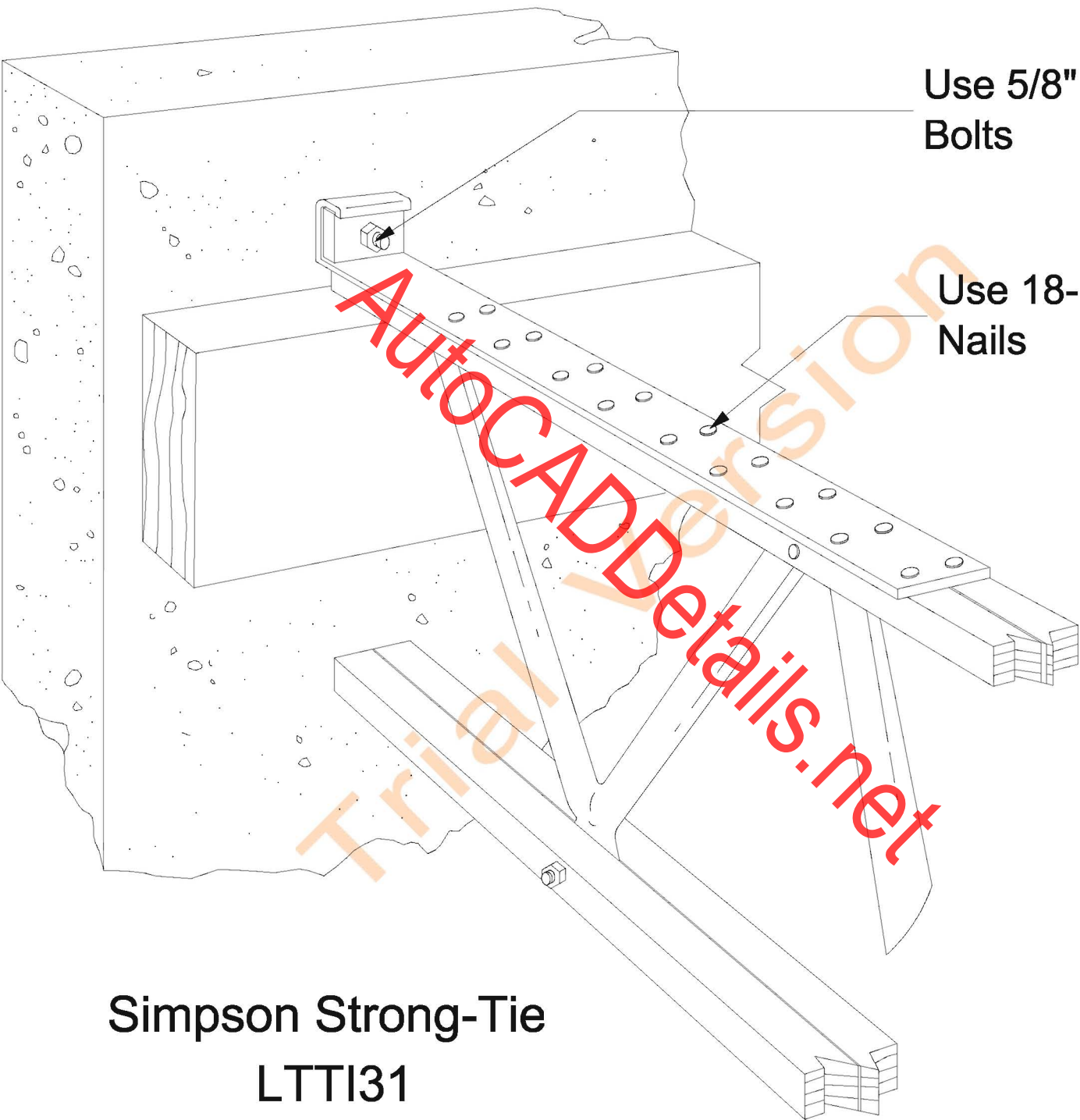

Use 5/8" Anchor Bolts

Use 18-10dx1 1/2" Nails

Simpson Strong-Tie
LTTI31

LTT19 Use 3/4" Anchor Bolts, 8-16d Sinkers.
LTT20B Use 1/2", 5/8", 3/4" Anchor Bolts, 10-16d Nails.

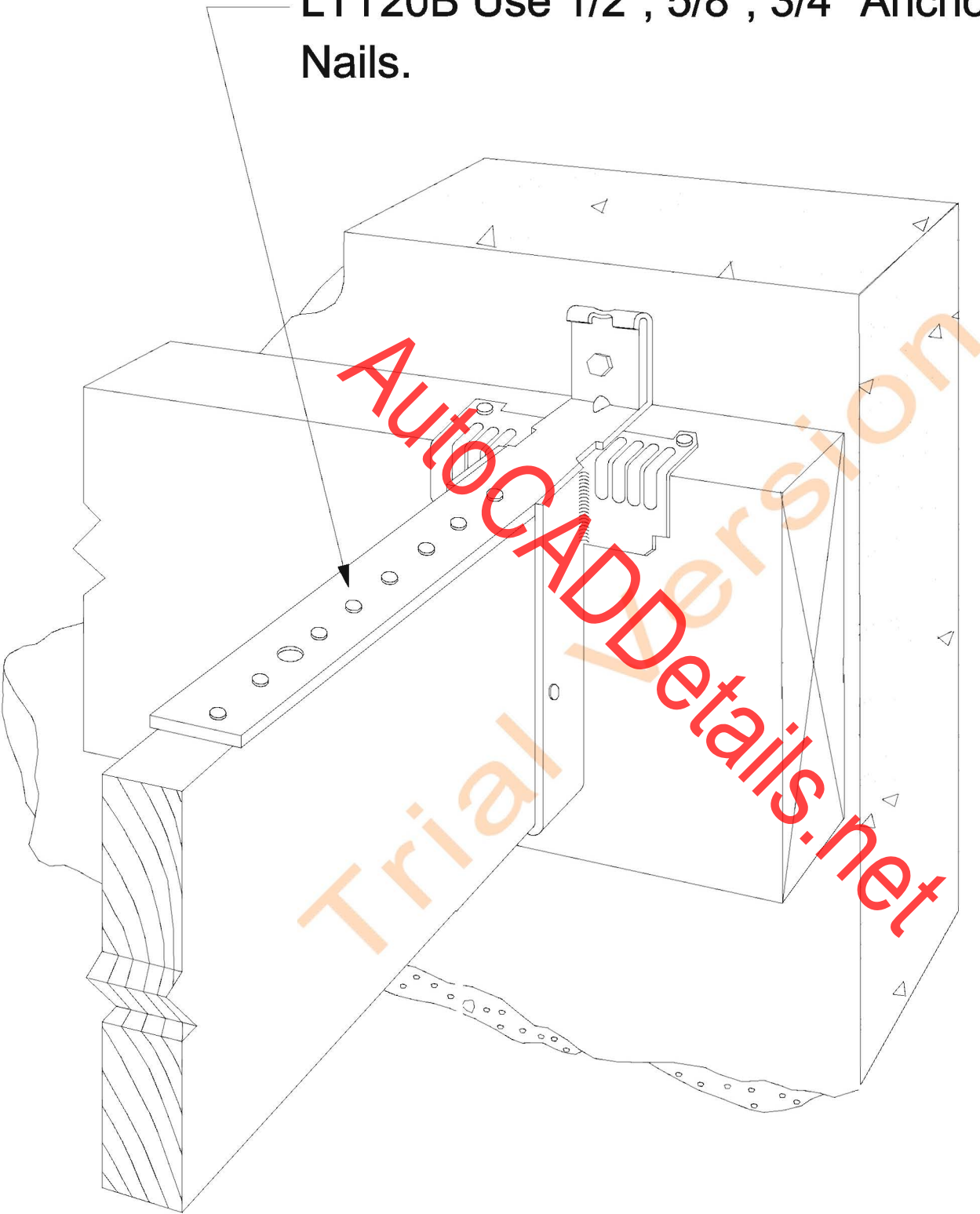

LTT19 Installation (LTT20B similar)
Simpson Strong-Tie

FOR INSTALLATION EASE,
NAIL ONE DUPLEX NAIL INTO
SIDE FORM BOARD

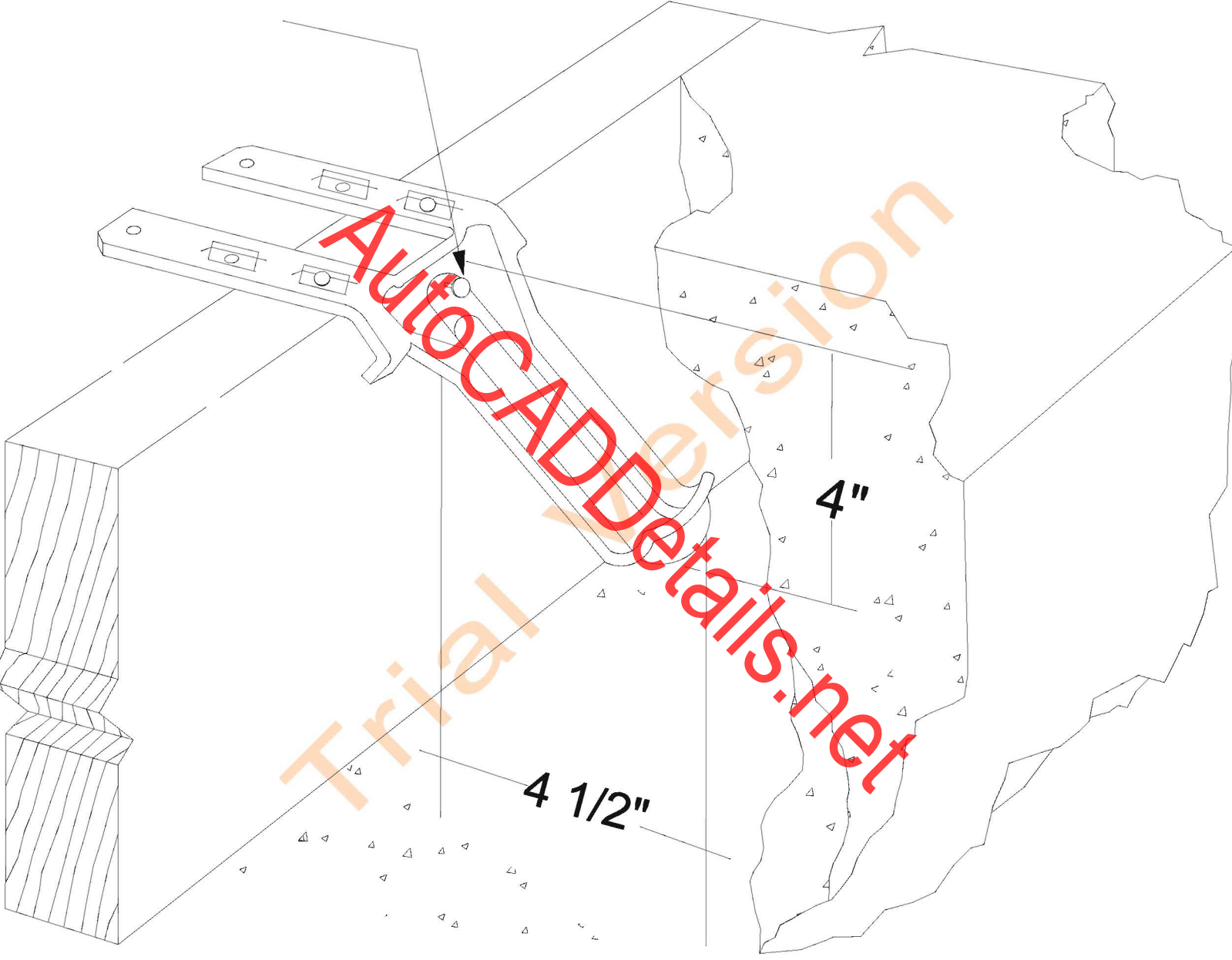

Mudsill Anchor Singleside
Installation Cut-away
(Typical)MAS

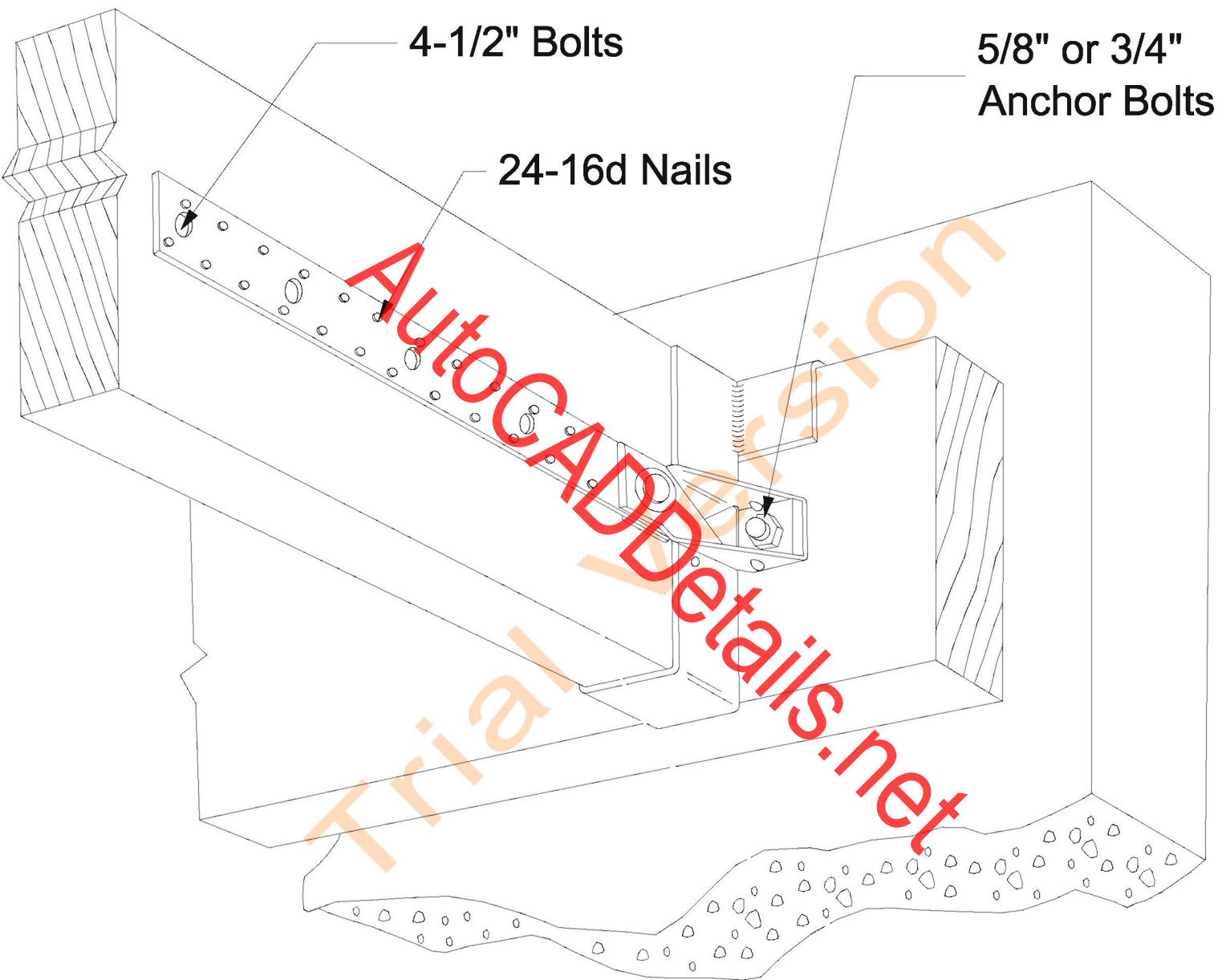

MTT28B
Simpson Strong-Tie

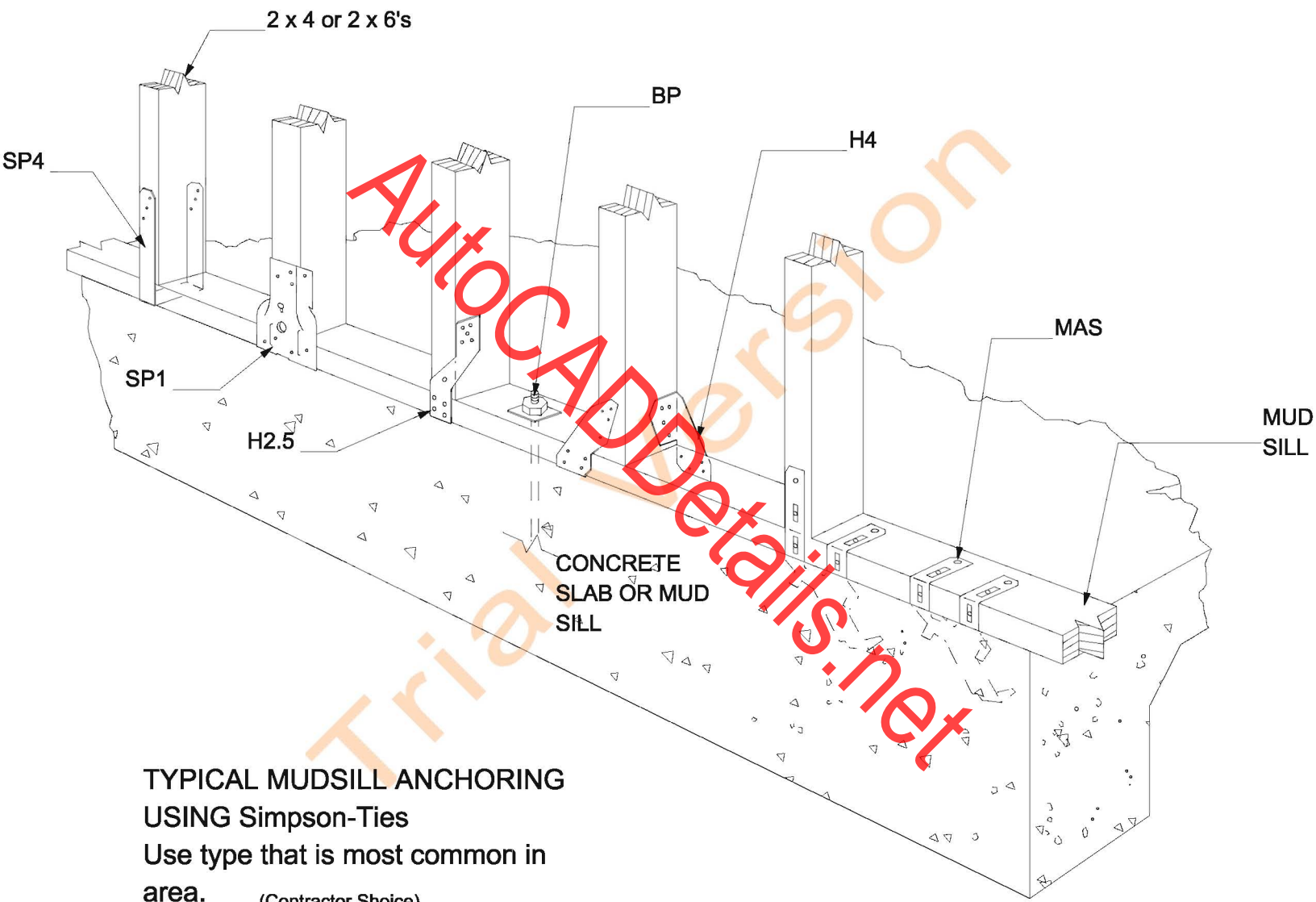

**TYPICAL MUDSILL ANCHORING
 USING Simpson-Ties**
 Use type that is most common in
 area. (Contractor Shoice)

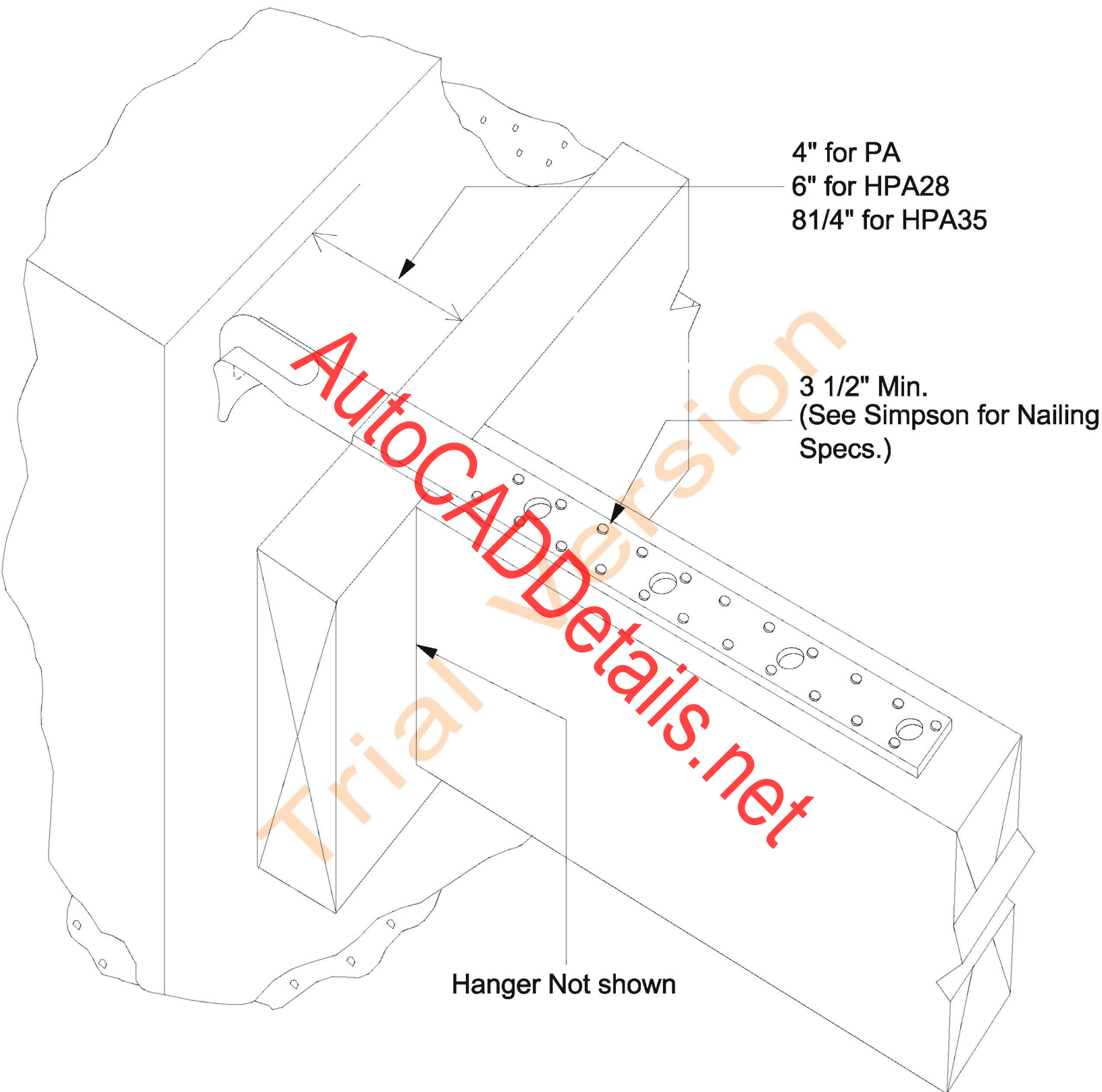

4" for PA
6" for HPA28
8 1/4" for HPA35

3 1/2" Min.
(See Simpson for Nailing
Specs.)

Hanger Not shown

PA OR HPA Purlin To Concrete Wall
Simpson Strong-Tie

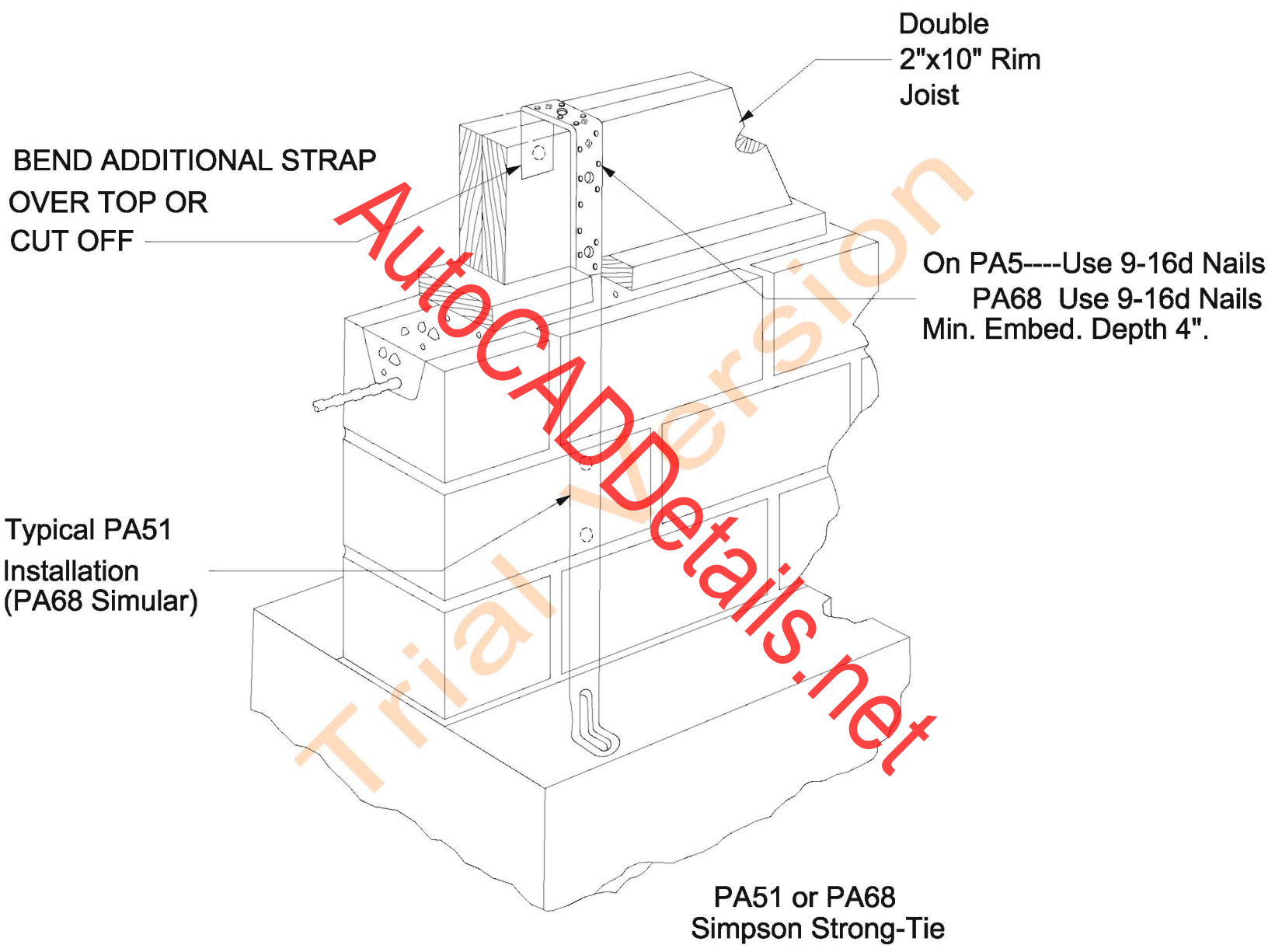

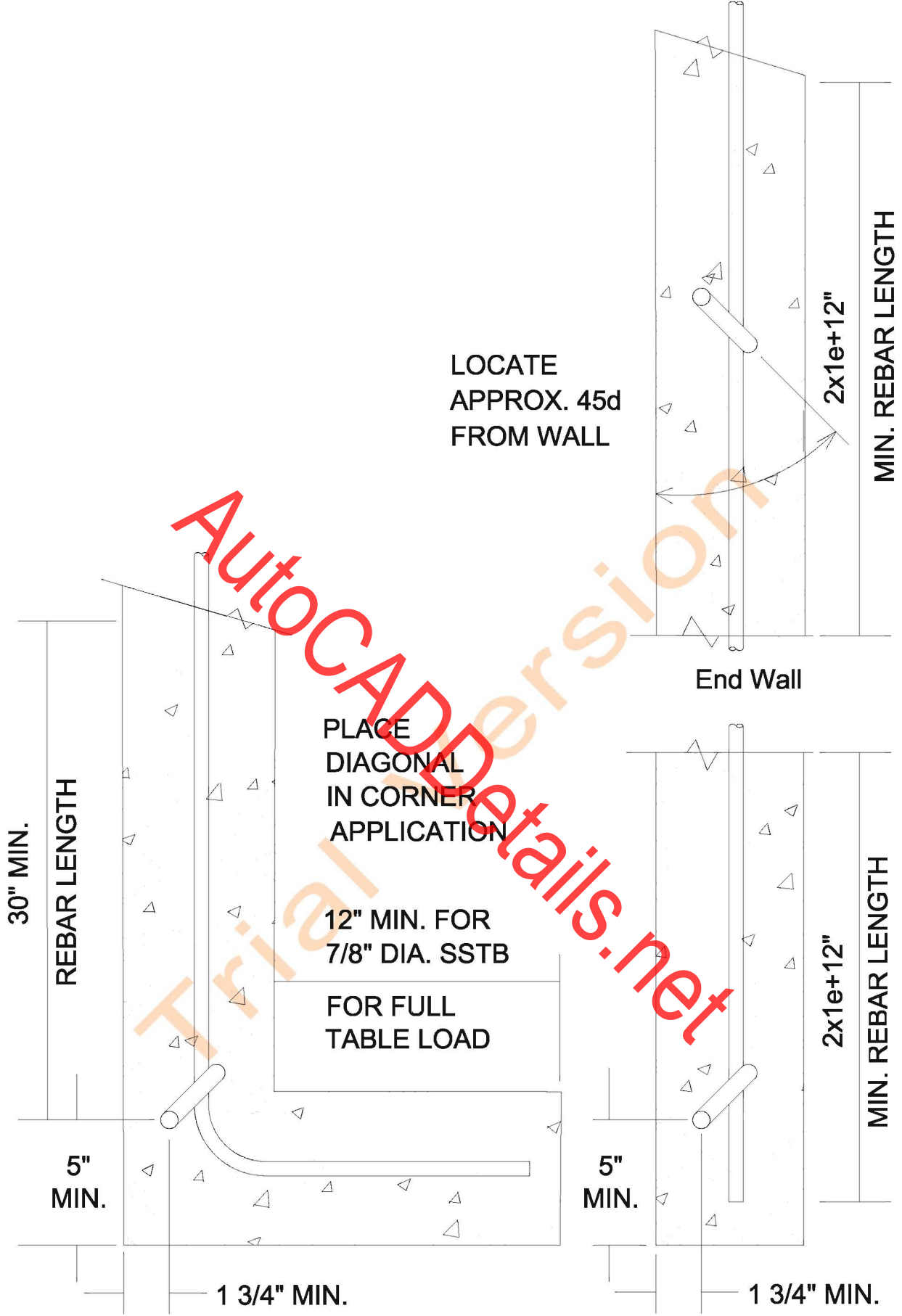

Corner Installation

Continuous Stemwall

Typical Plan Views
of Rebar installation
(SSTB)

2" MINIMUM
SIDECOVER

Use 12-16d
Nails

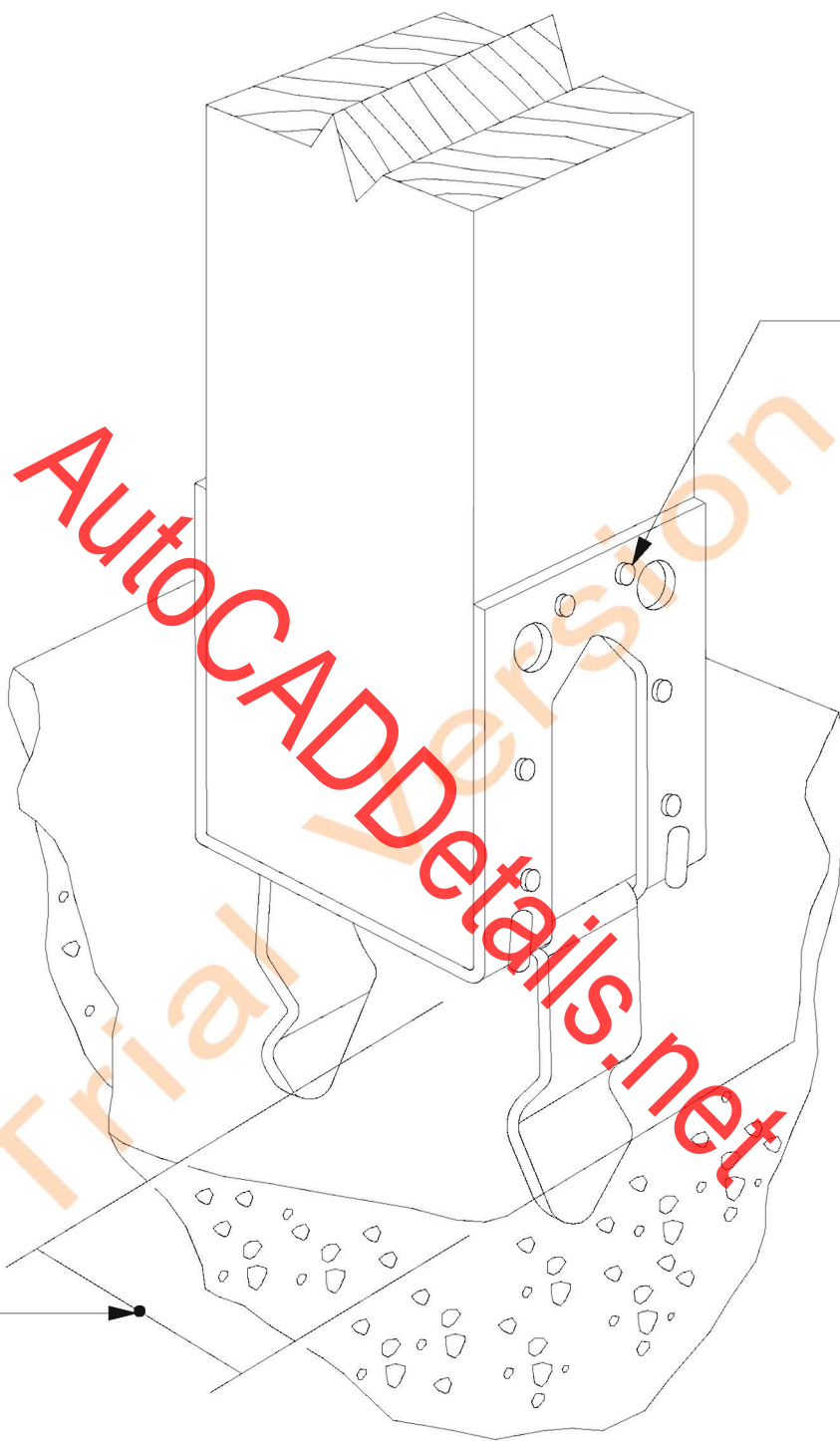

Typical PB Installation

Use 8-16d Nails

Allow 1" to 2 1/2" clearance
above concrete. 2" for
EPB44A. Insert EPB into
concrete after screeding.

Trial Version
AutocADDetails.net

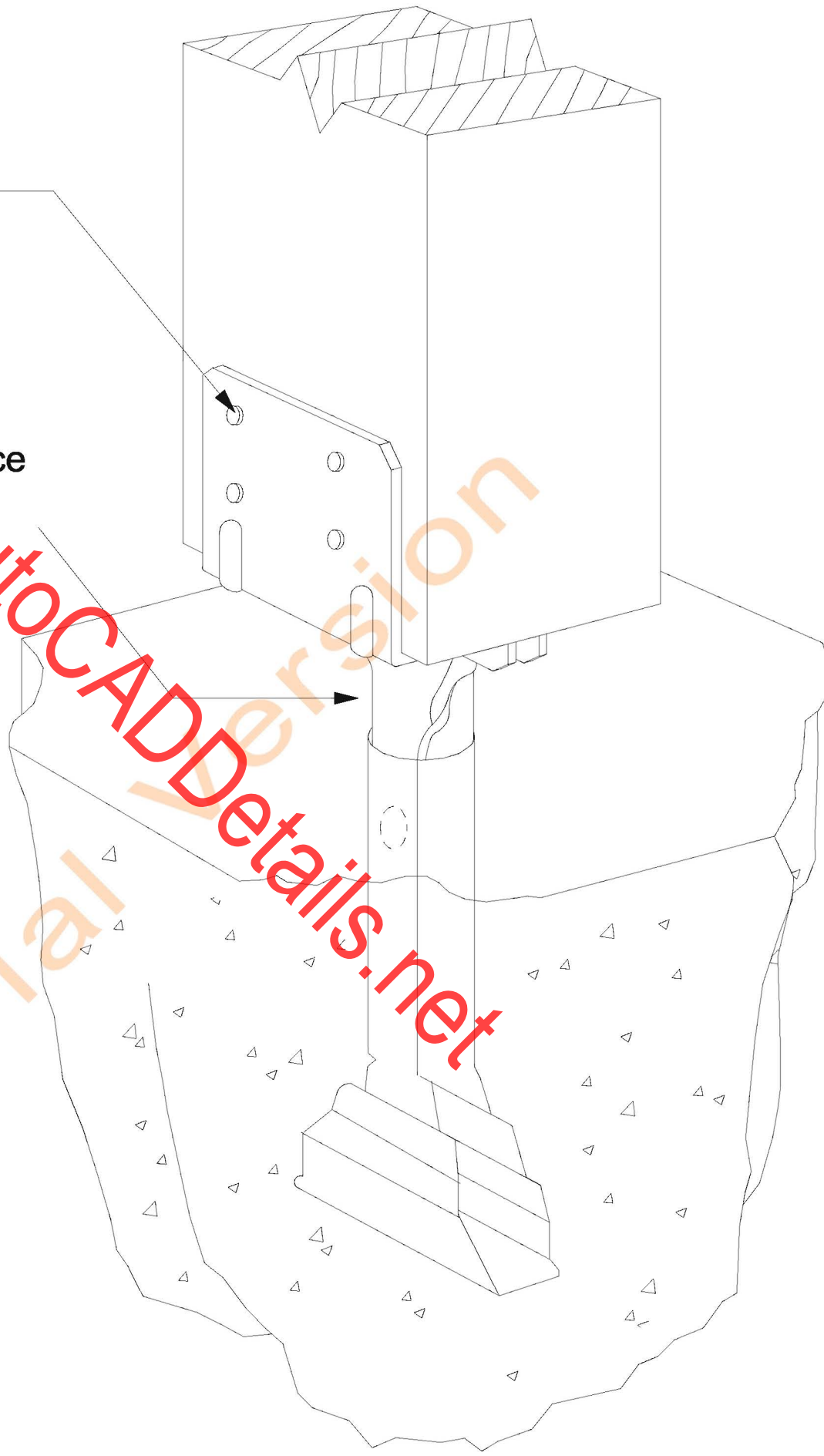

Typical EPB44A Installation

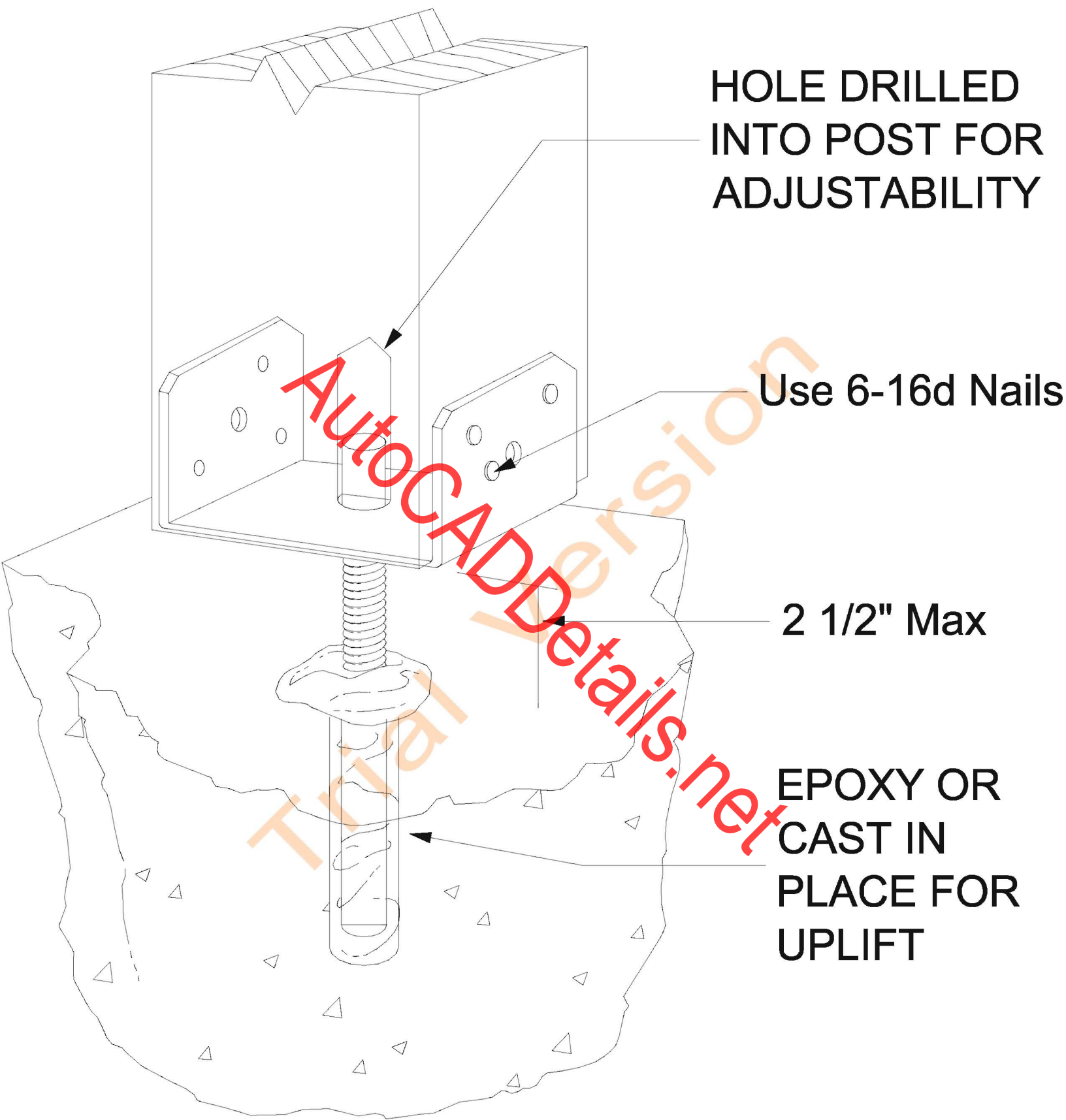

Typical EPB44T Installation with Epoxy

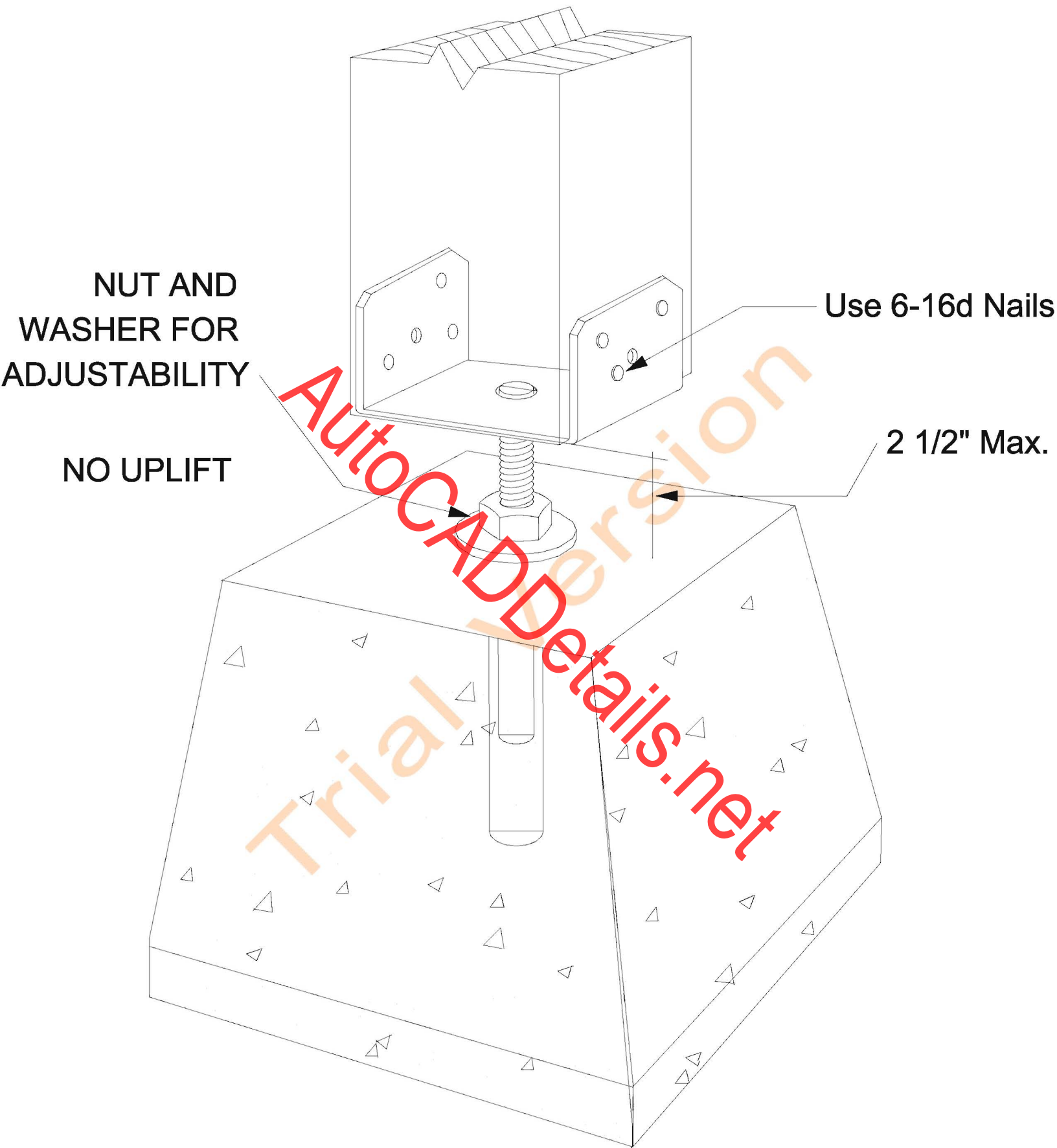

Typical EPB44T Installation w/nut & washer

2 x embedment
length + 12" min
rebar length

Stem Width Typical)

6" Use 16-16d Nails, 4 1/2" Bolts
8" Use 23-16d Nails, 4 1/2" Bolts

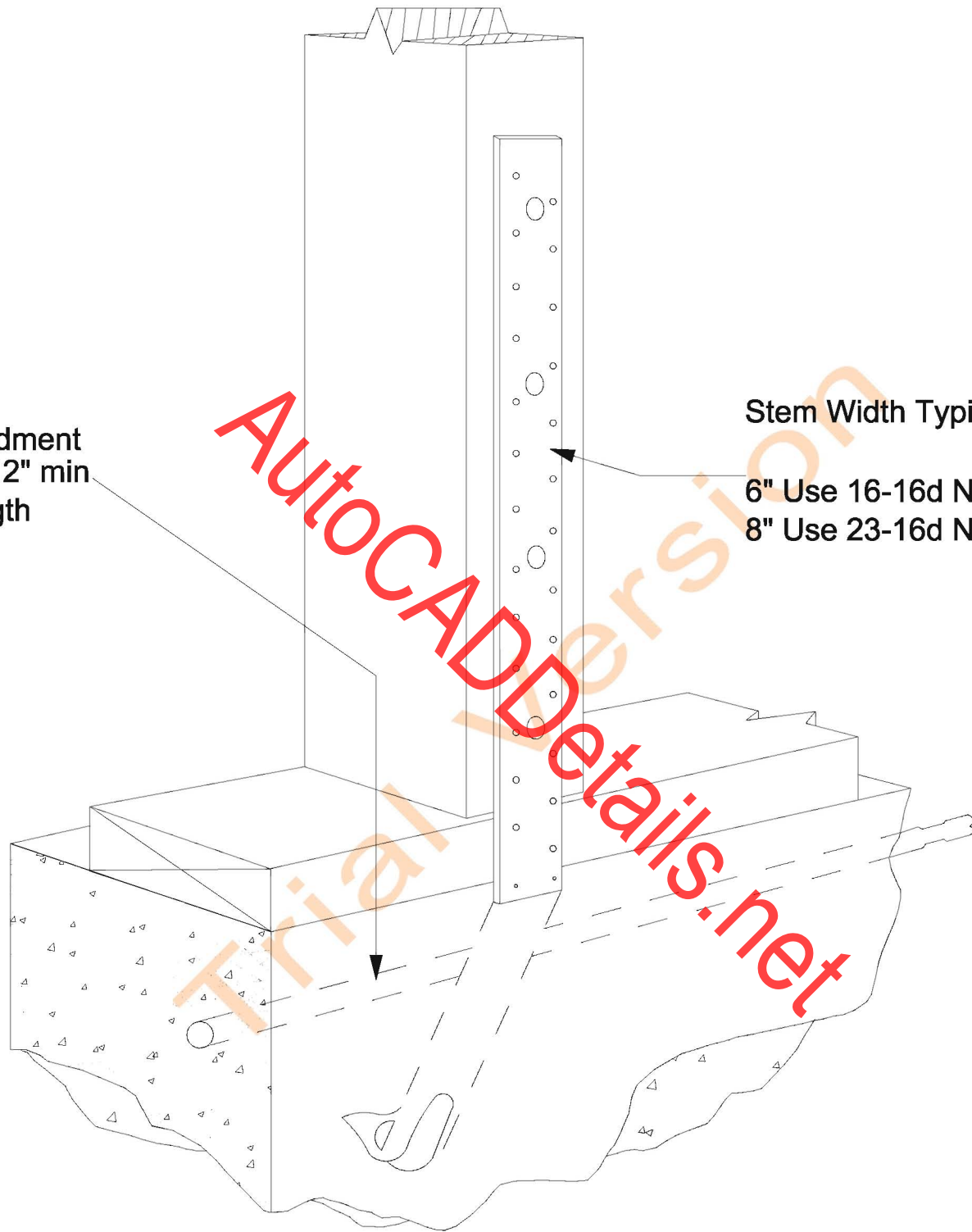

Typ. Single Pour Edge Installation
HPAHD Series

Stem Width

6"--Use 9-16d Nails, 3 1/2" Bolts
8"--Use 11-16d Nails, 3 1/2" Bolts

One #4 Rebar in shear
cone 12" Min. Rebar
length

30" Min Rebar
length

Corner Distance
from edge of strap
to corner

Typ. Single Pour Corner Installation
HPAHD Series

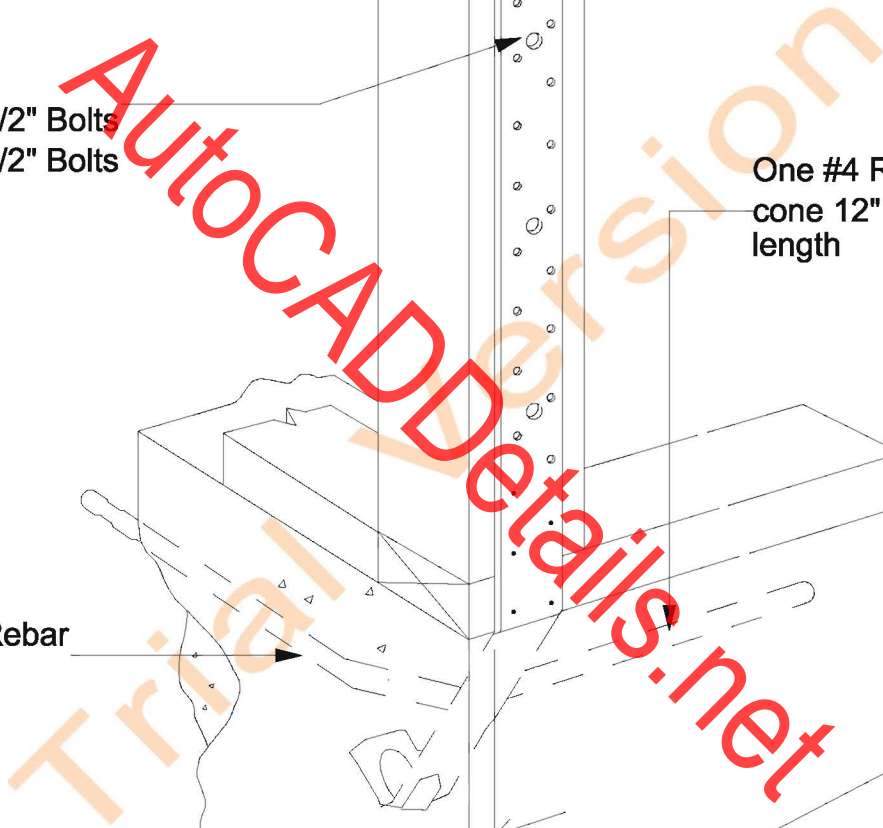

Stem Wall
Thickness
6" Min. 8" For 7/8"
SSTB

1 3/4" Min.
Edge Distance

4"

See Simpson
MFG For
proper length

AutocADDetails.net

SSTB(Typical)
Installation

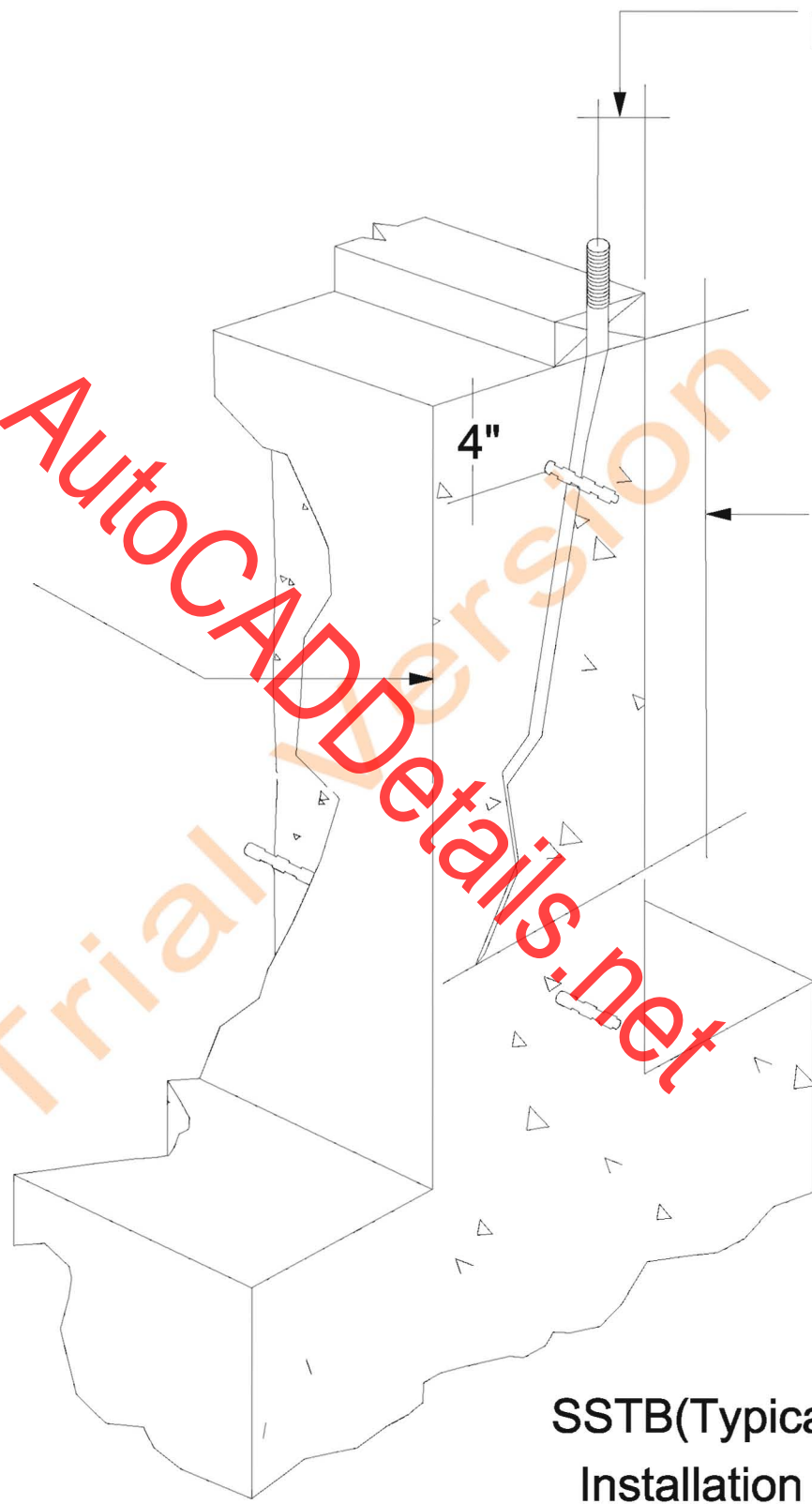

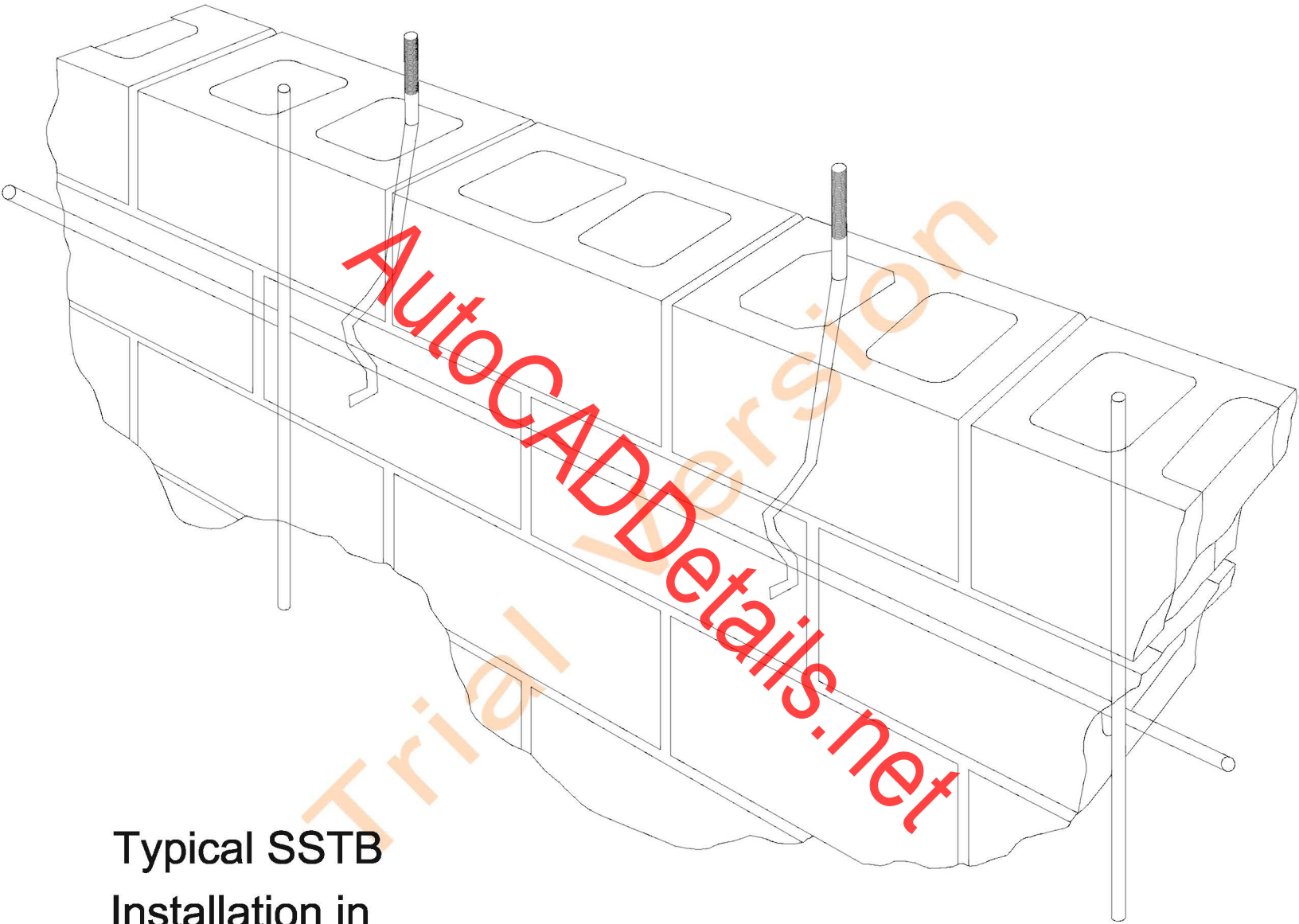

Typical SSTB
Installation in
Grouted Concrete
Block